

THIS DRAWING IS UNPUBLISHED. RELEASED FOR PUBLICATION 2010
 © COPYRIGHT 2009 BY TYCO ELECTRONICS CORPORATION. ALL RIGHTS RESERVED.

LOC	DIST	REVISIONS					
		P	LTR	DESCRIPTION	DATE	DWN	APVD
IK	2	A		ISSUED	07MAY2009	ACG	JS
		AI		PART RELEASED.	12NOV2009	ACG	JS
		B		ECR-10-015402 (NEW SPACER)	04AUG2010	ACG	AP

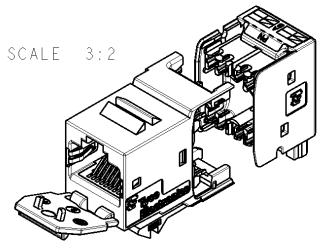

SCALE 3:2



COLOR CODING / LABELING

- MATERIAL:
 - FRONT AND REAR HOUSING, CABLE CLAMP: ZAMAK 5. (Z410).
 - IDC CONNECT BLOCK, DUST COVER AND LACING FIXTURE: POLYCARBONATE.
 - OTHER PLASTIC PARTS: HIGH TEMPERATURE PLASTIC.
 - CUTTING BLADE, SPRINGS AND SHIELD CONTACT POINT: STAINLESS STEEL.
 - JACK CONTACTS: BERYLLIUM COPPER, PLATED WITH 1.27 um MINIMUM THICK GOLD IN LOCALIZED AREA AND 3.81 um MINIMUM THICK MATTE TIN IN SOLDER AREA OVER 1.27 um MINIMUM THICK NICKEL UNDERPLATE.
 - IDC TERMINALS: PHOSPHOROUS BRONZE, PLATED WITH 3.81 um MINIMUM THICK MATTE TIN OVER 1.27 um MINIMUM THICK NICKEL UNDERPLATE.
- AMP-TWIST 6AS SL JACK WILL TERMINATE:
 - SOLID CONDUCTORS: 22-24 AWG.
 - STRANDED CONDUCTORS: 24 AWG.
 - MAX. INSULATION DIAMETER: \varnothing 1.60 mm.
 - MAX. CABLE JACKET: \varnothing 9.00 mm.
- JACK INTERFACE DIMENSIONS ACCORDING TO IEC 60603-7-5 last Ed.
- MOUNTING PANEL THICKNESS 1.47-1.60 mm. (SEE SUGGESTED CUTOUT).

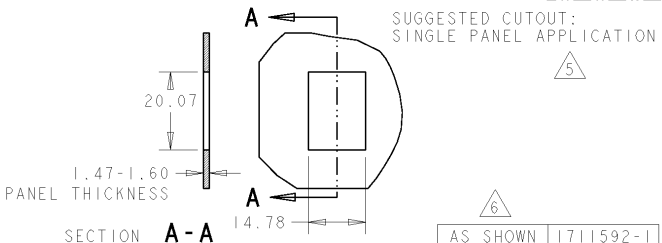
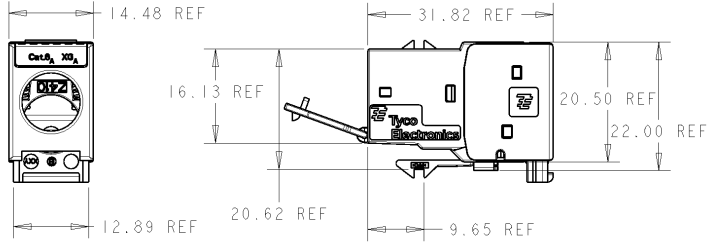
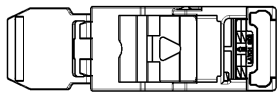

ELECTRICAL SCHEMATIC: WIRING T568 A/B

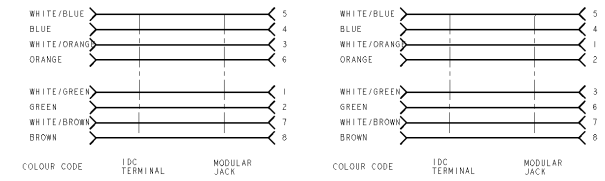

DIMENSIONS:	TOLERANCES UNLESS OTHERWISE SPECIFIED:
mm	0 PLC ±
	1 PLC ±0.20
	2 PLC ±0.10
	3 PLC ±
	4 PLC ±
	ANGLES ±
MATERIAL	FINISH

DWN 07MAY2009	Tyco Electronics	Tyco Electronics AMP España, S.A. Barcelona, Spain.
CHK A. CARRERAS		
APVD L. DE DIOS	NAME	AMP-TWIST 6AS SL JACK WITH DUST COVER
APVD I. SANABRA	SIZE	A3
PRODUCT SPEC 108-93028	CAGE CODE	00779
APPLICATION SPEC 411-93016	DRAWING NO	C-1711592
WEIGHT	RESTRICTED TO	
CUSTOMER DRAWING	SCALE	2:1