

REV	DATE	DESCRIPTION	BY	CHK	APP
00					
01					
02					
03					
04					
05					
06					
07					
08					
09					
10					
11					
12					
13					
14					
15					
16					
17					
18					
19					
20					

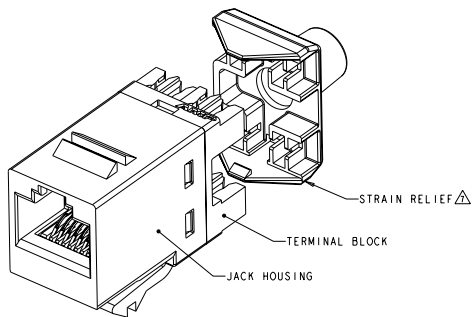

- △ MATERIAL: JACK HOUSING - POLYCARBONATE, 94V-0 RATED. 110 BLOCK AND STRAIN RELIEF - POLYCARBONATE. ARRAY TRAY - PBT POLYESTER. JACK CONTACTS ARRAY - BERYLLIUM COPPER, PLATED WITH 1.2µm (1.00005) MINIMUM THICK GOLD IN LOCALIZED AREA AND 3.8µm (1.00015) MINIMUM THICK MATTE TIN IN BOARD INTERFACE AREA OVER 1.27µm (1.00005) MINIMUM THICK NICKEL UNDERPLATE. IDC TERMINALS - PHOSPHOROUS BRONZE, PLATED WITH 3.8µm (1.00015) MINIMUM THICK MATTE TIN OVER 1.27µm (1.00005) MINIMUM THICK NICKEL UNDERPLATE.
- 2. SL 110 JACK WILL TERMINATE 22-24 AWG SOLID AND 24-26 AWG STRANDED CONDUCTORS, 1.271 (0.050) MAXIMUM INSULATION DIAMETER. JACK WILL ACCEPT CONDUCTORS UP TO 1.45 (1.057) BUT REQUIRE THE USE OF A STRAIN RELIEF.
- △ CAVITY CONFORMS TO FCC RULES AND REGULATIONS PART 68 SUBPART F REQUIREMENTS.
- 4. MOUNTING PANEL THICKNESS 1.47 - 1.60 (1.058 - .063).
- △ THESE TWO SUGGESTED CUTOUT OPENINGS ARE USED IN TANDEM WITH DUAL FRONT AND BACK CUTOUTS.
- △ ONE MODULAR JACK ASSEMBLY AND ONE STRAIN RELIEF PER POLYBAG.
- △ USE OF STRAIN RELIEF IS OPTIONAL.
- △ REFER TO 408-8858 FOR TERMINATION INSTRUCTIONS USING SL SERIES TOOL TERMINATION. REFER TO 408-8417 FOR TERMINATION INSTRUCTIONS USING 110 PUNCH DOWN TOOL.
- △ TWENTY-FIVE MODULAR JACKS PER POLYBAG.

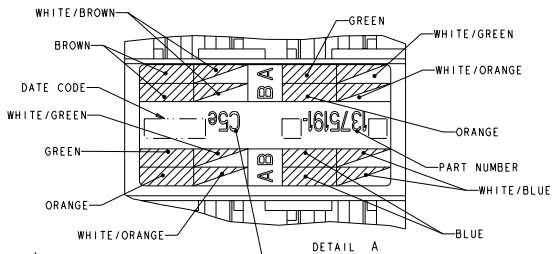
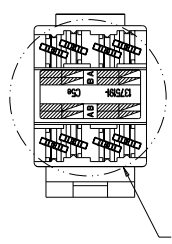
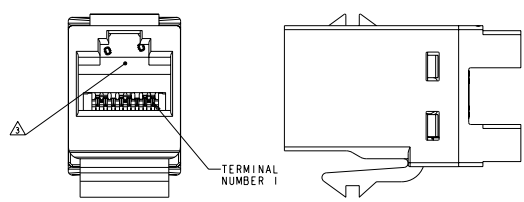

CATEGORY PERFORMANCE SYMBOL

ALPINE WHITE	3-1375191-3
ELECTRIC IVORY	3-1375191-1
VIOLET	3-1375191-0
GREEN	2-1375191-9
YELLOW	2-1375191-8
RED	2-1375191-7
BLUE	2-1375191-6
ORANGE	2-1375191-5
NEMA GRAY	2-1375191-4
WHITE	2-1375191-3
BLACK	2-1375191-2
LIGHT ALMOND	2-1375191-1
ALPINE WHITE	1-1375191-3
ELECTRIC IVORY	1-1375191-1
VIOLET	1-1375191-0
GREEN	1375191-9
YELLOW	1375191-8
RED	1375191-7
BLUE	1375191-6
ORANGE	1375191-5
NEMA GRAY	1375191-4
WHITE	1375191-3
BLACK	1375191-2
LIGHT ALMOND	1375191-1
PACKAGE HOUSING COLOR	PART NUMBER

COLOR CODE	IDC TERMINAL	MODULAR JACK
WHITE/BLUE	1	5
BLUE	2	4
WHITE/ORANGE	3	3
ORANGE	4	2
WHITE/GREEN	5	1
GREEN	6	2
WHITE/BROWN	7	7
BROWN	8	8

ELECTRICAL SCHEMATIC T566A

COLOR CODE	IDC TERMINAL	MODULAR JACK
WHITE/BLUE	1	5
BLUE	2	4
WHITE/ORANGE	3	1
ORANGE	4	2
WHITE/GREEN	5	3
GREEN	6	6
WHITE/BROWN	7	7
BROWN	8	8

ELECTRICAL SCHEMATIC T566B

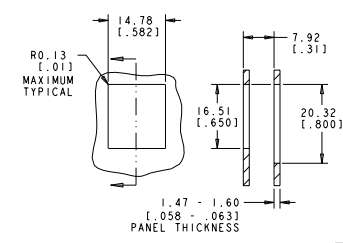
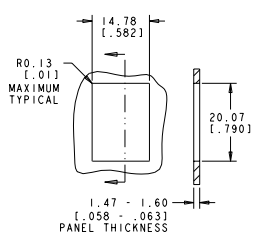

THIS DRAWING IS A CONTROLLED DOCUMENT.

DATE: 05/07/07
 BY: J. WHITE
 CHECKED: T. SMYTH
 APPROVED: C. DOOLEY
 PART NUMBER: 100-1990-2
 APPLICATION DOC: 100-1990-2

STATE: CA
 CITY: SAN JOSE
 ZIP: 95131

TE Connectivity
 ASSEMBLY, SL 110 JACK, CATEGORY 5e

STATE: CA
 CITY: SAN JOSE
 ZIP: 95131

DATE: 05/07/07
 BY: J. WHITE
 CHECKED: T. SMYTH
 APPROVED: C. DOOLEY

REVISION: 1
 DATE: 05/07/07
 BY: J. WHITE
 CHECKED: T. SMYTH
 APPROVED: C. DOOLEY

REVISION: 2
 DATE: 05/07/07
 BY: J. WHITE
 CHECKED: T. SMYTH
 APPROVED: C. DOOLEY

REVISION: 3
 DATE: 05/07/07
 BY: J. WHITE
 CHECKED: T. SMYTH
 APPROVED: C. DOOLEY

REVISION: 4
 DATE: 05/07/07
 BY: J. WHITE
 CHECKED: T. SMYTH
 APPROVED: C. DOOLEY

REVISION: 5
 DATE: 05/07/07
 BY: J. WHITE
 CHECKED: T. SMYTH
 APPROVED: C. DOOLEY

REVISION: 6
 DATE: 05/07/07
 BY: J. WHITE
 CHECKED: T. SMYTH
 APPROVED: C. DOOLEY

REVISION: 7
 DATE: 05/07/07
 BY: J. WHITE
 CHECKED: T. SMYTH
 APPROVED: C. DOOLEY

REVISION: 8
 DATE: 05/07/07
 BY: J. WHITE
 CHECKED: T. SMYTH
 APPROVED: C. DOOLEY

REVISION: 9
 DATE: 05/07/07
 BY: J. WHITE
 CHECKED: T. SMYTH
 APPROVED: C. DOOLEY

REVISION: 10
 DATE: 05/07/07
 BY: J. WHITE
 CHECKED: T. SMYTH
 APPROVED: C. DOOLEY

REVISION: 11
 DATE: 05/07/07
 BY: J. WHITE
 CHECKED: T. SMYTH
 APPROVED: C. DOOLEY

REVISION: 12
 DATE: 05/07/07
 BY: J. WHITE
 CHECKED: T. SMYTH
 APPROVED: C. DOOLEY

REVISION: 13
 DATE: 05/07/07
 BY: J. WHITE
 CHECKED: T. SMYTH
 APPROVED: C. DOOLEY

REVISION: 14
 DATE: 05/07/07
 BY: J. WHITE
 CHECKED: T. SMYTH
 APPROVED: C. DOOLEY

REVISION: 15
 DATE: 05/07/07
 BY: J. WHITE
 CHECKED: T. SMYTH
 APPROVED: C. DOOLEY

REVISION: 16
 DATE: 05/07/07
 BY: J. WHITE
 CHECKED: T. SMYTH
 APPROVED: C. DOOLEY

REVISION: 17
 DATE: 05/07/07
 BY: J. WHITE
 CHECKED: T. SMYTH
 APPROVED: C. DOOLEY

REVISION: 18
 DATE: 05/07/07
 BY: J. WHITE
 CHECKED: T. SMYTH
 APPROVED: C. DOOLEY

REVISION: 19
 DATE: 05/07/07
 BY: J. WHITE
 CHECKED: T. SMYTH
 APPROVED: C. DOOLEY

REVISION: 20
 DATE: 05/07/07
 BY: J. WHITE
 CHECKED: T. SMYTH
 APPROVED: C. DOOLEY

REVISION: 21
 DATE: 05/07/07
 BY: J. WHITE
 CHECKED: T. SMYTH
 APPROVED: C. DOOLEY

REVISION: 22
 DATE: 05/07/07
 BY: J. WHITE
 CHECKED: T. SMYTH
 APPROVED: C. DOOLEY

REVISION: 23
 DATE: 05/07/07
 BY: J. WHITE
 CHECKED: T. SMYTH
 APPROVED: C. DOOLEY

REVISION: 24
 DATE: 05/07/07
 BY: J. WHITE
 CHECKED: T. SMYTH
 APPROVED: C. DOOLEY

REVISION: 25
 DATE: 05/07/07
 BY: J. WHITE
 CHECKED: T. SMYTH
 APPROVED: C. DOOLEY