

THIS DRAWING IS UNPUBLISHED  
 © 2002 TTI ELECTRONICS CORPORATION ALL RIGHTS RESERVED

REV	DATE	DESCRIPTION	BY	APP
AD	00			
J3		REVISED PER ECO-10-020016		

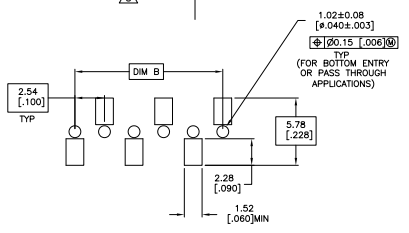
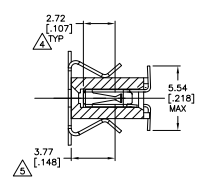
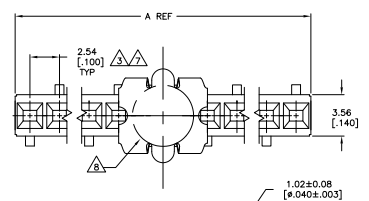
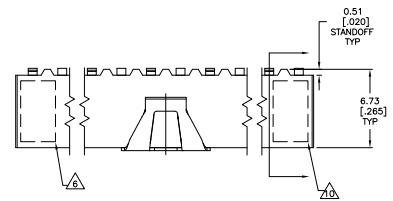

RECOMMENDED PC BOARD PAD PATTERN  
 0.20 [0.08] THICK STENCIL

120mm	88mm	72mm	44mm	24mm	EIA TAPE WIDTH	B	A	NO OF POSN	FINISH	PART NUMBER
99.06 [3.900]	101.6 [4.000]	40	△	△	△	△	△	△	△	3-147723-9
96.52 [3.800]	99.06 [3.900]	39	△	△	△	△	△	△	△	3-147723-8
93.98 [3.700]	96.52 [3.800]	38	△	△	△	△	△	△	△	3-147723-7
91.44 [3.600]	93.98 [3.700]	37	△	△	△	△	△	△	△	3-147723-6
88.90 [3.500]	91.44 [3.600]	36	△	△	△	△	△	△	△	3-147723-5
86.34 [3.400]	88.90 [3.500]	35	△	△	△	△	△	△	△	3-147723-4
83.82 [3.300]	86.34 [3.400]	34	△	△	△	△	△	△	△	3-147723-3
81.28 [3.200]	83.82 [3.300]	33	△	△	△	△	△	△	△	3-147723-2
78.74 [3.100]	81.28 [3.200]	32	△	△	△	△	△	△	△	3-147723-1
76.20 [3.000]	78.74 [3.100]	31	△	△	△	△	△	△	△	3-147723-0
73.66 [2.900]	76.20 [3.000]	30	△	△	△	△	△	△	△	2-147723-9
71.12 [2.800]	73.66 [2.900]	29	△	△	△	△	△	△	△	2-147723-8
68.58 [2.700]	71.12 [2.800]	28	△	△	△	△	△	△	△	2-147723-7
66.04 [2.600]	68.58 [2.700]	27	△	△	△	△	△	△	△	2-147723-6
63.5 [2.500]	66.04 [2.600]	26	△	△	△	△	△	△	△	2-147723-5
60.96 [2.400]	63.5 [2.500]	25	△	△	△	△	△	△	△	2-147723-4
58.42 [2.300]	60.96 [2.400]	24	△	△	△	△	△	△	△	2-147723-3
55.88 [2.200]	58.42 [2.300]	23	△	△	△	△	△	△	△	2-147723-2
53.34 [2.100]	55.88 [2.200]	22	△	△	△	△	△	△	△	2-147723-1
50.8 [2.000]	53.34 [2.100]	21	△	△	△	△	△	△	△	2-147723-0
48.26 [1.900]	50.8 [2.000]	20	△	△	△	△	△	△	△	1-147723-9
45.72 [1.800]	48.26 [1.900]	19	△	△	△	△	△	△	△	1-147723-8
43.18 [1.700]	45.72 [1.800]	18	△	△	△	△	△	△	△	1-147723-7
40.64 [1.600]	43.18 [1.700]	17	△	△	△	△	△	△	△	1-147723-6
38.1 [1.500]	40.64 [1.600]	16	△	△	△	△	△	△	△	1-147723-5
35.56 [1.400]	38.1 [1.500]	15	△	△	△	△	△	△	△	1-147723-4
33.02 [1.300]	35.56 [1.400]	14	△	△	△	△	△	△	△	1-147723-3
30.48 [1.200]	33.02 [1.300]	13	△	△	△	△	△	△	△	1-147723-2
27.94 [1.100]	30.48 [1.200]	12	△	△	△	△	△	△	△	1-147723-1
25.4 [1.000]	27.94 [1.100]	11	△	△	△	△	△	△	△	1-147723-0
22.86 [0.900]	25.4 [1.000]	10	△	△	△	△	△	△	△	147723-9
20.32 [0.800]	22.86 [0.900]	9	△	△	△	△	△	△	△	147723-8
17.78 [0.700]	20.32 [0.800]	8	△	△	△	△	△	△	△	147723-7
15.24 [0.600]	17.78 [0.700]	7	△	△	△	△	△	△	△	147723-6
12.7 [0.500]	15.24 [0.600]	6	△	△	△	△	△	△	△	147723-5
10.16 [0.400]	12.7 [0.500]	5	△	△	△	△	△	△	△	147723-4
7.62 [0.300]	10.16 [0.400]	4	△	△	△	△	△	△	△	147723-3
5.08 [0.200]	7.62 [0.300]	3	△	△	△	△	△	△	△	147723-2
2.54 [0.100]	5.08 [0.200]	2	△	△	△	△	△	△	△	147723-1

- △ HOUSING: GLASS FILLED, FLAME RETARDANT POLYESTER, BLACK
- △ CONTACTS: PHOSPHOR BRONZE, VACUUM COVER: STAINLESS STEEL
- △ CONTACTS: DUPLEX PLATED: 0.76 $\mu$ m [0.00030] GOLD IN CONTACT AREA 3.81-7.62 $\mu$ m [0.00150-0.00300] BRIGHT TIN-LEAD ON LEADS, ALL OVER 1.27 $\mu$ m [0.00050] MINIMUM NICKEL.
- △ THESE DIMENSIONS PERTAIN TO CAVITY CENTERLINES ONLY. NOT TO CONTACT LOCATION.
- △ POINT OF CONTACT DIMENSION.
- △ DATE CODE AND PART NUMBER, ARE MARKED IN APPROXIMATE LOCATION SHOWN.
- △ TOLERANCE IS NON-CUMULATIVE.
- △ 5.2 [0.205] MIN TARGET AREA FOR VACUUM PICK-UP COVERS TO BE REMOVED AFTER SOLDERING.
- △ FOR 2 POS, DATE CODE IS STAMPED OPPOSITE SIDE OF TE LOGO.
- △ TE LOGO AND CSA LOGO ARE MOLDED INTO HOUSING.
- △ NO PART NUMBER MARKING REQUIRED ON THIS PART.
- △ CONTACT: DUPLEX PLATED: 0.76 MICROMETERS (0.00030) GOLD IN CONTACT AREA, 3.81-7.62 MICROMETERS (0.00150-0.00300) MATTE TIN ON LEADS, ALL OVER 1.27 MICROMETERS (0.00050) MINIMUM NICKEL.
- △ ROHS 2002/95/EC COMPLIANT
- △ OBSOLETE PARTS: OBSOLETE CIS STREAMLINING PER D.RENAUD/D.SINISI

△ OBSOLETE

THIS DRAWING IS A CONTROLLED DOCUMENT. TTI ELECTRONICS CORPORATION, Harrisburg, Pa 17105-3008

REPT. ASSY., MOD IV, SINGLE ROW, 100 CL, SURFACE MOUNT, VERTICAL, DUAL ENTRY CLOSED ENTRY

DATE: 11-14-2002

SIZE: 6.1

CUSTOMER DRAWING

EIA TAPE WIDTH	B	A	NO OF POSN	FINISH	PART NUMBER
120mm	99.06 [3.900]	101.6 [4.000]	40	Δ Δ Δ	8-147723-9
	96.52 [3.800]	99.06 [3.900]	39	Δ Δ Δ	8-147723-8
	93.98 [3.700]	96.52 [3.800]	38	Δ Δ Δ	8-147723-7
	91.44 [3.600]	93.98 [3.700]	37	Δ Δ Δ	8-147723-6
	88.90 [3.500]	91.44 [3.600]	36	Δ Δ Δ	8-147723-5
	86.34 [3.400]	88.90 [3.500]	35	Δ Δ Δ	8-147723-4
	83.82 [3.300]	86.34 [3.400]	34	Δ Δ Δ	8-147723-3
	81.28 [3.200]	83.82 [3.300]	33	Δ Δ Δ	8-147723-2
	78.74 [3.100]	81.28 [3.200]	32	Δ Δ Δ	8-147723-1
	76.20 [3.000]	78.74 [3.100]	31	Δ Δ Δ	8-147723-0
	73.66 [2.900]	76.20 [3.000]	30	Δ Δ Δ	7-147723-9
	71.12 [2.800]	73.66 [2.900]	29	Δ Δ Δ	7-147723-8
	68.58 [2.700]	71.12 [2.800]	28	Δ Δ Δ	7-147723-7
	66.04 [2.600]	68.58 [2.700]	27	Δ Δ Δ	7-147723-6
88mm	63.5 [2.500]	66.04 [2.600]	26	Δ Δ Δ	7-147723-5
	60.96 [2.400]	63.5 [2.500]	25	Δ Δ Δ	7-147723-4
	58.42 [2.300]	60.96 [2.400]	24	Δ Δ Δ	7-147723-3
	55.88 [2.200]	58.42 [2.300]	23	Δ Δ Δ	7-147723-2
	53.34 [2.100]	55.88 [2.200]	22	Δ Δ Δ	7-147723-1
	50.8 [2.000]	53.34 [2.100]	21	Δ Δ Δ	7-147723-0
72mm	48.26 [1.900]	50.8 [2.000]	20	Δ Δ Δ	6-147723-9
	45.72 [1.800]	48.26 [1.900]	19	Δ Δ Δ	6-147723-8
	43.18 [1.700]	45.72 [1.800]	18	Δ Δ Δ	6-147723-7
	40.64 [1.600]	43.18 [1.700]	17	Δ Δ Δ	6-147723-6
	38.1 [1.500]	40.64 [1.600]	16	Δ Δ Δ	6-147723-5
	35.56 [1.400]	38.1 [1.500]	15	Δ Δ Δ	6-147723-4
	33.02 [1.300]	35.56 [1.400]	14	Δ Δ Δ	6-147723-3
	30.48 [1.200]	33.02 [1.300]	13	Δ Δ Δ	6-147723-2
	27.94 [1.100]	30.48 [1.200]	12	Δ Δ Δ	6-147723-1
	25.4 [1.000]	27.94 [1.100]	11	Δ Δ Δ	6-147723-0
64mm	22.86 [900]	25.4 [1.000]	10	Δ Δ Δ	5-147723-9
	20.32 [800]	22.86 [900]	9	Δ Δ Δ	5-147723-8
	17.78 [700]	20.32 [800]	8	Δ Δ Δ	5-147723-7
	15.24 [600]	17.78 [700]	7	Δ Δ Δ	5-147723-6
	12.7 [500]	15.24 [600]	6	Δ Δ Δ	5-147723-5
	10.16 [400]	12.7 [500]	5	Δ Δ Δ	5-147723-4
48mm	7.62 [300]	10.16 [400]	4	Δ Δ Δ	5-147723-3
	5.08 [200]	7.62 [300]	3	Δ Δ Δ	5-147723-2
	2.54 [100]	5.08 [200]	2	Δ Δ Δ	5-147723-1

Δ Δ Δ OBSOLETE

THIS DRAWING IS A CONTROLLED DOCUMENT.		REV. CONTROL	DATE	TDS Electronics Corporation Harrisburg, Pa 17105-3608
DESIGNED BY	W. OLSON	DATE	108-25026	REPT. ASSY., MOD IV, SINGLE ROW, 100 CL, SURFACE MOUNT, VERTICAL, DUAL ENTRY
CHKD BY		DATE	114-25018	CLOSED ENTRY
APP'D BY		DATE		
DRAWN BY		DATE		
CUSTOMER DRAWING		DATE	100779	REV. 2