

THIS DRAWING IS UNPUBLISHED. RELEASED FOR PUBLICATION. ALL RIGHTS RESERVED.

LOC	DIST	REVISIONS		
P	LTR	DESCRIPTION	DATE	BY
P2		REVISED PER ECO-11-004587	11MAR11	RK HMR

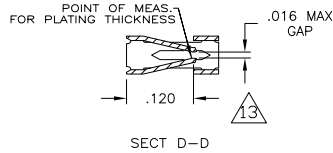
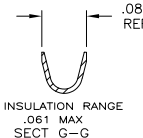
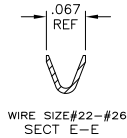
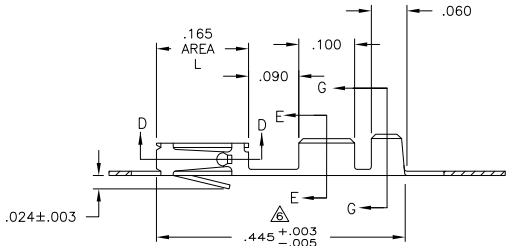
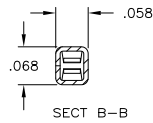
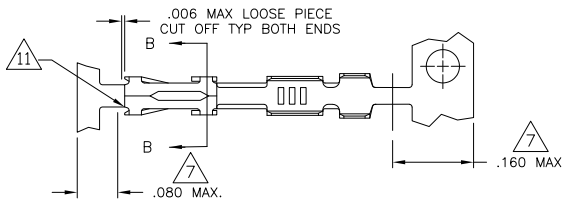

- 1 REELED FOR MINI APPLICATOR
- 2 .000030 GOLD OVER .000050 NICKEL
- 3 GOLD FLASH OVER NICKEL,.000030 GOLD ON CONTACT AREA
- 4 PREPLATED:(HALT).000078-.000158 BRIGHT TIN
- 5 .000050 GOLD OVER .000050 NICKEL
- 6 GOLD FLASH OVER NICKEL,.000015 GOLD ON CONTACT AREA
- 7 GOLD PLATING NOT REQUIRED IN THIS AREA
- 8 .000050 GOLD ON CONTACT AREA,GOLD FLASH AREA L OVER.000050/.000100 NICKEL ENTIRE CONTACT
- 9 SHEARED EDGES MAY BE UNPLATED
- 10 REELED FOR STANDARD APPLICATOR
- 11 CUT OUTS ON BOX AT MANUFACTURER'S OPTION
- 12 OBSOLETE PART NUMBER
- 13 PT.OF MEAS.FOR PLATING THICKNESS(INSIDE BEAMS)
- 14 .000015 GOLD IN THE CONTACT AREA, .000050 NICKEL OVER THE ENTIRE TERMINAL
- 15 OBSOLETE PARTS: OBSOLETE CIS STREAMLINING PER D.RENAUD/D.SINISI

			12 -7	9 14	1-87666-9
9 15	OBSOLETE	1-12 -7	87667-6	8 7	1-87666-6
		1-12 -1	87667-5	6 7	87666-5
		1-12 -0	87667-4	5 7	87666-4
		12 -9	87667-3	4	87666-3
		12 -8	87667-2	3 7	87666-2
		12 -7	87667-1	2 7	87666-1
		PART NO. LOOSE PIECE PART NO.		FINISH	1 PART NO.

THIS DRAWING IS A CONTROLLED DOCUMENT. E.C.CLAYBAUGH 8/03/98

TE Connectivity

CONTACT, FEMALE
MOD IV, CRIMP SNAP-IN

APPROVED: [Signature]

DATE: 8/03/98

SIZE: A2 CASE CODE: C-87666 DRAWING NO: 87666

MATERIAL: BERYLLIUM COPPER .008 THK. COMPL. FINISH: SEE TABLE

CUSTOMER DRAWING SCALE: 8:1 SHEET: 1 of 1 REV: P2