

4

3

2

1

THIS DRAWING IS UNPUBLISHED. RELEASED FOR PUBLICATION. ALL RIGHTS RESERVED.

LOC	DIST	REV	DESCRIPTION	DATE	BY	APPD
GP	00	F	LNK			
		K2	REVISED PER ECO-11-005140	26MAR11	RK	HMR

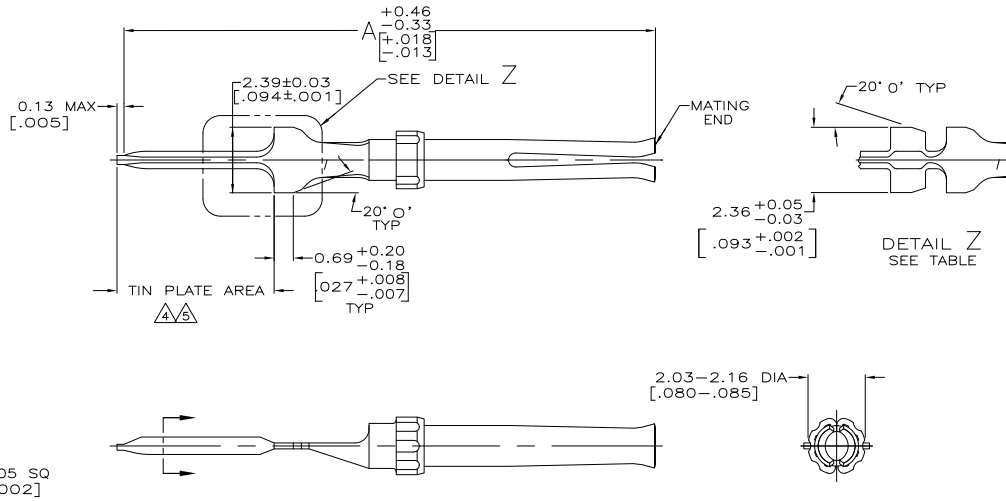

1. FOR MATING CONTACT SEE DRAWING 745287.
2. TO BE USED FOR REPLACEMENT ONLY.

- ⚠️ PLATED GOLD FLASH FOR LENGTH OF 2.54 [.100] MIN FROM MATING END, 2.54µm [.000100] MIN TIN ON TIN PLATE AREA, ALL OVER 1.27µm [.000050] MIN NICKEL.
- ⚠️ PLATED GOLD FLASH FOR LENGTH OF 2.54 [.100] MIN FROM MATING END 2.54µm [.000100] MIN TIN-LEAD ON TIN PLATE AREA, ALL OVER 1.27µm [.000050] MIN NICKEL.
- ⚠️ PLATED 0.76µm [.000030] GOLD FOR LENGTH OF 2.54 [.100] MIN FROM MATING END, 2.54µm [.000100] MIN TIN-LEAD ON TIN PLATE AREA, ALL OVER 1.27µm [.000050] MIN NICKEL.
- ⚠️ GOLD PLATED AS FOLLOWS:  
 PLATED WITH 0.76µm [.000030] GOLD FOR A LENGTH OF 2.54 [.100] MIN FROM MATING END, 2.54µm [.000100] MIN TIN ON TIN PLATE AREA, ALL OVER 1.27µm [.000050] MIN NICKEL.  
 OR  
 GOLD FLASH OVER PALLADIUM-NICKEL PLATE, 0.76µm [.000030] MIN TOTAL FOR A LENGTH OF 2.54 [.100] MIN FROM MATING END, 2.54µm [.000100] MIN TIN ON TIN PLATE AREA, ALL OVER 1.27µm [.000050] MIN NICKEL.

⚠️ MATERIAL: PHOSPHOR BRONZE.

PER DETAIL Z	26.92	[1.060]	⚠️	7-745288-2	
AS SHOWN	30.15	[1.187]	⚠️	7-745288-0	
PER DETAIL Z	32.56	[1.282]	⚠️	6-745288-1	
PER DETAIL Z	26.92	[1.060]	⚠️	5-745288-8	
AS SHOWN	19.30	[.760]	⚠️	5-745288-5	
SUPERSEDED BY 7-745288-0	AS SHOWN	30.15	[1.187]	⚠️	4-745288-4
SUPERSEDED BY 7-745288-0	AS SHOWN	21.16	[.833]	⚠️	2-745288-0
OBSOLETE	AS SHOWN	21.16	[.833]	⚠️	1-745288-8
SUPERSEDED BY 6-745288-1	PER DETAIL Z	32.56	[1.282]	⚠️	1-745288-2
SUPERSEDED BY 7-745288-2	PER DETAIL Z	32.56	[1.282]	⚠️	1-745288-0
SUPERSEDED BY 5-745288-8	PER DETAIL Z	26.92	[1.060]	⚠️	745288-8
SUPERSEDED BY 7-745288-2	PER DETAIL Z	26.92	[1.060]	⚠️	745288-6
SUPERSEDED BY 5-745288-5	AS SHOWN	19.30	[.760]	⚠️	745288-4
SUPERSEDED BY 5-745288-5	AS SHOWN	19.30	[.760]	⚠️	745288-2

THIS DRAWING IS A CONTROLLED DOCUMENT.

DATE: 29 JAN 91  
 BY: R. SHIBBY  
 CHECKED: J. McCLENTON  
 DATE: 06 FEB 91

TE Connectivity  
 SOCKET CONTACT, SIZE 20 DF, AMPLIMITE

RETENTION TINES: A FINISH PART NO

DIMENSIONS	TOLERANCES UNLESS OTHERWISE SPECIFIED	APPROVALS	RESTRICTED TO
mm [INCHES]	0 PLG ± .015 [0.05] 1 PLG ± .015 [0.05] 2 PLG ± .015 [0.05] 3 PLG ± .015 [0.05] 4 PLG ± .015 [0.05]	PRODUCT SPEC APPLICATION SPEC WEIGHT	SIZE CASE CODE DRAWING NO A2 00779 C=745288

MATERIAL: PHOSPHOR BRONZE  
 FINISH: ⚠️ ⚠️ ⚠️ ⚠️ ⚠️

CUSTOMER DRAWING SCALE: 10:1 SHEET: 1 of 1 REV: K2

1471-9 (3/11)

745288

A