

4

3

2

1

THIS DRAWING IS UNPUBLISHED. RELEASED FOR PUBLICATION  
 © COPYRIGHT - By - ALL RIGHTS RESERVED.

LOC	DIST	REVISIONS				
DF	DO	P	LR	DATE	BY	APPD
		G1		REVISED PER ECO-11-005030	11MAR11	RK HMR

1. ALL DIMENSIONS APPLY AFTER PLATING.
  2. THIS PART COMPLIES WITH SPEC. MIL-C-24308/11, EXCEPT WIRE BARREL.
  3. ALL DIAMETERS CONCENTRIC WITH EACH OTHER WITHIN .004 T.I.R.
  4. ALL SURFACES HAVE  $\sqrt{32}$  FINISH OR BETTER UNLESS OTHERWISE NOTED.
- $\Delta$  POINT OF PLATING MEASUREMENT.  
 $\Delta$  FINISH: PLATED GOLD PER MIL-C-45204 OVER COPPER PER MIL-C-14550.

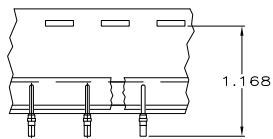
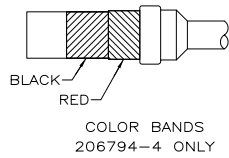
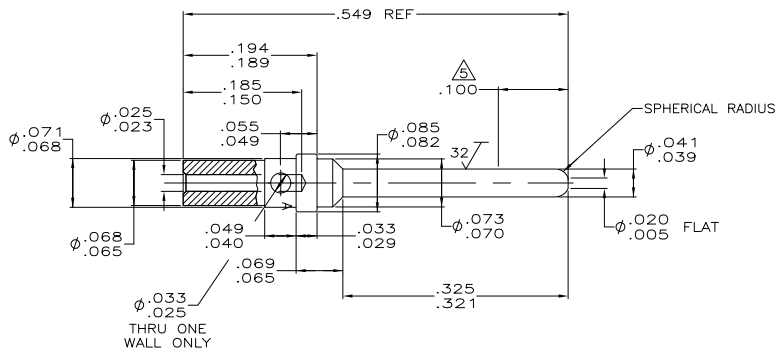

TAPE MOUNTED  
 206794-3 ONLY  
 SCALE: NTS

SUPERSEDED BY 206794-3	TAPE MOUNTED	—	206794-4	206794-5
	COLOR CODED	—	206794-2	206794-4
	TAPE MOUNTED	—	206794-2	206794-3
	AS SHOWN	$\Delta$	COPPER ALLOY #187	206794-2
REMARKS	FINISH	MATERIAL	PART NUMBER	

THIS DRAWING IS A CONTROLLED DOCUMENT.		DR. C. C. THOMAS 7/24/00		TE Connectivity
DIMENSIONS: INCHES		CHK. 9-5-00		
MATERIAL: COPPER ALLOY NO. 187		FINISH: SEE TABLE	PIN CONTACT, SIZE 20 (FOR #26 & #28 AWG WIRE)	
APPROVALS:		APPROVED: 9-5-00	SIZE: A2	CAGE CODE: 00779
DRAWING NO: 206794		REVISION: C	SCALE: 10:1	SHEET: 1 of 1
CUSTOMER DRAWING		DATE: 11MAR11	BY: RK	APPD: HMR