

**Specification Status: Released**

**Maximum Electrical Rating**

**Operating Voltage: 16Vdc**  
**Interrupt Current: 100A**

Chip Size: 2.8 X 9.6mm

Leads: Nickel 1/2H  
0.125mm nominal thickness

Tape: None

Solder: Lead-free

Marking:

□□□□ — Lot Identification

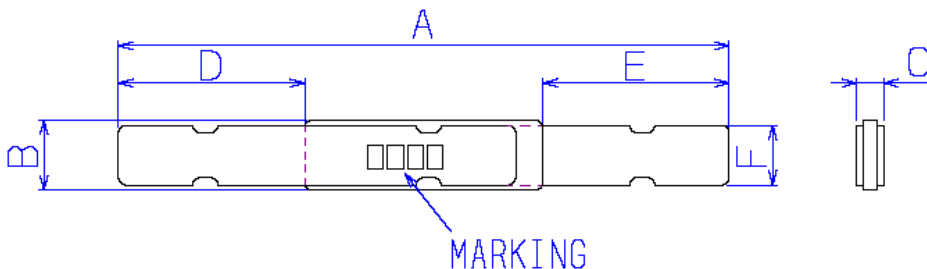

**TABLE I. DIMENSIONS:**

	A		B		C		D		E		F	
	MIN	MAX	MIN	MAX	MIN	MAX	MIN	MAX	MIN	MAX	MIN	MAX
mm:	23.6	25.6	2.7	2.9	---	0.7	7.0	8.0	7.0	8.0	2.3	2.5
in*:	(0.93)	(1.01)	(0.11)	(0.11)	--	(0.03)	(0.28)	(0.31)	(0.28)	(0.31)	(0.09)	(0.10)

\*Rounded off approximation

**TABLE II. PERFORMANCE RATINGS: As measured in Mueller Kelvin Clips model BU-75K.**

I HOLD	CURRENT TRIP LIMITS									TIME TO TRIP	REFERENCE RESISTANCE	ONE-HOUR POST-TRIP RESISTANCE	TRIPPED-STATE POWER DISSIPATION			
	AMPS AT 0°C		AMPS AT 25°C		AMPS AT 60°C		AMPS AT --°C		SECONDS AT 20°C, 5.5A					OHMS AT 25°C		WATTS AT 25°C, 16V MAX
HOLD	HOLD	TRIP	HOLD	TRIP	HOLD	TRIP	HOLD	TRIP	HOLD	TRIP	MIN	MAX	MIN	MAX	MIN	
1.1	1.4	3.4	1.1	2.7	0.7	1.7	---	---	---	5	0.038	0.070	0.038	0.140	1.3	

Agency Recognitions:  
Reference Documents:  
Precedence:  
Effectivity:  
CAUTION:

UL, TUV, CSA  
PS300  
This specification takes precedence over documents referenced herein.  
Reference documents shall be the issue in effect on the date of invitation for bid.  
Operation beyond the rated voltage or current may result in rupture, electrical arcing or flame.

Materials Information:

**ROHS Compliant**

**ELV Compliant**

**Pb-Free**

Directive 2000/53/EC  
Compliant

Directive 2002/95/EC  
Compliant

