

4

3

2

1

THIS DRAWING IS UNPUBLISHED. RELEASED FOR PUBLICATION. ALL RIGHTS RESERVED.

WHEN ORDERING CONTACT ON TAPE, ORDER BY THE TAPE NUMBER PLUS THE PACKAGING CODE AS FOLLOWS:

- 2. FOR USE WITH AMP TAPETRONIC, PNEUMATIC TOOL-
 - A. 1000 PARTS TO A BOX ADD PACKAGING CODE: 1MBOX
- 3. FOR USE WITH 4/8 INDENT STRIPPER CRIMP-
 - A. 1000 PARTS TO A REEL ADD PACKAGING CODE: 1MREEL
 - B. 5000 PARTS TO A REEL ADD PACKAGING CODE: 5MREEL

LOC	DIST	REVISIONS					
DF	DO	P	LR	DESCRIPTION	DATE	BY	APPD
		U		REV PER ECO-10-020411	02DEC10	SK	RL

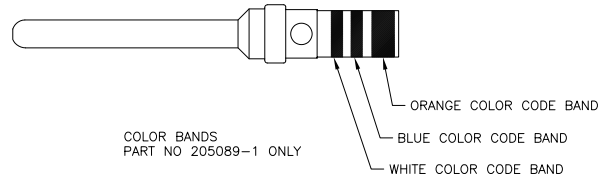
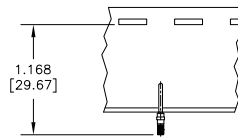
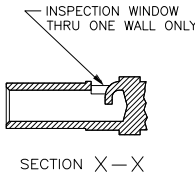
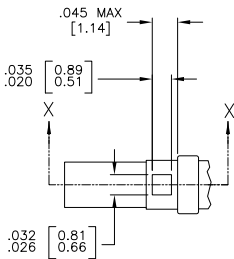
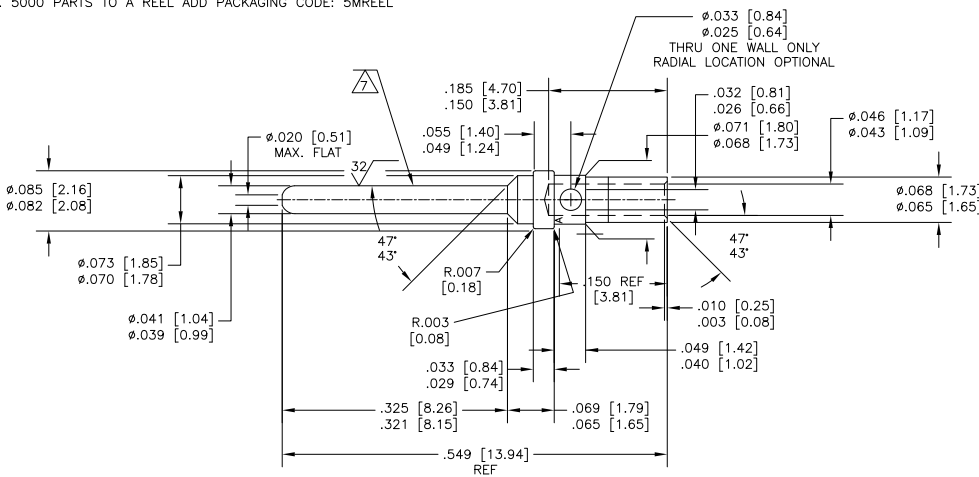

- 1. MATERIAL: COPPER ALLOY PER MIL-C-39029 & MIL-DTL-24308.
- 2. ALL DIMENSIONS APPLY AFTER PLATING.
- 3. THIS DRAWING COMPLIES WITH SPECIFICATION MIL-C-39029/64 & M24308/11-1.
- 4. ALL DIAMETERS CONCENTRIC WITH EACH OTHER WITHIN .004 T.I.R.
- 5. PIN MATES WITH SOCKET 205090 (MIL-C-39029/63).
- 6. ALL SURFACES HAVE 63 OR BETTER FINISH, UNLESS SHOWN.
- 7. POINT OF PLATING MEASUREMENT .188 [4.78] FROM TIP OF PIN.
- 8. PLATING: GOLD PER ASTM-B-488 (TYPEII) OVER NICKEL PER QQ-N-290.
- 9. PLATING: GOLD PER ASTM-B-488 (TYPEII) OVER COPPER PER MIL-C-14550, CLASS 4.
- 10. PLATING: GOLD PER ASTM-B-488 (TYPE II, CLASS 0) OVER NICKEL PER QQ-N-290.
- 11. PLATING:
 - MATING AREA: GOLD PER ASTM-B-488 (TYPE II) OVER NICKEL PER QQ-N-290.
 - NON MATING AREA: GOLD PER ASTM-B-488 OVER NICKEL PER QQ-N-290.

WITHOUT COLOR CODE	1-205089-1
WITHOUT COLOR CODE	1-205089-0
WITHOUT COLOR CODE	205089-4
CONTACT ON TAPE	SAME AS -1 205089-2
AS SHOWN	205089-1
DESCRIPTION	PLATING PART NO.

THIS DRAWING IS A CONTROLLED DOCUMENT. DATE: 25AUG2003

DIMENSIONS: INCHES. TOLERANCES UNLESS OTHERWISE SPECIFIED.

MATERIAL: FINISH.

APPROVED: J. KAISER, D. MILLER, D. MILLER. DATE: 10-13-03. NAME: D. MILLER. PRODUCT SPEC: APPLICATION SPEC: WEIGHT: SIZE: A2. CASE CODE: C-205089. DRAWING NO: RESTRICTED TO: CUSTOMER DRAWING. SCALE: 10:1. SHEET: 1 of 1. REV: U.

TE Connectivity

PIN SIZE 20 CONTACT, AMPLIMITE