

THIS DRAWING IS UNPUBLISHED. RELEASED FOR PUBLICATION AUG. 2008.  
 © COPYRIGHT BY TYCO ELECTRONICS CORPORATION. ALL RIGHTS RESERVED.

LOC	DIST	REVISIONS			
P	LR	DESCRIPTION	DATE	DRN	APP'D
	A1	REVISED PER ECO-09-026495	30NOV09	KK	AEG

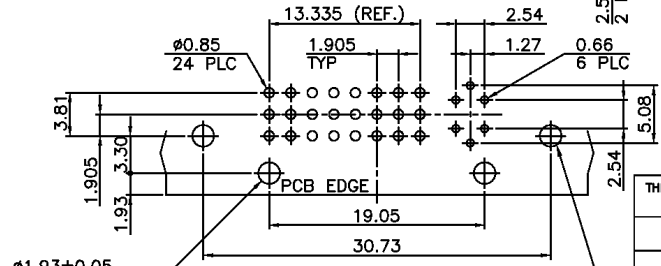
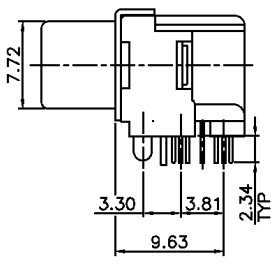
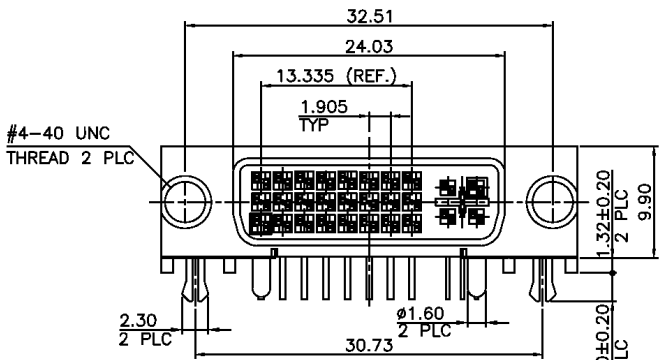
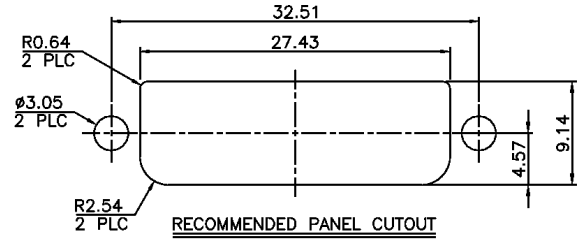
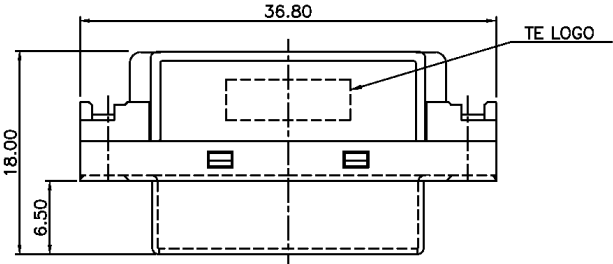

- NOTES:
- MATERIAL:  
 HOUSING: THERMOPLASTIC, UL 94V-0 RATED WHITE COLOR.  
 CONTACT: PHOSPHOR BRONZE, THICKNESS=0.3mm.  
 ANALOG CONTACT: PHOSPHOR BRONZE, THICKNESS=0.3mm.  
 ANALOG GROUND: PHOSPHOR BRONZE, THICKNESS=0.3mm.  
 SHELL: SPCC-SD HARD=H.  
 HOOK: BRASS, THICKNESS=0.5mm.  
 NUT: BRASS.
  - FINISH:  
 CONTACT: GOLD PLATED(SEE TABLE) ON CONTACT AREA.  
 2.54µm [100µ] MIN. BRIGHT TIN PLATED ON SOLDER TAILS  
 1.27µm [50µ] MIN. NICKEL UNDERPLATED OVERALL  
 SHELL: 1.27µm [50µ] MIN. NICKEL UNDERPLATED OVERALL  
 HOOK: 2.54µm [100µ] BRIGHT TIN OVER 1.27µm [50µ] NICKEL  
 NUT: 1.27µm [50µ] NICKEL PLATED.
  - #4-40 UNC SCREW, SCREW HEAD LENGTH: 6.0±0.5mm.
  - WAVE SOLDER CAPABLE TO 240°C PER TE SPEC109-202, CONDITION A.
- ⚠️ OBSOLETE PARTS: OBSOLETE CIS STREAMLINING PER D.RENAUD/D.SINISI

⚠️ OBSOLETE	W/	0.254µm [10µ]	1-1734147-2
	W/	GOLD FLASH	1-1734147-1
⚠️ OBSOLETE	W/O	0.254µm [10µ]	1734147-2
	W/O	GOLD FLASH	1734147-1
	SCREW	MINIMUM GOLD PLATING	PART NUMBER

THIS DRAWING IS A CONTROLLED DOCUMENT.

DWN S. CHIEN 21FEB2008	APVD W. KODAMA 21FEB2008	Tyco Electronics Corporation Taipai, Taiwan	
CHK S. HOU 21FEB2008	NAME DVI-I ANALOG & DIGITAL CONN RCPT. R/A, RAISED	SIZE A3	CAGE CODE 00779
PRODUCT SPEC 108-1941		DRAWING NO C=1734147	RESTRICTED TO -
QUALIFICATION TEST REPORT -		WEIGHT 7.5 GRAMS	SCALE -
MATERIAL SEE NOTE		SHEET 1 of 2	
DIMENSIONS: MM		FINISH SEE NOTE	
TOLERANCES UNLESS OTHERWISE SPECIFIED: 0 PLC ± - 1 PLC ± 0.35 2 PLC ± 0.25 3 PLC ± - 4 PLC ± - ANGLES ± 3°		CUSTOMER DRAWING	

THIS DRAWING IS UNPUBLISHED. RELEASED FOR PUBLICATION AUG. 2008.  
 © COPYRIGHT BY TYCO ELECTRONICS CORPORATION. ALL RIGHTS RESERVED.

LOC	DIST	REVISIONS			
P	LTR	DESCRIPTION	DATE	DWN	APVD
DW		SEE SHEET 1.			

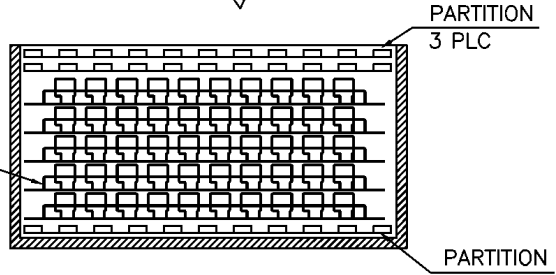
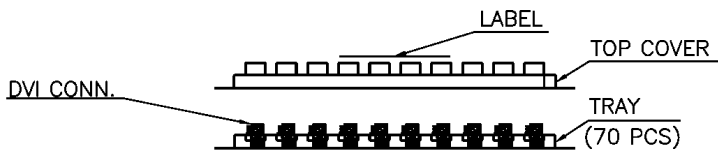

5 TRAY PER CARTON

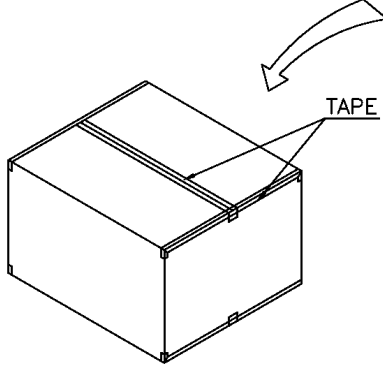

3.55	2.63	340X278X146	340X275X19.6	350
G.W./KG	N.W./KG	CARTON SIZE	TRAY SIZE	QUANTITY

THIS DRAWING IS A CONTROLLED DOCUMENT.		DWN	Tyco Electronics Corporation Tyco Electronics Taipei, Taiwan	
DIMENSIONS: MM	TOLERANCES UNLESS OTHERWISE SPECIFIED:	OK	NAME	DVI-I ANALOG & DIGITAL CONN RCPT. R/A, RAISED
	0 PLC ±	APVD	SIZE	A3
	1 PLC ±	PRODUCT SPEC	CAGE CODE	00779
	2 PLC ±	APPLICATION SPEC	DRAWING NO	1734147
	3 PLC ±	WEIGHT	RESTRICTED TO	
	4 PLC ±	CUSTOMER DRAWING	SCALE	
MATERIAL	FINISH		SHEET	2 of 2
			REV	A1

TE 1470-19 REV 31MAR2000