

THIS DRAWING IS UNPUBLISHED  
 ALL RIGHTS RESERVED

REV	DATE	DESCRIPTION	BY	CHK	APP
CM 54					
E		REVISED PER EDD-11-016326			

- MATERIAL: CONNECTOR- NYLON UL94V-2 (RED).  
 CONTACTS - 0.30 [.012] THK COPPER ALLOY  
 (PLATED 0.00076 [.000030] MIN GOLD OR 0.00008 [.000003] MIN GOLD FLASH  
 OVER 0.00068 [.000027] PALLADIUM NICKEL, PER TE CONNECTIVITY'S DISCRETION,  
 ON POST END, WITH BRIGHT TIN-LEAD 0.00203 [.000080] MIN THK ON WIRE END)  
 OR  
 CONTACTS - 0.30 [.012] THK COPPER ALLOY  
 (PLATED 0.00076 [.000030] MIN GOLD OR 0.00008 [.000003] MIN GOLD FLASH  
 OVER 0.00068 [.000027] PALLADIUM NICKEL, PER TE CONNECTIVITY'S DISCRETION,  
 ON POST END, WITH MATTE TIN 0.00203 [.000080] MIN THK ON WIRE END)
- CONTACTS ACCEPT #22 AWG SOLID, FUSED STRANDED OR  
 STRANDED (7 STRANDS) WIRE WITH 2.41 [.095] MAX INSULATION DIA.
- BOW, IN ANY DIRECTION, NOT TO EXCEED 0.15 [.006] PER IN.
- WOUND FEATURES CLOSED END  
 WOUND FEATURES CLOSED END  
 WOUND FEATURES CLOSED END  
 STREAMLINING PER D.RENAUD/D.SINISI
- DIMENSIONS IN BRACKETS ARE IN INCHES.

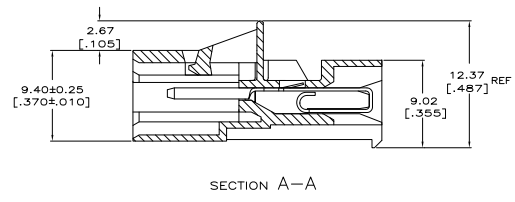
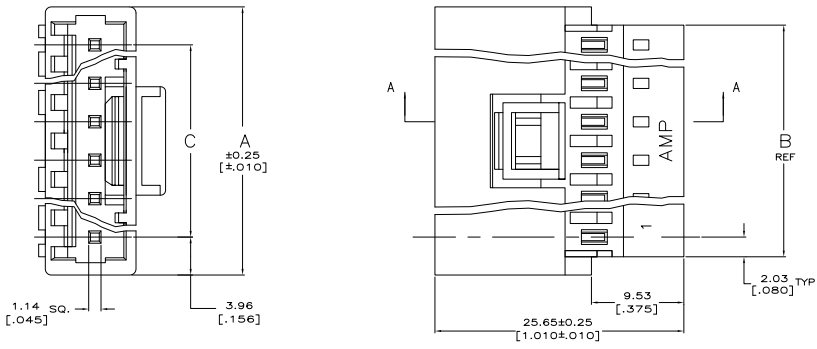

REV	DATE	DESCRIPTION	BY	CHK	APP						
51	1.4	3.588	95.20	3.748	99.06	3.900	24	5-644809-4			
55	47	2.184	59.54	2.244	63.40	2.496	15	4-644809-5			
43	59	1.716	47.65	1.876	51.51	2.028	12	4-644809-2			
31	70	1.248	35.76	1.408	39.62	1.560	9	3-644809-9			
19	81	1.780	23.88	1.940	27.74	1.092	6	3-644809-6	TIN		
11	89	1.468	15.95	1.628	19.81	1.780	4	3-644809-4			
7	92	3.12	11.99	4.72	15.85	6.24	3	3-644809-3			
3	98	1.56	8.03	3.16	11.89	4.68	2	3-644809-2			
2	114	3.588	95.20	3.748	99.06	3.900	24	2-644809-4			
1	55	47	2.184	59.54	2.244	63.40	2.496	15	1-644809-5		
△	SUPERSEDED	43	59	1.716	47.65	1.876	51.51	2.028	12	4-644809-2	
△	SUPERSEDED	31	70	1.248	35.76	1.408	39.62	1.560	9	3-644809-9	
△	SUPERSEDED	19	81	1.780	23.88	1.940	27.74	1.092	6	3-644809-6	TIN-LEAD
△	SUPERSEDED	11	89	1.468	15.95	1.628	19.81	1.780	4	3-644809-4	
△	SUPERSEDED	7	92	3.12	11.99	4.72	15.85	6.24	3	3-644809-3	
△	SUPERSEDED	3	98	1.56	8.03	3.16	11.89	4.68	2	3-644809-2	
		C	E	A							

THIS DRAWING IS A CONTROLLED DOCUMENT. REV. 1 LINES 1-31-81  
 DATE 1-31-81  
 BY S.B.M.  
 CHECKED BY S.B.M.  
 PROJECT FILE  
 DRAWING FILE  
 REVISIONS  
 SEE NOTE 1  
 SEE NOTE 1  
 CUSTOMER DRAWING  
 DATE 5.1  
 SHEET 1 OF 1  
 FINISH

TE Connectivity  
 MTA-156  
 POSTED CONNECTOR ASSEMBLY,  
 22 AWG  
 DRAWING NO. 00779  
 PART NUMBER 644809