

4

3

2

1

THIS DRAWING IS UNPUBLISHED. RELEASED FOR PUBLICATION. BY TYCO ELECTRONICS CORPORATION. ALL RIGHTS RESERVED.

LOC	DIST	REVISIONS			
F	LN	DESCRIPTION	DATE	BY	APP
H		ECO-07-012852	04JUN07	KW	DB
H1		REVISED PER ECO-09-021510	12SEP09	KK	AEG

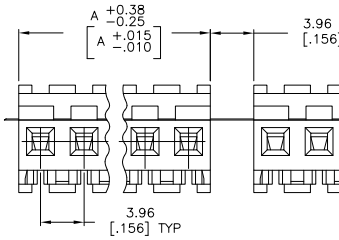
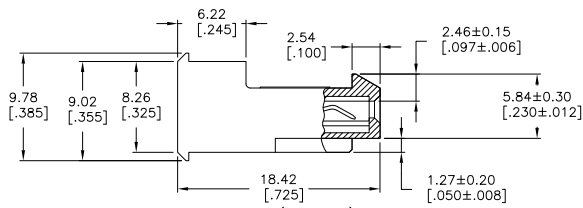
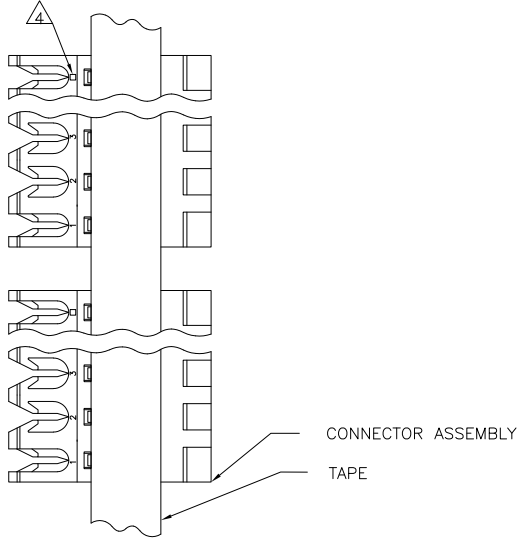

95.10	3.744	24	5-641302-4
91.14	3.588	23	5-641302-3
87.17	3.432	22	5-641302-2
83.21	3.276	21	5-641302-1
79.25	3.120	20	5-641302-0
75.29	2.964	19	4-641302-9
71.32	2.808	18	4-641302-8
67.36	2.652	17	4-641302-7
63.40	2.496	16	4-641302-6
59.44	2.340	15	4-641302-5
55.47	2.184	14	4-641302-4
51.51	2.028	13	4-641302-3
47.55	1.872	12	4-641302-2
43.59	1.716	11	4-641302-1
39.62	1.560	10	4-641302-0
35.66	1.404	9	3-641302-9
31.70	1.248	8	3-641302-8
27.74	1.092	7	3-641302-7
23.77	.936	6	3-641302-6
19.81	.780	5	3-641302-5
15.85	.624	4	3-641302-4
11.89	.468	3	3-641302-3
7.92	.312	2	3-641302-2
95.10	3.744	24	2-641302-4
91.14	3.588	23	2-641302-3
87.17	3.432	22	2-641302-2
83.21	3.276	21	2-641302-1
79.25	3.120	20	2-641302-0
75.29	2.964	19	1-641302-9
71.32	2.808	18	1-641302-8
67.36	2.652	17	1-641302-7
63.40	2.496	16	1-641302-6
59.44	2.340	15	1-641302-5
55.47	2.184	14	1-641302-4
51.51	2.028	13	1-641302-3
47.55	1.872	12	1-641302-2
43.59	1.716	11	1-641302-1
39.62	1.560	10	1-641302-0
35.66	1.404	9	641302-9
31.70	1.248	8	641302-8
27.74	1.092	7	641302-7
23.77	.936	6	641302-6
19.81	.780	5	641302-5
15.85	.624	4	641302-4
11.89	.468	3	641302-3
7.92	.312	2	641302-2

- 1 MATERIAL: CONNECTOR - NYLON UL94V-2 (ORANGE)
CONTACTS - 0.30[.012] THICK COPPER ALLOY
BRIGHT TIN-LEAD 0.00203[.000080] MIN THICK
FOR CONTACTS 641302-2 THRU 2-641302-4
MATTE WHISKER MITIGATED TIN 0.00203[.000080] MIN
THICKNESS OVER NICKEL UNDERPLATE FOR 3-641302-2
THRU 5-641302-4.
- 2. CONTACTS ACCEPT 18 AWG WIRE WITH 2.41[.095] MAX INSULATION DIAMETER.
- 3. CONTACTS MUST ACCEPT 1.14±0.03 [.045±.001] SQUARE POST AND REMAIN LOCKED IN POSITION.
- 4 IDENTIFICATION NUMBER FOR LAST CIRCUIT MAY NOT APPEAR ON ALL ASSEMBLIES.
- 5. DIMENSIONS IN BRACKETS ARE IN INCHES.
- 6. HOUSING FEATURES ARE: FEED-THRU WITH LOCKING RAMP.
- 7 OBSOLETE PARTS: OBSOLETE CIS STREAMLINING PER D.RENAUD/D.SINISI



THIS DRAWING IS A CONTROLLED DOCUMENT.

DIMENSIONS: mm [INCHES]	TOLERANCES UNLESS OTHERWISE SPECIFIED: 0 P.L.C. ± .005 1 P.L.C. ± .004 2 P.L.C. ± .003 3 P.L.C. ± 0.13 [005] 4 P.L.C. ± .002 ANGLES FINISH	DWG. BY: S. LEWIS 12 FEB 91 CHK. BY: S. LEWIS 12 FEB 91 R. BY: D. CLARK 20 FEB 91 APP'D. BY: D. CLARK PRODUCT SPEC: 108-1051 APPLICATION SPEC: 114-1020 HEIGHT: -	Tyco Electronics Corporation Harrisburg, Pa 17105-3608 MTA-156 CONNECTOR ASSEMBLY, 18 AWG, STANDARD TAPE MOUNTED	SIZE: A2 ONE CODE: 00779 DRAWING NO: C-641302	RESTRICTED TO: - SCALE: 1:1 SHEET: 1 OF 1 REV: H1
----------------------------	---	---	--	---	--

CUSTOMER DRAWING

SUPERCEDED

641302