

4

3

2

1

THIS DRAWING IS UNPUBLISHED. RELEASED FOR PUBLICATION. ALL RIGHTS RESERVED.

LOC	DIST	REVISIONS					
CM	00	F	LNK	DESCRIPTION	DATE	BY	APPD
		R2		REVISED PER ECO-11-004917	11MAR11	RK	HMR

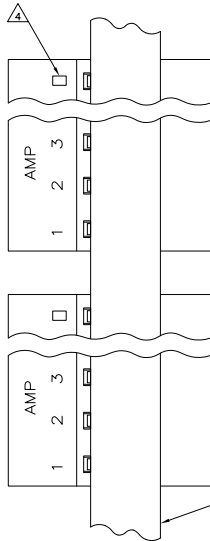

- ⚠ MATERIAL: CONNECTOR - NYLON UL94V-2 (ORANGE).
CONTACTS - 0.30 [.012] THICK COPPER ALLOY
BRIGHT TIN-LEAD 0.00203 [.000080] MIN THICK
FOR CONTACTS 640477-2 THRU 2-640477-4
MATTE WHISKER MITIGATED TIN 0.00203 [.000080]
MIN THICKNESS OVER NICKEL UNDERPLATE FOR
CONTACTS 3-640477-2 THRU 5-640477-4
- 2. CONTACTS ACCEPT 18 AWG WIRE WITH 2.41[.095] MAX
INSULATION DIAMETER.
- 3. CONTACTS MUST ACCEPT 1.14±0.03 [.045±.001] SQUARE
POST AND REMAIN LOCKED IN POSITION.
- ⚠ IDENTIFICATION NUMBER FOR LAST CIRCUIT MAY
NOT APPEAR ON ALL ASSEMBLIES.
- 5. DIMENSIONS IN BRACKETS ARE IN INCHES.
- 6. HOUSING FEATURES ARE: CLOSED END WITHOUT LOCKING
RAMP.
- ⚠ OBSOLETE PARTS: OBSOLETE CIS STREAMLINING PER D.RENAUD/D.SINISI

95.10	[3.744]	24	5-640477-4
91.14	[3.588]	23	5-640477-3
87.17	[3.432]	22	5-640477-2
83.21	[3.276]	21	5-640477-1
79.25	[3.120]	20	5-640477-0
75.29	[2.964]	19	4-640477-9
71.32	[2.808]	18	4-640477-8
67.36	[2.652]	17	4-640477-7
63.40	[2.496]	16	4-640477-6
59.44	[2.340]	15	4-640477-5
55.47	[2.184]	14	4-640477-4
51.51	[2.028]	13	4-640477-3
47.55	[1.872]	12	4-640477-2
43.59	[1.716]	11	4-640477-1
39.62	[1.560]	10	4-640477-0
35.66	[1.404]	9	3-640477-9
31.70	[1.248]	8	3-640477-8
27.74	[1.092]	7	3-640477-7
23.77	[.936]	6	3-640477-6
19.81	[.780]	5	3-640477-5
15.85	[.624]	4	3-640477-4
11.89	[.468]	3	3-640477-3
7.92	[.312]	2	3-640477-2
95.10	[3.744]	24	2-640477-4
91.14	[3.588]	23	2-640477-3
87.17	[3.432]	22	2-640477-2
83.21	[3.276]	21	2-640477-1
79.25	[3.120]	20	2-640477-0
75.29	[2.964]	19	1-640477-9
71.32	[2.808]	18	1-640477-8
67.36	[2.652]	17	1-640477-7
63.40	[2.496]	16	1-640477-6
59.44	[2.340]	15	1-640477-5
55.47	[2.184]	14	1-640477-4
51.51	[2.028]	13	1-640477-3
47.55	[1.872]	12	1-640477-2
43.59	[1.716]	11	1-640477-1
39.62	[1.560]	10	1-640477-0
35.66	[1.404]	9	640477-9
31.70	[1.248]	8	640477-8
27.74	[1.092]	7	640477-7
23.77	[.936]	6	640477-6
19.81	[.780]	5	640477-5
15.85	[.624]	4	640477-4
11.89	[.468]	3	640477-3
7.92	[.312]	2	640477-2

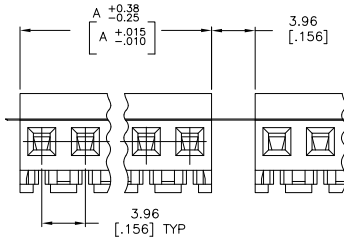
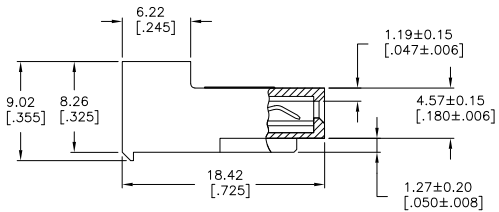

SUPERSEDED			
⚠			
SUPERSEDED			
⚠			
DIM A		NO OF CIRCUITS	PART NO

THIS DRAWING IS A CONTROLLED DOCUMENT.

DIMENSIONS: mm [INCHES]	TOLERANCES UNLESS OTHERWISE SPECIFIED:	DWG: L. SMITH 02 MAR 94	CHK: R. SWING 02 MAR 94	TE Connectivity	
0 P.L.C. ± .010	0 P.L.C. ± .010	APPD: D. CLARK 10 MAR 94	NAME: MTA-156 CONNECTOR ASSEMBLY, 18 AWG, STANDARD TAPE MOUNTED	SIZE: A2	RESTRICTED TO: -
1 P.L.C. ± .015	1 P.L.C. ± .015	PRODUCT SPEC: 108-1051	APPLICATION SPEC: 114-1020	CAGE CODE: 00779	DRAWING NO: 640477
2 P.L.C. ± .020	2 P.L.C. ± .020	MATERIAL: NYLON UL94V-2 (ORANGE)	FINISH: BRIGHT TIN-LEAD	CUSTOMER DRAWING	SCALE: 4:1 SHEET: 1 of 1 REV: R2

