

4

3

2

1

THIS DRAWING IS UNPUBLISHED. RELEASED FOR PUBLICATION. ALL RIGHTS RESERVED.

| LOC | DIST | REVISIONS | | | |
|-----|------|-------------|---------------------------|---------|--------|
| F | LNK | DESCRIPTION | DATE | BY | APPD |
| CM | 00 | Z1 | REVISED PER ECO-11-015731 | 03AUG11 | HMR SM |

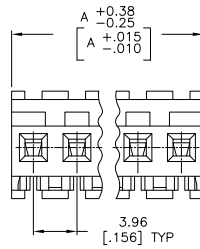
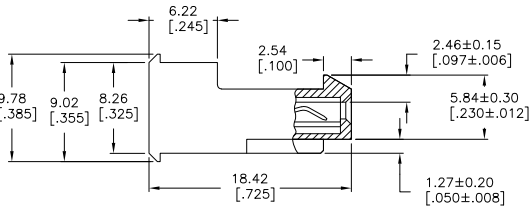
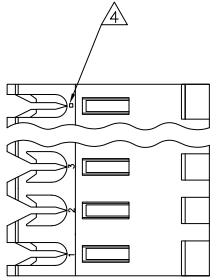

△ MATERIAL: CONNECTOR - NYLON UL94V-2 (ORANGE).
 CONTACTS - 0.00076[.000030] GOLD THK OR 0.00008[.000003] MIN THK GOLD FLASH OVER 0.00068[.000027] THK PALLADIUM NICKEL, PER TE CONNECTIVITY'S DISCRETION. IN CONTACT AREA WITH BRIGHT TIN-LEAD FOR -2 THRU -28, MATTE WHISKER MITIGATED TIN FOR 3-641227-2 THRU 5-641227-4 OVER NICKEL UNDERPLATE.

- CONTACTS ACCEPT 18 AWG WIRE WITH 2.41[.095] MAX INSULATION DIAMETER.
- CONTACTS MUST ACCEPT 1.14±0.03 [.045±.001] SQUARE POST AND REMAIN LOCKED IN POSITION.

△ IDENTIFICATION NUMBER FOR LAST CIRCUIT MAY NOT APPEAR ON ALL ASSEMBLIES.

5. DIMENSIONS IN BRACKETS ARE IN INCHES.

6. HOUSING FEATURES ARE: FEED-THRU WITH LOCKING RAMP.

△ OBSOLETE PARTS: OBSOLETE CIS STREAMLINING PER D.RENAUD/D.SINISI



| | | | |
|-------|---------|----|------------|
| 95.10 | [3.744] | 24 | 5-641227-4 |
| 91.14 | [3.588] | 23 | 5-641227-3 |
| 87.17 | [3.432] | 22 | 5-641227-2 |
| 83.21 | [3.276] | 21 | 5-641227-1 |
| 79.25 | [3.120] | 20 | 5-641227-0 |
| 75.29 | [2.964] | 19 | 4-641227-9 |
| 71.32 | [2.808] | 18 | 4-641227-8 |
| 67.36 | [2.652] | 17 | 4-641227-7 |
| 63.40 | [2.496] | 16 | 4-641227-6 |
| 59.44 | [2.340] | 15 | 4-641227-5 |
| 55.47 | [2.184] | 14 | 4-641227-4 |
| 51.51 | [2.028] | 13 | 4-641227-3 |
| 47.55 | [1.872] | 12 | 4-641227-2 |
| 43.59 | [1.716] | 11 | 4-641227-1 |
| 39.62 | [1.560] | 10 | 4-641227-0 |
| 35.66 | [1.404] | 9 | 3-641227-9 |
| 31.70 | [1.248] | 8 | 3-641227-8 |
| 27.74 | [1.092] | 7 | 3-641227-7 |
| 23.77 | [.936] | 6 | 3-641227-6 |
| 19.81 | [.780] | 5 | 3-641227-5 |
| 15.85 | [.624] | 4 | 3-641227-4 |
| 11.89 | [.468] | 3 | 3-641227-3 |
| 7.92 | [.312] | 2 | 3-641227-2 |
| 95.10 | [3.744] | 24 | 2-641227-4 |
| 91.14 | [3.588] | 23 | 2-641227-3 |
| 87.17 | [3.432] | 22 | 2-641227-2 |
| 83.21 | [3.276] | 21 | 2-641227-1 |
| 79.25 | [3.120] | 20 | 2-641227-0 |
| 75.29 | [2.964] | 19 | 1-641227-9 |
| 71.32 | [2.808] | 18 | 1-641227-8 |
| 67.36 | [2.652] | 17 | 1-641227-7 |
| 63.40 | [2.496] | 16 | 1-641227-6 |
| 59.44 | [2.340] | 15 | 1-641227-5 |
| 55.47 | [2.184] | 14 | 1-641227-4 |
| 51.51 | [2.028] | 13 | 1-641227-3 |
| 47.55 | [1.872] | 12 | 1-641227-2 |
| 43.59 | [1.716] | 11 | 1-641227-1 |
| 39.62 | [1.560] | 10 | 1-641227-0 |
| 35.66 | [1.404] | 9 | 641227-9 |
| 31.70 | [1.248] | 8 | 641227-8 |
| 27.74 | [1.092] | 7 | 641227-7 |
| 23.77 | [.936] | 6 | 641227-6 |
| 19.81 | [.780] | 5 | 641227-5 |
| 15.85 | [.624] | 4 | 641227-4 |
| 11.89 | [.468] | 3 | 641227-3 |
| 7.92 | [.312] | 2 | 641227-2 |

SUPERCEDED
△

SUPERCEDED
△

SUPERCEDED
△

SUPERCEDED
△

| DIM A | NO OF CIRCUITS | PART NO |
|-------|----------------|---------|
| | | |

THIS DRAWING IS A CONTROLLED DOCUMENT.

| | | |
|------------------|-----------|-----------|
| DIM | ST. LEWIS | 12 FEB 91 |
| CHK | SWING | 12 FEB 91 |
| APPD | D. CLARK | 20 FEB 91 |
| PRODUCT SPEC | 108-1051 | |
| APPLICATION SPEC | 114-1020 | |
| WEIGHT | - | |

MATERIAL △ FINISH △

TE Connectivity
 MTA-156 CONNECTOR ASSEMBLY,
 18 AWG, STANDARD

SIZE CASE CODE DRAWING NO
 A2 00779 C-641227

RESTRICTED TO -
 CUSTOMER DRAWING SCALE 4:1 SHEET 1 of 1 REV Z1

D

C

B

A

641227

Z1