

4

3

2

1

THIS DRAWING IS UNPUBLISHED. RELEASED FOR PUBLICATION. ALL RIGHTS RESERVED.

LOC	DIST	REVISIONS			
F	LR	DESCRIPTION	DATE	BY	APPD
CM	00	R1	REVISED PER ECO-11-015731	03AUG11	HMR SM

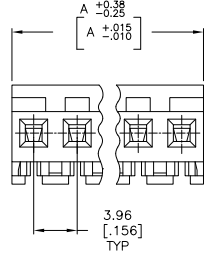
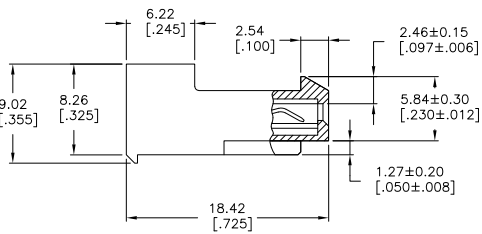
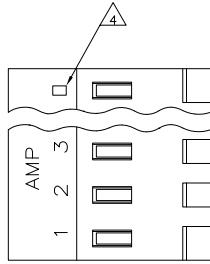

- 1 MATERIAL: CONNECTOR - NYLON UL94V-2 (YELLOW). CONTACTS - 0.00076[.000030] GOLD THK OR 0.00008[.000003] MIN THK GOLD FLASH OVER 0.00068[.000027] THK PALLADIUM NICKEL, PER TE CONNECTIVITY'S DISCRETION. IN CONTACT AREA WITH BRIGHT TIN-LEAD FOR 641218-2 THRU 2-641218-4, MATTE WHISKER MITIGATED TIN FOR 3-641218-2 THRU 5-641218-4 OVER NICKEL UNDERPLATE.
- 2. CONTACTS ACCEPT 20 AWG WIRE WITH 2.41[.095] MAX INSULATION DIAMETER.
- 3. CONTACTS MUST ACCEPT 1.14±0.03 [.045±.001] SQUARE POST AND REMAIN LOCKED IN POSITION.
- 4 IDENTIFICATION NUMBER FOR LAST CIRCUIT MAY NOT APPEAR ON ALL ASSEMBLIES.
- 5. DIMENSIONS IN BRACKETS ARE IN INCHES.
- 6. HOUSING FEATURES ARE: CLOSED END WITH LOCKING RAMP.
- 7 OBSOLETE PARTS: OBSOLETE CIS STREAMLINING PER D.RENAUD/D.SINISI

95.10	[3.744]	24	5-641218-4
91.14	[3.588]	23	5-641218-3
87.17	[3.432]	22	5-641218-2
83.21	[3.276]	21	5-641218-1
79.25	[3.120]	20	5-641218-0
75.29	[2.964]	19	4-641218-9
71.32	[2.808]	18	4-641218-8
67.36	[2.652]	17	4-641218-7
63.40	[2.496]	16	4-641218-6
59.44	[2.340]	15	4-641218-5
55.47	[2.184]	14	4-641218-4
51.51	[2.028]	13	4-641218-3
47.55	[1.872]	12	4-641218-2
43.59	[1.716]	11	4-641218-1
39.62	[1.560]	10	4-641218-0
35.66	[1.404]	9	3-641218-9
31.70	[1.248]	8	3-641218-8
27.74	[1.092]	7	3-641218-7
23.77	[.936]	6	3-641218-6
19.81	[.780]	5	3-641218-5
15.85	[.624]	4	3-641218-4
11.89	[.468]	3	3-641218-3
7.92	[.312]	2	3-641218-2
95.10	[3.744]	24	2-641218-4
91.14	[3.588]	23	2-641218-3
87.17	[3.432]	22	2-641218-2
83.21	[3.276]	21	2-641218-1
79.25	[3.120]	20	2-641218-0
75.29	[2.964]	19	1-641218-9
71.32	[2.808]	18	1-641218-8
67.36	[2.652]	17	1-641218-7
63.40	[2.496]	16	1-641218-6
59.44	[2.340]	15	1-641218-5
55.47	[2.184]	14	1-641218-4
51.51	[2.028]	13	1-641218-3
47.55	[1.872]	12	1-641218-2
43.59	[1.716]	11	1-641218-1
39.62	[1.560]	10	1-641218-0
35.66	[1.404]	9	641218-9
31.70	[1.248]	8	641218-8
27.74	[1.092]	7	641218-7
23.77	[.936]	6	641218-6
19.81	[.780]	5	641218-5
15.85	[.624]	4	641218-4
11.89	[.468]	3	641218-3
7.92	[.312]	2	641218-2

△	SUPERCEDED BY	DIM A	NO OF CIRCUITS	PART NO
△	5-641218-4	95.10	24	2-641218-4
△	5-641218-3	91.14	23	2-641218-3
△	5-641218-2	87.17	22	2-641218-2
△	5-641218-1	83.21	21	2-641218-1
△	5-641218-0	79.25	20	2-641218-0
△	4-641218-9	75.29	19	1-641218-9
△	4-641218-8	71.32	18	1-641218-8
△	4-641218-7	67.36	17	1-641218-7
△	4-641218-6	63.40	16	1-641218-6
△	4-641218-5	59.44	15	1-641218-5
△	4-641218-4	55.47	14	1-641218-4
△	4-641218-3	51.51	13	1-641218-3
△	4-641218-2	47.55	12	1-641218-2
△	4-641218-1	43.59	11	1-641218-1
△	3-641218-9	39.62	10	1-641218-0
△	3-641218-8	35.66	9	641218-9
△	3-641218-7	31.70	8	641218-8
△	3-641218-6	27.74	7	641218-7
△	3-641218-5	23.77	6	641218-6
△	3-641218-4	19.81	5	641218-5
△	3-641218-3	15.85	4	641218-4
△	3-641218-2	11.89	3	641218-3
△	3-641218-1	7.92	2	641218-2



THIS DRAWING IS A CONTROLLED DOCUMENT.

DIMENSIONS: mm [INCHES]	DESIGNER: S. LEWIS 12 FEB 91	CHK: R. SWING 12 FEB 91	APPROVED: D. CLARK 20 FEB 91	DATE: 12 FEB 91
0 P.L.C. -	1 P.L.C. -	2 P.L.C. -	3 P.L.C. -	4 P.L.C. -
ANGLES -	FINISH -	PRODUCT SPEC: 108-1051		APPLICATION SPEC: 114-1020
MATERIAL: △	FINISH: △	SIZE: A2	CAGE CODE: 00779	DRAWING NO: 641218
CUSTOMER DRAWING		SCALE: 4:1	SHEET: 1 of 1	REV: R1

TE Connectivity  
TE Connectivity  
MTA-156 CONNECTOR ASSEMBLY, 20 AWG, STANDARD