

THIS DRAWING IS UNPUBLISHED.  
 RELEASED FOR PUBLICATION  
 ALL RIGHTS RESERVED.

LOC	DIST	REVISIONS			
		REV	DESCRIPTION	DATE	BY
CM	54	R1	REVISED PER ECO-11-015731	03AUG11	HMR SM

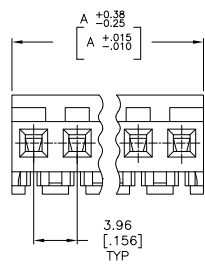
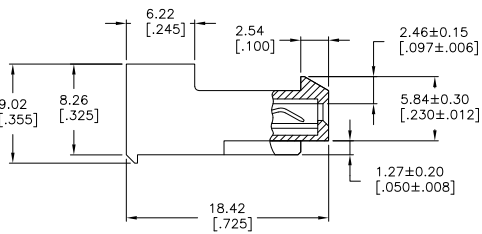
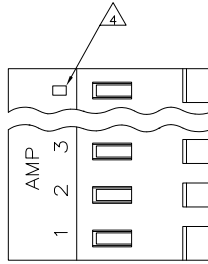

△ MATERIAL: CONNECTOR - NYLON UL94V-2 (RED).  
 CONTACTS - 0.30[.012] THICK COPPER ALLOY  
 0.00076[.000030] GOLD THK OR 0.00008[.000003] MIN THK  
 GOLD FLASH OVER 0.00068[.000027] THK PALLADIUM NICKEL,  
 PER TE CONNECTIVITY'S DISCRETION. IN CONTACT  
 AREA WITH BRIGHT TIN-LEAD FOR 641219-2  
 THRU 2-641219-4, MATTE WHISKER MITIGATED  
 TIN FOR 3-641219-2 THRU 5-641219-4  
 OVER NICKEL UNDERPLATE.

2. CONTACTS ACCEPT 22 AWG WIRE WITH 2.41[.095] MAX INSULATION DIAMETER.
3. CONTACTS MUST ACCEPT 1.14±0.03 [.045±.001] SQUARE POST AND REMAIN LOCKED IN POSITION.
- △ 4. IDENTIFICATION NUMBER FOR LAST CIRCUIT MAY NOT APPEAR ON ALL ASSEMBLIES.
5. DIMENSIONS IN BRACKETS ARE IN INCHES.
6. HOUSING FEATURES ARE: CLOSED END WITH LOCKING RAMP.
- △ OBSOLETE PARTS: OBSOLETE CIS STREAMLINING PER D.RENAUD/D.SINISI.

REV	DESCRIPTION	DATE	BY
95.10	[3.744]	24	5-641219-4
91.14	[3.588]	23	5-641219-3
87.17	[3.432]	22	5-641219-2
83.21	[3.276]	21	5-641219-1
79.25	[3.120]	20	5-641219-0
75.29	[2.964]	19	4-641219-9
71.32	[2.808]	18	4-641219-8
67.36	[2.652]	17	4-641219-7
63.40	[2.496]	16	4-641219-6
59.44	[2.340]	15	4-641219-5
55.47	[2.184]	14	4-641219-4
51.51	[2.028]	13	4-641219-3
47.55	[1.872]	12	4-641219-2
43.59	[1.716]	11	4-641219-1
39.62	[1.560]	10	4-641219-0
35.66	[1.404]	9	3-641219-9
31.70	[1.248]	8	3-641219-8
27.74	[1.092]	7	3-641219-7
23.77	[.936]	6	3-641219-6
19.81	[.780]	5	3-641219-5
15.85	[.624]	4	3-641219-4
11.89	[.468]	3	3-641219-3
7.92	[.312]	2	3-641219-2
<del>95.10</del>	<del>[3.744]</del>	<del>24</del>	<del>2-641219-4</del>
<del>91.14</del>	<del>[3.588]</del>	<del>23</del>	<del>2-641219-3</del>
<del>87.17</del>	<del>[3.432]</del>	<del>22</del>	<del>2-641219-2</del>
<del>83.21</del>	<del>[3.276]</del>	<del>21</del>	<del>2-641219-1</del>
<del>79.25</del>	<del>[3.120]</del>	<del>20</del>	<del>2-641219-0</del>
<del>75.29</del>	<del>[2.964]</del>	<del>19</del>	<del>1-641219-9</del>
<del>71.32</del>	<del>[2.808]</del>	<del>18</del>	<del>1-641219-8</del>
<del>67.36</del>	<del>[2.652]</del>	<del>17</del>	<del>1-641219-7</del>
<del>63.40</del>	<del>[2.496]</del>	<del>16</del>	<del>1-641219-6</del>
<del>59.44</del>	<del>[2.340]</del>	<del>15</del>	<del>1-641219-5</del>
<del>55.47</del>	<del>[2.184]</del>	<del>14</del>	<del>1-641219-4</del>
<del>51.51</del>	<del>[2.028]</del>	<del>13</del>	<del>1-641219-3</del>
<del>47.55</del>	<del>[1.872]</del>	<del>12</del>	<del>1-641219-2</del>
<del>43.59</del>	<del>[1.716]</del>	<del>11</del>	<del>1-641219-1</del>
<del>39.62</del>	<del>[1.560]</del>	<del>10</del>	<del>1-641219-0</del>
<del>35.66</del>	<del>[1.404]</del>	<del>9</del>	<del>641219-9</del>
<del>31.70</del>	<del>[1.248]</del>	<del>8</del>	<del>641219-8</del>
<del>27.74</del>	<del>[1.092]</del>	<del>7</del>	<del>641219-7</del>
<del>23.77</del>	<del>[.936]</del>	<del>6</del>	<del>641219-6</del>
<del>19.81</del>	<del>[.780]</del>	<del>5</del>	<del>641219-5</del>
<del>15.85</del>	<del>[.624]</del>	<del>4</del>	<del>641219-4</del>
<del>11.89</del>	<del>[.468]</del>	<del>3</del>	<del>641219-3</del>
<del>7.92</del>	<del>[.312]</del>	<del>2</del>	<del>641219-2</del>

THIS DRAWING IS A CONTROLLED DOCUMENT.

**METRIC**

DIMENSIONS mm [INCHES]	TOLERANCES UNLESS OTHERWISE SPECIFIED	DRN S. LEWIS 12 FEB 91	CHK R. SWING 12 FEB 91	APPD D. CLARK 20 FEB 91	NAME 108-1051
MATERIAL -△	FINISH -△	APPLICATION SPEC 114-1020	WEIGHT -	SIZE A2	CAGE CODE 00779
CUSTOMER DRAWING				DRAWING NO C=641219	RESTRICTED TO -

TE Connectivity  
 MTA-156 CONNECTOR ASSEMBLY,  
 22 AWG, STANDARD

SCALE: 4:1 SHEET 1 of 1 REV R1