

4

3

2

1

THIS DRAWING IS UNPUBLISHED. RELEASED FOR PUBLICATION. ALL RIGHTS RESERVED.

LOC	DIST	REVISIONS			
F	LNK	DESCRIPTION	DATE	BY	APPD
U1		REVISED PER ECO-11-015731	03AUG11	HMR	SM

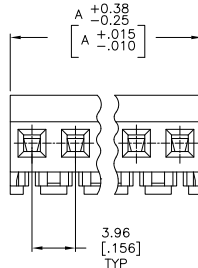
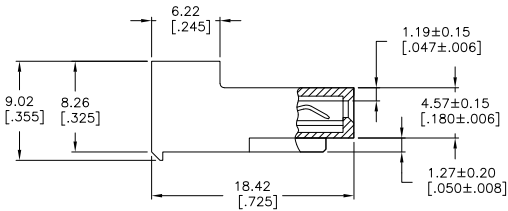
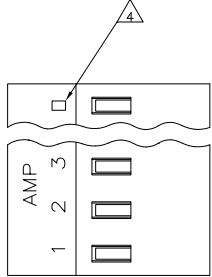

△ MATERIAL: CONNECTOR - NYLON UL94V-2 (ORANGE).
 CONTACTS - 0.00076[.000030] GOLD THK OR 0.00008[.000003] MIN THK GOLD FLASH OVER 0.00068[.000027] THK PALLADIUM NICKEL, PER TE CONNECTIVITY'S DISCRETION. IN CONTACT AREA WITH BRIGHT TIN-LEAD FOR -2 THRU -28, MATTE WHISKER MITIGATED TIN FOR 3-641222-2 THRU 5-641222-4 OVER NICKEL UNDERPLATE.

- CONTACTS ACCEPT 18 AWG WIRE WITH 2.41[.095] MAX INSULATION DIAMETER.
- CONTACTS MUST ACCEPT 1.14±0.03 [.045±.001] SQUARE POST AND REMAIN LOCKED IN POSITION.
- IDENTIFICATION NUMBER FOR LAST CIRCUIT MAY NOT APPEAR ON ALL ASSEMBLIES.
- DIMENSIONS IN BRACKETS ARE IN INCHES.
- HOUSING FEATURES ARE: CLOSED END WITHOUT LOCKING RAMP.
- OBsolete PARTS: OBsolete CIS STREAMLINING PER D.RENAUD/D.SINISI

95.10	[3.744]	24	5-641222-4	
91.14	[3.588]	23	5-641222-3	
87.17	[3.432]	22	5-641222-2	
83.21	[3.276]	21	5-641222-1	
79.25	[3.120]	20	5-641222-0	
75.29	[2.964]	19	4-641222-9	
71.32	[2.808]	18	4-641222-8	
67.36	[2.652]	17	4-641222-7	
63.40	[2.496]	16	4-641222-6	
59.44	[2.340]	15	4-641222-5	
55.47	[2.184]	14	4-641222-4	
51.51	[2.028]	13	4-641222-3	
47.55	[1.872]	12	4-641222-2	
43.59	[1.716]	11	4-641222-1	
39.62	[1.560]	10	4-641222-0	
35.66	[1.404]	9	3-641222-9	
31.70	[1.248]	8	3-641222-8	
27.74	[1.092]	7	3-641222-7	
23.77	[.936]	6	3-641222-6	
19.81	[.780]	5	3-641222-5	
15.85	[.624]	4	3-641222-4	
11.89	[.468]	3	3-641222-3	
7.92	[.312]	2	3-641222-2	
△ SUPERSEDED BY 5-641222-4	95.10	[3.744]	24	-2-641222-4
△ SUPERSEDED BY 5-641222-3	91.14	[3.588]	23	-2-641222-3
△ SUPERSEDED BY 5-641222-1	87.17	[3.432]	22	-2-641222-2
△ SUPERSEDED BY 5-641222-0	83.21	[3.276]	21	-2-641222-1
△ SUPERSEDED BY 4-641222-9	79.25	[3.120]	20	-2-641222-0
△ SUPERSEDED BY 4-641222-8	75.29	[2.964]	19	-1-641222-9
△ SUPERSEDED BY 4-641222-7	71.32	[2.808]	18	-1-641222-8
△ SUPERSEDED BY 4-641222-6	67.36	[2.652]	17	-1-641222-7
△ SUPERSEDED BY 4-641222-5	63.40	[2.496]	16	-1-641222-6
△ SUPERSEDED BY 4-641222-4	59.44	[2.340]	15	-1-641222-5
△ SUPERSEDED BY 4-641222-3	55.47	[2.184]	14	-1-641222-4
△ SUPERSEDED BY 4-641222-2	51.51	[2.028]	13	-1-641222-3
△ SUPERSEDED BY 4-641222-1	47.55	[1.872]	12	-1-641222-2
△ SUPERSEDED BY 4-641222-0	43.59	[1.716]	11	-1-641222-1
△ SUPERSEDED BY 3-641222-9	39.62	[1.560]	10	-1-641222-0
△ SUPERSEDED BY 3-641222-8	35.66	[1.404]	9	-641222-9
△ SUPERSEDED BY 3-641222-7	31.70	[1.248]	8	-641222-8
△ SUPERSEDED BY 3-641222-6	27.74	[1.092]	7	-641222-7
△ SUPERSEDED BY 3-641222-5	23.77	[.936]	6	-641222-6
△ SUPERSEDED BY 3-641222-4	19.81	[.780]	5	-641222-5
△ SUPERSEDED BY 3-641222-3	15.85	[.624]	4	-641222-4
△ SUPERSEDED BY 3-641222-2	11.89	[.468]	3	-641222-3
△ SUPERSEDED BY 3-641222-1	7.92	[.312]	2	-641222-2

THIS DRAWING IS A CONTROLLED DOCUMENT.

DIMENSIONS: mm [INCHES]	TOLERANCES UNLESS OTHERWISE SPECIFIED:	DRW: S. LEWIS 12 FEB 91	CHK: R. SWING 12 FEB 91	APPRO: D. CLARK 21 FEB 91	DATE: 12 FEB 91	NAME: MTA-156 CONNECTOR ASSEMBLY, 18 AWG, STANDARD
0 PLC ± .01	1 PLC ± .005	2 PLC ± .002	3 PLC ± .001	4 PLC ± .0005	5 PLC ± .0002	RESTRICTED TO: -
MATERIAL: NYLON	FINISH: POLISHED	APPLICATION SPEC: 114-1020	WEIGHT: -	SIZE: A2	ONE CODE: 00779	DRAWING NO: C-641222
CUSTOMER DRAWING			SCALE: 4:1	SHEET: 1 of 1	REV: U1	

