

4

3

2

1

THIS DRAWING IS UNPUBLISHED. RELEASED FOR PUBLICATION. ALL RIGHTS RESERVED.

LOC	DIST	REVISIONS			
F	LR	DESCRIPTION	DATE	BY	APPD
CM	00				
	S2	REVISED PER ECO-11-004587	11MAR11	RK	HMR

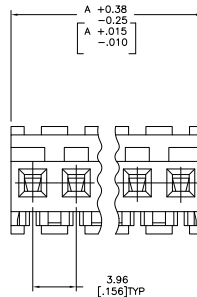
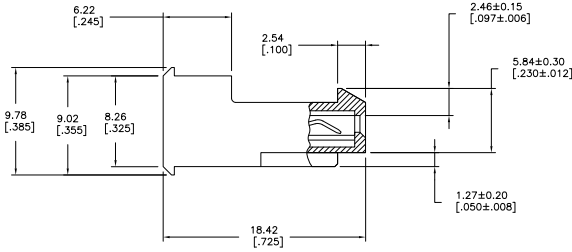
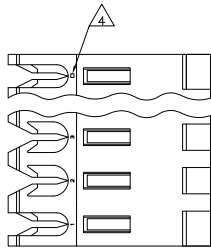

- △ MATERIAL: CONNECTOR - NYLON UL94-V2 (ORANGE)
CONTACTS - 0.30[.012] THICK COPPER ALLOY
(BRIGHT TIN-LEAD 0.00203[.000080] MIN. THICK
FOR CONTACTS 640599-2 THRU 2-640599-4)
(MATTE WHISKER MITGATED TIN 0.00203[.000080] MIN
THICKNESS OVER NICKEL UNDERPLATE FOR
3-640599-2 THRU 5-640599-4).
- 2. CONTACTS ACCEPT 18 AWG WIRE WITH 2.41[.095] MAX INSULATION DIAMETER.
- 3. CONTACTS MUST ACCEPT 1.14±0.03[.045±.001] SQUARE POST AND REMAIN LOCKED IN POSITION.
- △ IDENTIFICATION NUMBER FOR LAST CIRCUIT MAY NOT APPEAR ON ALL ASSEMBLIES.
- 5. DIMENSIONS IN BRACKETS ARE IN INCHES.
- 6. HOUSING FEATURES ARE: FEED-THRU WITH LOCKING RAMP.
- △ OBSOLETE PARTS: OBSOLETE CIS STREAMLINING PER D.RENAUD/D.SINISI

95.10[3.744]	24	5-640599-4		
91.13[3.588]	23	5-640599-3		
87.17[3.432]	22	5-640599-2		
83.21[3.276]	21	5-640599-1		
79.25[3.120]	20	5-640599-0		
75.29[2.964]	19	4-640599-9		
71.32[2.808]	18	4-640599-8		
67.36[2.652]	17	4-640599-7		
63.40[2.496]	16	4-640599-6		
59.44[2.340]	15	4-640599-5		
55.47[2.184]	14	4-640599-4		
51.51[2.028]	13	4-640599-3		
47.55[1.872]	12	4-640599-2		
43.59[1.716]	11	4-640599-1		
39.62[1.560]	10	4-640599-0		
35.66[1.404]	9	3-640599-9		
31.70[1.248]	8	3-640599-8		
27.74[1.092]	7	3-640599-7		
23.77[.936]	6	3-640599-6		
19.81[.780]	5	3-640599-5		
15.85[.624]	4	3-640599-4		
11.89[.468]	3	3-640599-3		
7.92[.312]	2	3-640599-2		
△ SUPERSEDED BY 5-640599-4	95.10[3.744]	24	2-640699-4	
△ SUPERSEDED BY 5-640599-3	91.13[3.588]	23	2-640699-3	
△ SUPERSEDED BY 5-640599-2	87.17[3.432]	22	2-640699-2	
△ SUPERSEDED BY 5-640599-1	83.21[3.276]	21	2-640699-1	
△ SUPERSEDED BY 5-640599-0	79.25[3.120]	20	2-640699-0	
△ SUPERSEDED BY 4-640599-9	75.29[2.964]	19	1-640599-9	
	71.32[2.808]	18	1-640599-8	
	67.36[2.652]	17	1-640599-7	
	63.40[2.496]	16	1-640599-6	
	59.44[2.340]	15	1-640599-5	
△ SUPERSEDED BY 4-640599-4	55.47[2.184]	14	1-640599-4	
	51.51[2.028]	13	1-640599-3	
	47.55[1.872]	12	1-640599-2	
	43.59[1.716]	11	1-640599-1	
	39.62[1.560]	10	1-640599-0	
	35.66[1.404]	9	640599-9	
	31.70[1.248]	8	640599-8	
	27.74[1.092]	7	640599-7	
	23.77[.936]	6	640599-6	
	19.81[.780]	5	640599-5	
	15.85[.624]	4	640599-4	
	11.89[.468]	3	640599-3	
	7.92[.312]	2	640599-2	
			NO OF PART NO.	
			DIM A	CIRCUITS



THIS DRAWING IS A CONTROLLED DOCUMENT.

DIMENSIONS: mm [INCHES]	0 PLG ± . -	1 PLG ± . -	2 PLG ± . -	3 PLG ± 0.13 [005]	4 PLG ± . -	ANGLES ± . -	FINISH
	△						

DRN: S. CARPENTER 09AIA2003	CHK: D. BOSSI 09AIA2003	APPD: D. BOSSI 09AIA2003	NAME: PRODUCT SPEC: 108-1051
APPLICATION SPEC: 114-1020	WEIGHT: -	SIZE: A2	ONE CODE: 00779
CUSTOMER DRAWING	SCALE: 4:1	SHEET: 1 of 1	REV: S2

TE Connectivity
TE Connectivity
MTA-156 CONNECTOR ASSEMBLY,
18 AWG, STANDARD

640599

A