

4

3

2

1

THIS DRAWING IS UNPUBLISHED. RELEASED FOR PUBLICATION
 © COPYRIGHT - BY TYCO ELECTRONICS CORPORATION. ALL RIGHTS RESERVED.

LOC	DIST	REVISIONS			
P	LTR	DESCRIPTION	DATE	DWN	APVD
DW	-	RELEASED	09FEB07	HH	WK

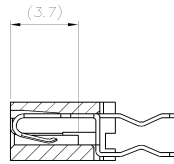
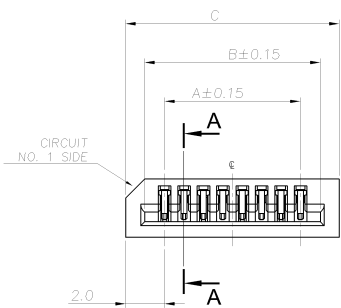

SECTION A-A

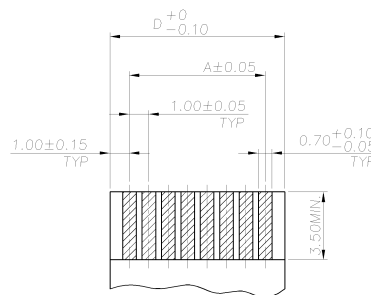

RECOMMENDED FPC/FFC LAYOUT (THICKNESS=0.30±0.05)

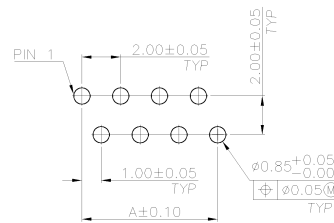
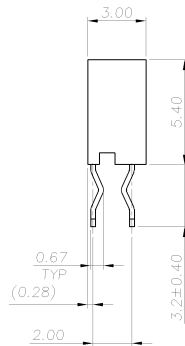
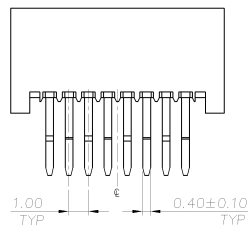

RECOMMENDED PCB LAYOUT TYPE B (THICKNESS=1.60)

0.74g	31.00	33.0	31.05	29.0	30	3-1734029-0
0.72g	30.00	32.0	30.05	28.0	29	2-1734029-9
0.69g	29.00	31.0	29.05	27.0	28	2-1734029-8
0.67g	28.00	30.0	28.05	26.0	27	2-1734029-7
0.65g	27.00	29.0	27.05	25.0	26	2-1734029-6
0.63g	26.00	28.0	26.05	24.0	25	2-1734029-5
0.60g	25.00	27.0	25.05	23.0	24	2-1734029-4
0.58g	24.00	26.0	24.05	22.0	23	2-1734029-3
0.56g	23.00	25.0	23.05	21.0	22	2-1734029-2
0.53g	22.00	24.0	22.05	20.0	21	2-1734029-1
0.51g	21.00	23.0	21.05	19.0	20	2-1734029-0
0.49g	20.00	22.0	20.05	18.0	19	1-1734029-9
0.47g	19.00	21.0	19.05	17.0	18	1-1734029-8
0.44g	18.00	20.0	18.05	16.0	17	1-1734029-7
0.42g	17.00	19.0	17.05	15.0	16	1-1734029-6
0.40g	16.00	18.0	16.05	14.0	15	1-1734029-5
0.38g	15.00	17.0	15.05	13.0	14	1-1734029-4
0.35g	14.00	16.0	14.05	12.0	13	1-1734029-3
0.33g	13.00	15.0	13.05	11.0	12	1-1734029-2
0.31g	12.00	14.0	12.05	10.0	11	1-1734029-1
0.29g	11.00	13.0	11.05	9.0	10	1-1734029-0
0.26g	10.00	12.0	10.05	8.0	9	1734029-9
0.24g	9.00	11.0	9.05	7.0	8	1734029-8
0.22g	8.00	10.0	8.05	6.0	7	1734029-7
0.20g	7.00	9.0	7.05	5.0	6	1734029-6
0.17g	6.00	8.0	6.05	4.0	5	1734029-5
0.15g	5.00	7.0	5.05	3.0	4	1734029-4

NOTE:

- MATERIAL:
HOUSING: THERMOPLASTIC (PA9T) WITH 33% GF, UL 94V-0, BLACK COLOR.
CONTACTS: PHOSPHOR BRONZE.
- FINISH:
CONTACTS: 2.54µm [100µ'] MIN. MATTE-TIN OVER 1.27µm [50µ'] MIN. NICKEL UNDERPLATED ON ENTIRE CONTACT.
- WAVE SOLDER CAPABLE TO 265°C PER TYCO TEST SPEC. 109-202, CONDITION B.

THIS DRAWING IS A CONTROLLED DOCUMENT.

DIMENSIONS:	TOLERANCES UNLESS OTHERWISE SPECIFIED:
MM	
0 PLC	± 0.5
1 PLC	± 0.38
2 PLC	± 0.25
3 PLC	± 0.15
4 PLC	± -
ANGLES	± -

DWN	CHK	APVD
H. HUANG	S. HOU	W. J. KE

09FEB2007	09FEB2007	09FEB2007
PRODUCT SPEC		
108-57354		
QUALIFICATION TEST REPORT		
501-57449		
WEIGHT SEE TABLE		
CUSTOMER DRAWING		

tyco Tyco Holdings (Bermuda)
Electronics VII Ltd. Taiwan Branch

FPC/FFC CONNECTOR, 1.0 PITCH, NON-ZIF, VERTICAL, TOP CONTACT, DIP TYPE

SIZE: A3 CAGE CODE: 00779 DRAWING NO: 1734029 RESTRICTED TO: -

SCALE: - SHEET: 1 OF 2 REV: A

4

3

2

1

THIS DRAWING IS UNPUBLISHED. RELEASED FOR PUBLICATION
 © COPYRIGHT - BY TYCO ELECTRONICS CORPORATION. ALL RIGHTS RESERVED.

LOC	DIST	REVISIONS			
P	LTR	DESCRIPTION	DATE	DWN	APVD
SEE SHEET 1.					

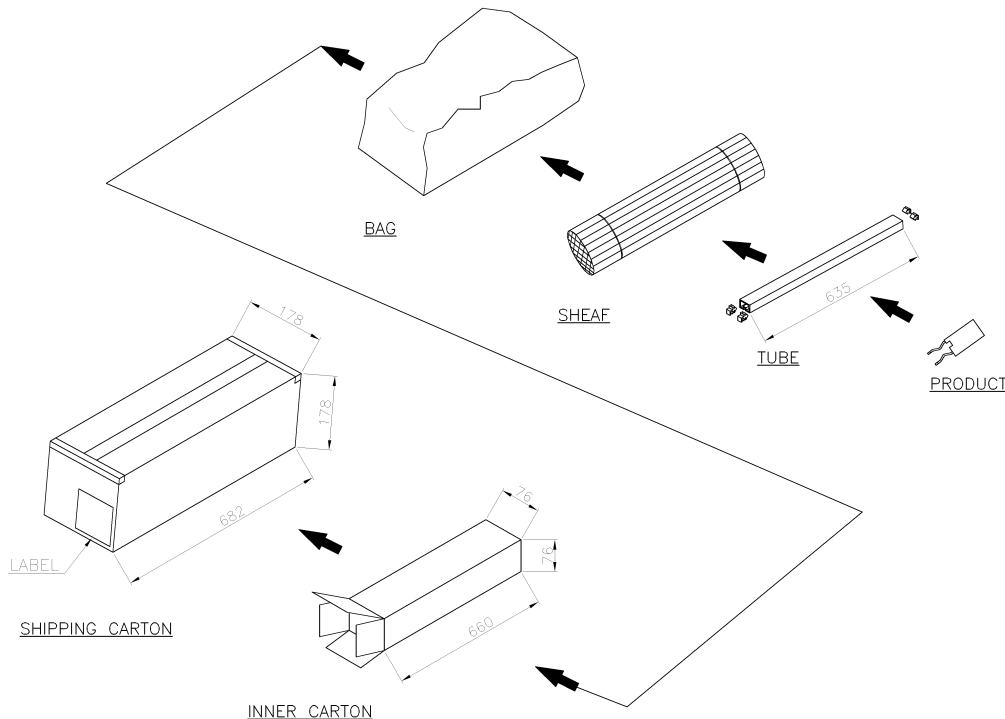

GROSS WEIGHT	NET WEIGHT	PCS/TUBE	TUBES / CARTON	QUANTITY	NO. OF POS.
8.80 Kg	3.20 Kg	18	240	4320 PCS	30
8.71 Kg	3.11 Kg	18	240	4320 PCS	29
8.75 Kg	3.15 Kg	19	240	4560 PCS	28
8.82 Kg	3.22 Kg	20	240	4800 PCS	27
8.72 Kg	3.12 Kg	20	240	4800 PCS	26
8.78 Kg	3.18 Kg	21	240	5040 PCS	25
8.77 Kg	3.17 Kg	22	240	5280 PCS	24
8.80 Kg	3.20 Kg	23	240	5520 PCS	23
8.83 Kg	3.23 Kg	24	240	5760 PCS	22
8.78 Kg	3.18 Kg	25	240	6000 PCS	21
8.78 Kg	3.18 Kg	26	240	6240 PCS	20
8.79 Kg	3.18 Kg	27	240	6480 PCS	19
8.76 Kg	3.16 Kg	28	240	6720 PCS	18
8.77 Kg	3.17 Kg	30	240	7200 PCS	17
8.72 Kg	3.12 Kg	31	240	7440 PCS	16
8.77 Kg	3.17 Kg	33	240	7920 PCS	15
8.79 Kg	3.19 Kg	35	240	8400 PCS	14
8.71 Kg	3.11 Kg	37	240	8880 PCS	13
8.77 Kg	3.17 Kg	40	240	9600 PCS	12
8.80 Kg	3.20 Kg	43	240	10320 PCS	11
8.80 Kg	3.21 Kg	46	240	11040 PCS	10
8.72 Kg	3.12 Kg	50	240	12000 PCS	09
8.77 Kg	3.17 Kg	55	240	13200 PCS	08
8.77 Kg	3.17 Kg	60	240	14400 PCS	07
8.82 Kg	3.22 Kg	67	240	16080 PCS	06
8.66 Kg	3.06 Kg	75	240	18000 PCS	05
8.70 Kg	3.10 Kg	86	240	20640 PCS	04

THIS DRAWING IS A CONTROLLED DOCUMENT.

DIMENSIONS: MM	TOLERANCES UNLESS OTHERWISE SPECIFIED:	DWN H. HUANG 09FEB2007	tyco Electronics Tyco Holdings (Bermuda) VII Ltd. Taiwan Branch
	0 PLC ± -	CHK S. HOU 09FEB2007	
	1 PLC ± -	APVD W.J. KE 09FEB2007	
	2 PLC ± -	NAME	
MATERIAL	FINISH	PRODUCT SPEC	FPC/FFC CONNECTOR, 1.0 PITCH, NON-ZIF, VERTICAL, TOP CONTACT, DIP TYPE
CUSTOMER DRAWING		APPLICATION SPEC	RESTRICTED TO
		WEIGHT	SIZE A3 CAGE CODE 00779 DRAWING NO 1734029
		SCALE - SHEET 2 OF 2 REV A	