

THIS DRAWING IS UNPUBLISHED
 ALL RIGHTS RESERVED

REV	DATE	DESCRIPTION	BY	APP
00				
L		REVISED PER EDD-11-013373		15ML11 HMR SM

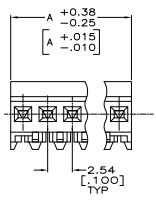
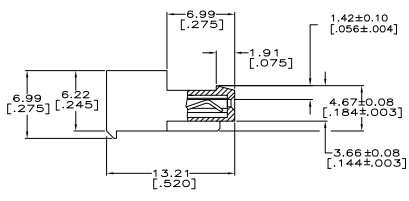
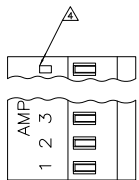

- △ MATERIAL: CONNECTOR-NYLON UL94V-2 (GREEN).
 CONTACTS-0.30 [.012] THICK COPPER ALLOY
 0.00076 [.000030] GOLD OR 0.00076[.000030]
 TOTAL GOLD FLASH OVER PALLADIUM NICKEL.
 PER TE CONNECTIVITY'S DISCRETION, IN
 CONTACT AREA WITH BRIGHT TIN-LEAD
 FOR 641240-2 THRU 2-641240-B, MATTE
 WHISKER MITIGATED TIN FOR 3-641240-2
 THRU 5-641240-8 OVER NICKEL UNDERPLATE.
- CONTACTS ACCEPT 28 AWG WIRE WITH 1.52 [.060] MAX INSULATION DIAMETER.
 - CONTACTS MUST ACCEPT 0.64±0.03 [.025±.001] SQUARE POST AND REMAIN LOCKED IN POSITION.
 - IDENTIFICATION NUMBER FOR LAST CIRCUIT MAY NOT APPEAR ON ALL ASSEMBLIES.
 - DIMENSIONS IN BRACKETS ARE IN INCHES.
 - HOUSING FEATURES ARE: CLOSED END WITH LOCKING RAMP.
 - OBsolete PARTS: OBsolete CIS STREAMLINING PER D.RENAUD/D.SINISI

DIM A	NO. OF POSN	ASSEMBLY
71.12 [2.800]	28	5-641240-8
68.58 [2.700]	27	5-641240-7
66.04 [2.600]	26	5-641240-6
63.50 [2.500]	25	5-641240-5
60.96 [2.400]	24	5-641240-4
58.42 [2.300]	23	5-641240-3
55.88 [2.200]	22	5-641240-2
53.34 [2.100]	21	5-641240-1
50.80 [2.000]	20	5-641240-0
48.26 [1.900]	19	4-641240-9
45.72 [1.800]	18	4-641240-8
43.18 [1.700]	17	4-641240-7
40.64 [1.600]	16	4-641240-6
38.10 [1.500]	15	4-641240-5
35.56 [1.400]	14	4-641240-4
33.02 [1.300]	13	4-641240-3
30.48 [1.200]	12	4-641240-2
27.94 [1.100]	11	4-641240-1
25.40 [1.000]	10	4-641240-0
22.86 [.900]	9	3-641240-9
20.32 [.800]	8	3-641240-8
17.78 [.700]	7	3-641240-7
15.24 [.600]	6	3-641240-6
12.70 [.500]	5	3-641240-5
10.16 [.400]	4	3-641240-4
7.62 [.300]	3	3-641240-3
5.08 [.200]	2	3-641240-2

DIM A	NO. OF POSN	ASSEMBLY
71.12 [2.800]	28	2-641240-8
68.58 [2.700]	27	2-641240-7
66.04 [2.600]	26	2-641240-6
63.50 [2.500]	25	2-641240-5
60.96 [2.400]	24	2-641240-4
58.42 [2.300]	23	2-641240-3
55.88 [2.200]	22	2-641240-2
53.34 [2.100]	21	2-641240-1
50.80 [2.000]	20	2-641240-0
48.26 [1.900]	19	1-641240-9
45.72 [1.800]	18	1-641240-8
43.18 [1.700]	17	1-641240-7
40.64 [1.600]	16	1-641240-6
38.10 [1.500]	15	1-641240-5
35.56 [1.400]	14	1-641240-4
33.02 [1.300]	13	1-641240-3
30.48 [1.200]	12	1-641240-2
27.94 [1.100]	11	1-641240-1
25.40 [1.000]	10	1-641240-0
22.86 [.900]	9	641240-9
20.32 [.800]	8	641240-8
17.78 [.700]	7	641240-7
15.24 [.600]	6	641240-6
12.70 [.500]	5	641240-5
10.16 [.400]	4	641240-4
7.62 [.300]	3	641240-3
5.08 [.200]	2	641240-2

SUPERCEDED
 CONTAINS LEAD
 SUPERCEDED



THIS DRAWING IS A CONTROLLED DOCUMENT.

DESIGNER	DR	DATE	REVISED
BY	DATE	BY	DATE
108-1050			
114-1019			

TE Connectivity
 MTA .100 CONNECTOR ASSEMBLY
 28 AWG, STANDARD

CUSTOMER DRAWING