

4

3

2

1

THIS DRAWING IS UNPUBLISHED. RELEASED FOR PUBLICATION. ALL RIGHTS RESERVED.

LOC	DIST	REVISIONS			
P	LTR	DESCRIPTION	DATE	BY	APPD
CM	00				
		AB4	REVISED PER ECO-11-020968	18OCT11	JR SM

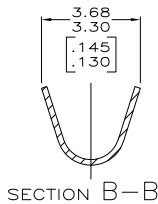
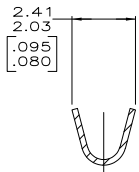
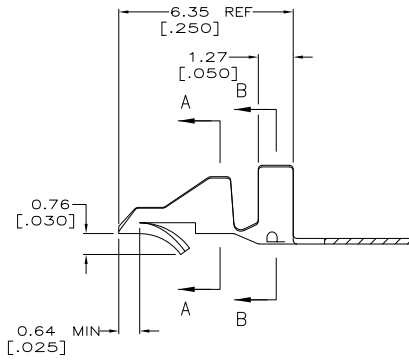
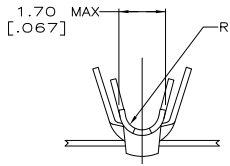
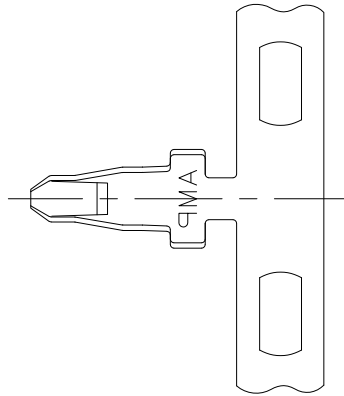
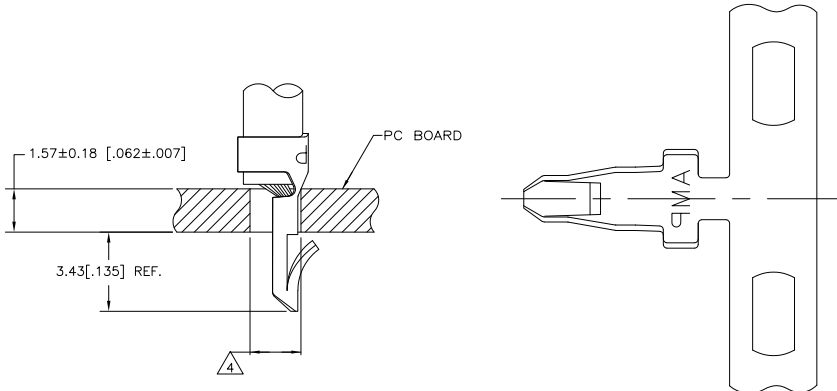

METRIC

- 1 PARTS COMPLY WITH AMP SOLDERABILITY SPEC 109-11-3.
- 2 PARTS COMPLY WITH AMP SOLDERABILITY SPEC 109-11-5.
- 3 PARTS COMPLY WITH AMP SOLDERABILITY SPEC 109-11-1.
- 4 HOLE DIAMETER TO BE 1.83±0.08 FOR WIRE 0.3-0.6mm² (20-22 AWG) OR 1.96±0.08 FOR WIRE 0.8-0.9mm² (18 AWG).
- 5 CARRIER STRIP TO HAVE 1.52 [.060] DIA PILOT HOLE.
- 6 0.00508 [.000200] MIN BRIGHT TIN-LEAD.
- 7 0.00318 [.000150] MIN MATTE TIN-LEAD OVER
0.00305 [.000120] MIN MATTE COPPER.
- 8 0.00305 [.000120] MIN TIN OVER
0.00102 [.000040] MIN NICKEL.
- 9 WIRE RANGE: 0.3 - 0.9 mm² (22 - 18 AWG).
- 10 INSULATION RANGE: 1.52 - 2.79 [.060 - .110] DIA.
- 11 DIMENSIONS IN BRACKETS ARE IN INCHES.
- 12 0.00508 [.000200] MIN BRIGHT TIN.

1	12	0.20[.008] PH BRZ	3-350566-1
3	5	0.20[.008] BRASS	350566-7
3	8	0.20[.008] BRASS	350566-5
2	8	0.20[.008] BRASS	350566-3
1	6	0.20[.008] PH BRZ	350566-1
NOTES		FINISH	MATERIAL
			PART NO.

DIMENSIONS:		OTHER DIMENSIONS:		APPLIC. SPEC:		SIZE		CASE CODE		DRAWING NO.		RESTRICTED TO	
INCHES		OTHER DIMENSIONS:		114-1016		A2		00779		C-350566		-	
SEE TABLE		SEE TABLE		CUSTOMER DRAWING		SCALE		10:1		SHEET		1 of 1	

TE Connectivity

MINI AMP-IN (TM)