

4

3

2

1

THIS DRAWING IS UNPUBLISHED. RELEASED FOR PUBLICATION
 © COPYRIGHT - By - ALL RIGHTS RESERVED. DIN 46247

LOC	DIST	REVISIONS			
P	LTR	DESCRIPTION	DATE	DWN	APVD
E97-9621	F3	REVISED PER ECO-11-005150	21MAR11	RK	HMR

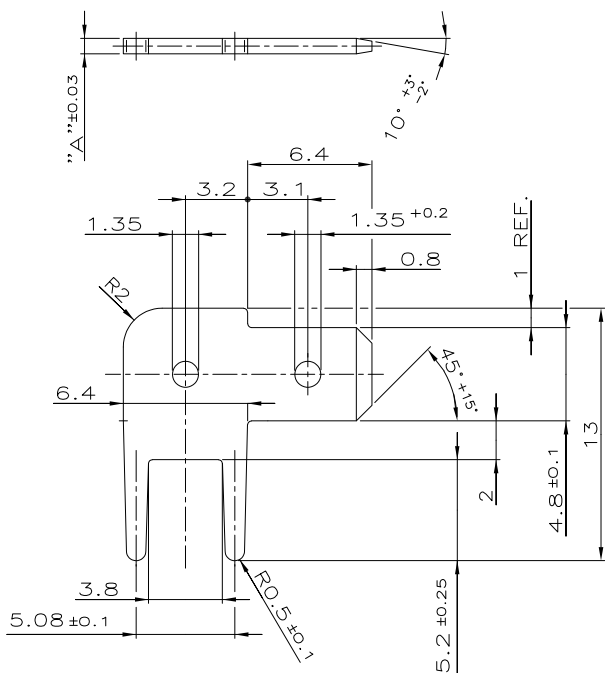

- ① MIN. 4.5 μm Sn OVER MIN. 2.5 μm Cu
- ② MIN. 3 μm Sn OVER MIN. 0.8 μm Ni
- ③ PACKING: MAX. 3000 PIECES
PACKED INTO CARDBOARD BOX
- ④ RECOMMENDED DIA. FOR PCB: Ø1.4 -0.1
- ⑤ OBSOLETE PARTS: OBSOLETE CIS STREAMLINING PER D.RENAUD/D.SINISI
- ① MIN. 4.5 μm Sn ÜBER MIN. 2.5 μm Cu
- ② MIN. 3 μm Sn ÜBER MIN. 0.8 μm Ni
- ③ VERPACKUNG: MAX. 3000 TEILE
IN KARTON VERPACKT
- ④ EMPFOHLENE LEITERPLATTENBOHRUNG: Ø1.4 -0.1

⑤ OBSOLETE	0.8	1-726389-4	②	CuZn
	0.8	1-726389-3	MIN. 2 μm Ni	CuZn
⑤ OBSOLETE	0.8	1-726389-2	①	CuZn
	0.8	1-726389-1	PLAIN BLANK	CuZn
⑤ OBSOLETE	0.5	726389-3	MIN. 2 μm Ni	CuZn
	0.5	726389-2	①	CuZn
⑤ OBSOLETE	0.5	726389-1	PLAIN BLANK	CuZn
"A"	DIMENSION MASS	ORDER NO. BESTELL-NR.	SURFACE OBERFLAECHE COLOUR/FARBE	MATERIAL

THIS DRAWING IS A CONTROLLED DOCUMENT.

DIMENSIONS: mm	TOLERANCES UNLESS OTHERWISE SPECIFIED:	DWN WEITZEL 28-MAY-85	TE Connectivity FASTON TAB 4.8 FLACHSTECKER 4.8	
	0 PLC ± - 1 PLC ± 0.2 2 PLC ± - 3 PLC ± - 4 PLC ± - ANGLES ± -	CHK PFEIFER 28-MAY-85		
MATERIAL	FINISH	APVD MORITZ 02-JUL-85	NAME	RESTRICTED TO
SEE TABLE SIEHE TABELLE	SEE TABLE SIEHE TABELLE	PRODUCT SPEC ACCORDING TO DIN 46244	SIZE A3	CAGE CODE 00779
		APPLICATION SPEC	DRAWING NO C-726389	REV F3
		WEIGHT	CUSTOMER DRAWING	SCALE 5:1
				SHEET 1 OF 1