

4

3

2

1

THIS DRAWING IS UNPUBLISHED. RELEASED FOR PUBLICATION. ALL RIGHTS RESERVED.

© COPYRIGHT - By -

LOC	DIST	REVISIONS			
P	LTR	DESCRIPTION	DATE	DWN	APVD
D1		ECR-10-000262	19APR2010	SRE	PCH
D2		ECR-10-026537	22JAN11	KK	HMR

TE LOGO

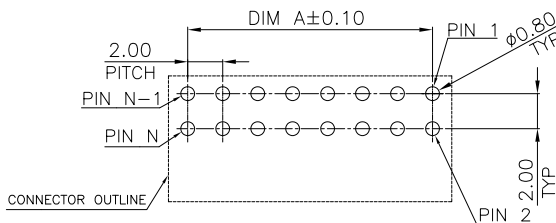
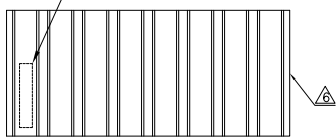

RECOMMENDED PCB LAYOUT
TOLERANCE ± 0.05 (TOP VIEW)

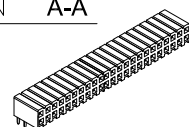
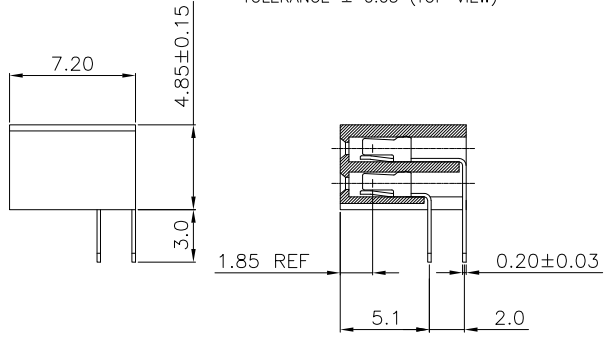
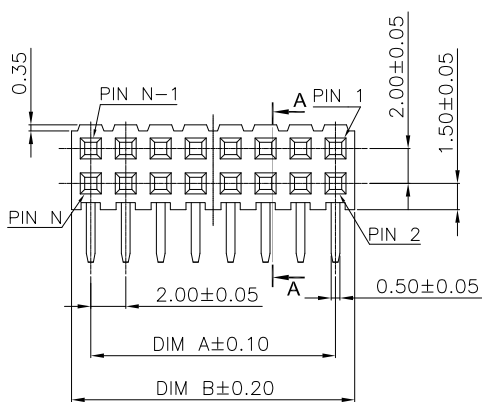

OBSOLETE	78.00	80.20	80	8	-0
	76.00	78.20	78	7	-8
	74.00	76.20	76	7	-6
	72.00	74.20	74	7	-4
	70.00	72.20	72	7	-2
	68.00	70.20	70	7	-0
	66.00	68.20	68	6	-8
	64.00	66.20	66	6	-6
	62.00	64.20	64	6	-4
	60.00	62.20	62	6	-2
	58.00	60.20	60	6	-0
	56.00	58.20	58	5	-8
	54.00	56.20	56	5	-6
	52.00	54.20	54	5	-4
OBSOLETE	50.00	52.20	52	5	-2
	48.00	50.20	50	5	-0
	46.00	48.20	48	4	-8
	44.00	46.20	46	4	-6
	42.00	44.20	44	4	-4
	40.00	42.20	42	4	-2
	38.00	40.20	40	4	-0
	36.00	38.20	38	3	-8
OBSOLETE	34.00	36.20	36	3	-6
	32.00	34.20	34	3	-4
	30.00	32.20	32	3	-2
	28.00	30.20	30	3	-0
OBSOLETE	26.00	28.20	28	2	-8
	24.00	26.20	26	2	-6
	22.00	24.20	24	2	-4
	20.00	22.20	22	2	-2
	18.00	20.20	20	2	-0
OBSOLETE	16.00	18.20	18	1	-8
	14.00	16.20	16	1	-6
	12.00	14.20	14	1	-4
	10.00	12.20	12	1	-2
OBSOLETE	8.00	10.20	10	1	-0
OBSOLETE	6.00	8.20	8		1734531-8
	4.00	6.20	6		1734531-6
	2.00	4.20	4		1734531-4
	DIM A	DIM B	POSITION NUMBER	PART NUMBER	

- NOTE :
- 1 MATERIAL : HOUSING : THERMOPLASTIC, UL94V-0, BLACK COLOR CONTACT : PHOSPHOR BRONZE, THICKNESS=0.20mm.
 - 2 FINISH : CONTACT: 0.254mm [10m"] MIN. GOLD PLATED ON CONTACT AREA 2.54mm [100m"] MIN. BRIGHT TIN PLATED ON SOLDER TAIL, 1.27mm [50m"] MIN. NICKEL UNDERPLATED OVER ALL
 - 3. APPLICATION : SOLDER TAIL LENGTH 2.6 FOR PCB THICKNESS 1.6±0.1
 - 4. WAVE SOLDER CAPABLE TO 265°C PER TE SPEC 109-202, CONDITION B
 - 5 NO CUMULATIVE TOLERANCE
 - 6 DATECODE: YY WW D * ASS'Y LINE NO. DAY WEEK CODE YEAR
 - 7. QUALIFICATION TEST REPORT: 501-57197

THIS DRAWING IS A CONTROLLED DOCUMENT.

DIMENSIONS: mm	TOLERANCES UNLESS OTHERWISE SPECIFIED:	DWN O.HU 05.JUL.2005	TE Connectivity AMPMODU 2.0mm PITCH, RCPT CONN., RIGHT-ANGLE, MOUNT TYPE
0 PLC ± 0.5	1 PLC ± 0.2	CHK S.HOU 05.JUL.2005	
2 PLC ± 0.1	3 PLC ± 0.05	APVD W.J.KE 05.JUL.2005	
4 PLC ± - ± 3°			
MATERIAL	FINISH	NAME	SIZE CAGE CODE DRAWING NO RESTRICTED TO
		PRODUCT SPEC	A3 00779 C-1734531
		APPLICATION SPEC	108-57197
		WEIGHT	CUSTOMER DRAWING
		SCALE	1:1 SHEET 1 of 3 REV D2

4

3

2

1

THIS DRAWING IS UNPUBLISHED. RELEASED FOR PUBLICATION. ALL RIGHTS RESERVED.

© COPYRIGHT - By -

LOC	DIST	REVISIONS			
P	LTR	DESCRIPTION	DATE	DWN	APVD
IR	-	SEE SHEET 1	-	-	-

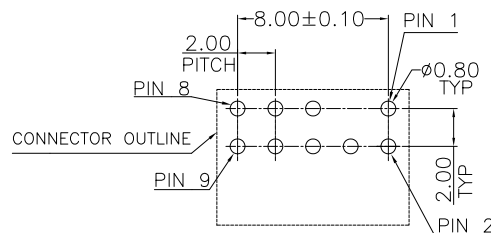
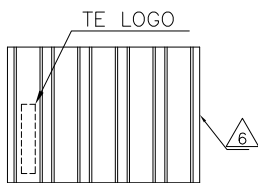

RECOMMENDED PCB LAYOUT
TOLERANCE ± 0.05 (TOP VIEW)

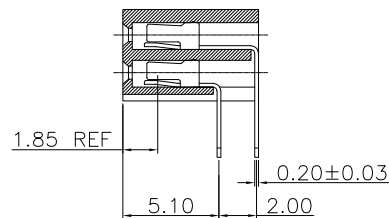
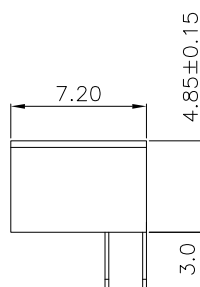
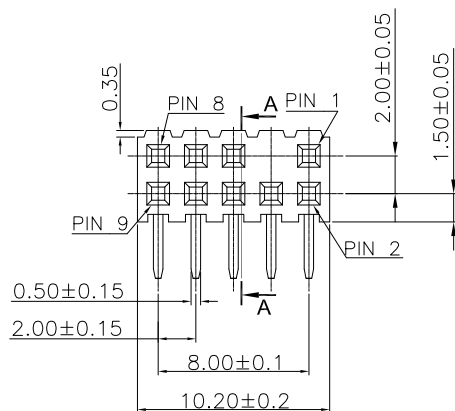

SECTION A-A

9	1734531-9
POSITION NUMBER	PART NUMBER

THIS DRAWING IS A CONTROLLED DOCUMENT.		DWN O.HU 05.JUL.2005	TE Connectivity	
DIMENSIONS: mm		CHK S.HOU 05.JUL.2005		
TOLERANCES UNLESS OTHERWISE SPECIFIED:		APVD W.J.KE 05.JUL.2005	NAME AMPMODU 2.0mm PITCH,RCPT CONN., RIGHT-ANGLE, MOUNT TYPE	
0 PLC ± 0.5 1 PLC ± 0.2 2 PLC ± 0.1 3 PLC ± 0.05 4 PLC ± - ± 3° FINISH		PRODUCT SPEC 108-57197		RESTRICTED TO
MATERIAL SEE SHEET 1		APPLICATION SPEC WEIGHT -		SIZE A3
FINISH SEE SHEET 1		CAGE CODE 00779		DRAWING NO 1734531
		CUSTOMER DRAWING		SCALE 1:1
		SHEET 2 of 3		REV D2

4

3

2

1

THIS DRAWING IS UNPUBLISHED. RELEASED FOR PUBLICATION. ALL RIGHTS RESERVED.

LOC	DIST	REVISIONS				
P	LTR	DESCRIPTION	DATE	DWN	APVD	
-	-	SEE SHEET 1	-	-	-	

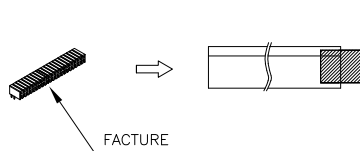

TUBE
635mm(L)X12mm(W)X11mm(H)

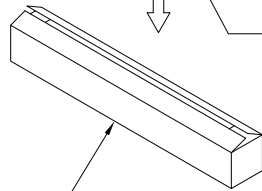
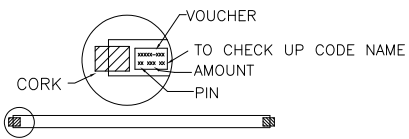
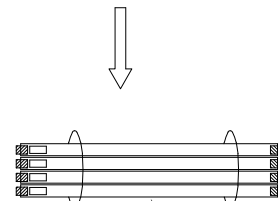

CARTON
660mm(L)X220mm(W)X140mm(H)

QTY	TUBE/CARTON	PCS/TUBE	POSITION NUMBER	PART NUMBER		
OBSOLETE	1050	150	7	80	8	-0
	1050	150	7	78	7	-8
	1050	150	7	76	7	-6
	1200	150	8	74	7	-4
	1200	150	8	72	7	-2
	1200	150	8	70	7	-0
	1200	150	8	68	6	-8
	1350	150	9	66	6	-6
	1350	150	9	64	6	-4
	1350	150	9	62	6	-2
	1500	150	10	60	6	-0
	1500	150	10	58	5	-8
	1500	150	10	56	5	-6
	1650	150	11	54	5	-4
	1650	150	11	52	5	-2
OBSOLETE	1800	150	12	50	5	-0
	1800	150	12	48	4	-8
	1950	150	13	46	4	-6
	1950	150	13	44	4	-4
	2100	150	14	42	4	-2
	2100	150	14	40	4	-0
	2250	150	15	38	3	-8
OBSOLETE	2400	150	16	36	3	-6
	2550	150	17	34	3	-4
	2700	150	18	32	3	-2
	2850	150	19	30	3	-0
	3150	150	21	28	2	-8
OBSOLETE	3300	150	22	26	2	-6
	3600	150	24	24	2	-4
	3900	150	26	22	2	-2
	4350	150	29	20	2	-0
	4800	150	32	18	1	-8
OBSOLETE	5400	150	36	16	1	-6
	6150	150	41	14	1	-4
	7200	150	48	12	1	-2
OBSOLETE	8550	150	57	10	1	-0
	8550	150	57	9	1734531	-9
OBSOLETE	10650	150	72	8	1734531	-8
	14400	150	96	6	1734531	-6
	21600	150	144	4	1734531	-4

THIS DRAWING IS A CONTROLLED DOCUMENT.

DIMENSIONS: mm	TOLERANCES UNLESS OTHERWISE SPECIFIED: 0 PLC ± 0.5 1 PLC ± 0.2 2 PLC ± 0.1 3 PLC ± 0.05 4 PLC ± 0.1 ANGLES ± 3°	DWN O.HU 05.JUL.2005	<p>AMPMODU 2.0mm PITCH, RCPT CONN., RIGHT-ANGLE, MOUNT TYPE</p>
	FINISH	CHK S.HOU 05.JUL.2005	
MATERIAL SEE SHEET 1	APVD W.J.KE 05.JUL.2005	NAME 108-57197	
	PRODUCT SPEC APPLICATION SPEC	SIZE A3	

WEIGHT	CAGE CODE	DRAWING NO	RESTRICTED TO
-	00779	1734531	-

CUSTOMER DRAWING SCALE 1:1 SHEET 3 OF 3 REV D2