

4

3

2

1

THIS DRAWING IS UNPUBLISHED. RELEASED FOR PUBLICATION. ALL RIGHTS RESERVED.

LOC	DIST	REVISIONS		
P	LR	DESCRIPTION	DATE	BY
N3		REVISED PER ECO-11-004587	11MAR11	RK HMR

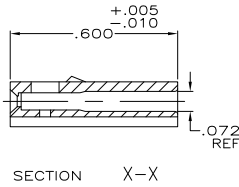
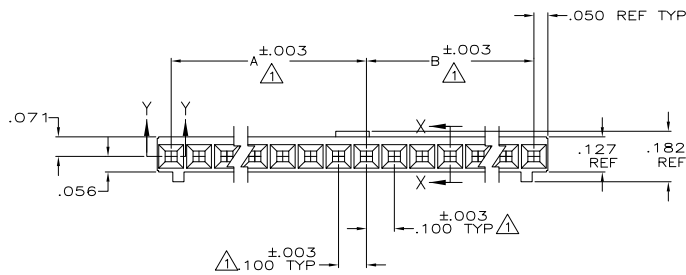
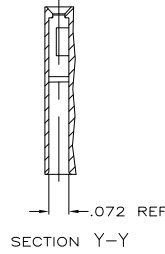
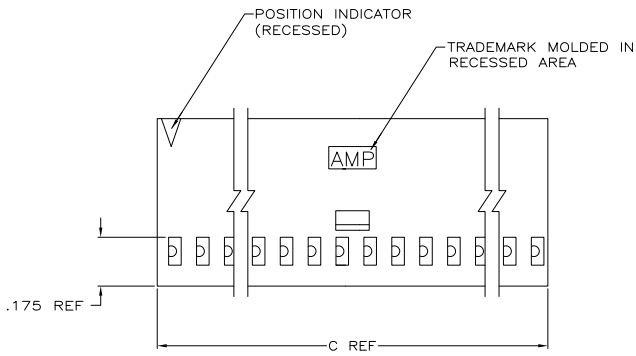

3	3.600	1.700	1.800	36	3-102241-4
	3.500	1.700	1.700	35	3-102241-3
	3.400	1.600	1.700	34	3-102241-2
	3.300	1.600	1.600	33	3-102241-1
	3.200	1.500	1.600	32	3-102241-0
	3.100	1.500	1.500	31	2-102241-9
	3.000	1.400	1.500	30	2-102241-8
	2.900	1.400	1.400	29	2-102241-7
	2.800	1.300	1.400	28	2-102241-6
	2.700	1.300	1.300	27	2-102241-5
	2.600	1.200	1.300	26	2-102241-4
	2.500	1.200	1.200	25	2-102241-3
	2.400	1.100	1.200	24	2-102241-2
	2.300	1.100	1.100	23	2-102241-1
	2.200	1.000	1.100	22	2-102241-0
	2.100	1.000	1.000	21	1-102241-9
	2.000	.900	1.000	20	1-102241-8
	1.900	.900	.900	19	1-102241-7
	1.800	.800	.900	18	1-102241-6
	1.700	.800	.800	17	1-102241-5
	1.600	.700	.800	16	1-102241-4
	1.500	.700	.700	15	1-102241-3
	1.400	.600	.700	14	1-102241-2
	1.300	.600	.600	13	1-102241-1
	1.200	.500	.600	12	1-102241-0
	1.100	.500	.500	11	102241-9
	1.000	.400	.500	10	102241-8
	.900	.400	.400	9	102241-7
	.800	.300	.400	8	102241-6
	.700	.300	.300	7	102241-5
	.600	.200	.300	6	102241-4
	.500	.200	.200	5	102241-3
	.400	.100	.200	4	102241-2
	.300	.100	.100	3	102241-1
C	B	A	NO OF POS	PART NUMBER	

- 1 CAVITY LOCATION DIMENSIONS INCREASE IN INCREMENTS OF .100 TOLERANCE NON-CUMULATIVE
- 2 USE EXTRACTION TOOL 91052-1 TO REMOVE RECEPTACLE CONTACTS
- 3 OBSOLETE PARTS: OBSOLETE CIS STREAMLINING PER D.RENAUD/D.SINISI

THIS DRAWING IS A CONTROLLED DOCUMENT.

DIMENSIONS: INCHES	TOLERANCES UNLESS OTHERWISE SPECIFIED:	DESIGNER: D. FABIAN 8-2-78	DATE: 10-27-78	DR: S. WOLFE	NAME: S. WOLFE
0 PLC ± .005	1 PLC ± .005	2 PLC ± .005	3 PLC ± .005	4 R.C. ± .005	5 ± .005
MATERIAL: GLASS FILLED NYLON FLAME RETARDANT COLOR BLACK PER ASTM D468	FINISH: -	PRODUCT SPEC: -	APPLICATION SPEC: -	WEIGHT: -	SIZE: A2
CUSTOMER DRAWING			SCALE: -	SHEET: 1 of 1	REV: N3

TE Connectivity
CONN HOUSING, CRIMP SNAP-IN MOD IV, SINGLE ROW, 100 CENTERS, WITH POLARIZATION AND DETENTS
SIZE: 02E CODE: 102241