

4

3

2

1

THIS DRAWING IS UNPUBLISHED. RELEASED FOR PUBLICATION. BY TYCO ELECTRONICS CORPORATION. ALL RIGHTS RESERVED.

LOC	DIST	REVISIONS					
AD	00	P	LTR	DESCRIPTION	DATE	BY	APPD
		P1		REVISED PER ECO-09-020932	21AUG09	KK	AEG

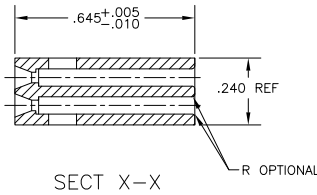
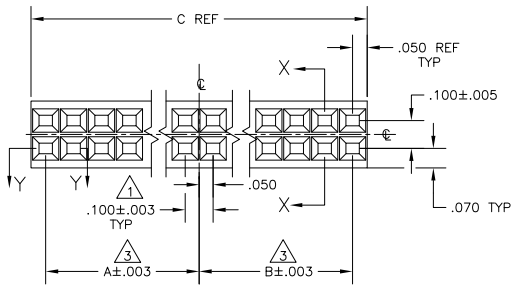
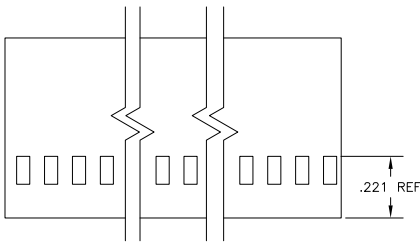

SECT Y-Y

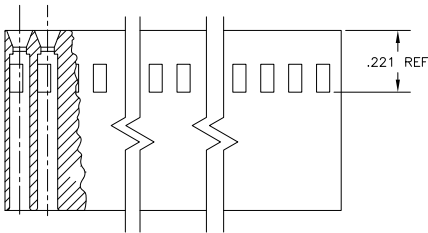

- ⚠ CAVITY LOCATION DIMENSIONS INCREASE IN INCREMENTS OF .100 TOLERANCE NON-CUMULATIVE
- ⚠ USE EXTRACTION TOOL 91052 TO REMOVE RECEPTACLE CONTACTS.
- ⚠ TOLERANCE ON THE "A" & "B" DIMENSIONS FOR 2-86177-2 ONLY IS +.003 - .004
- ⚠ OBSOLETE PARTS: OBSOLETE CIS STREAMLINING PER D.RENAUD/D.SINISI

⚠	.200	-	.100	4	2-86177-5	
⚠	3.500	1.700	1.700	70	2-86177-4	
⚠	2.400	1.100	1.200	48	2-86177-3	
⚠	4.600	2.200	2.300	92	2-86177-2	
⚠	2.500	1.200	1.200	50	2-86177-1	
⚠	.400	.100	.200	8	2-86177-0	
⚠	2.600	1.200	1.300	52	1-86177-9	
⚠	.300	.100	.100	6	1-86177-8	
⚠	2.200	1.000	1.100	44	1-86177-7	
⚠	.900	.400	.400	18	1-86177-6	
⚠	.800	.300	.400	16	1-86177-5	
⚠	.700	.300	.300	14	1-86177-4	
⚠	.600	.200	.300	12	1-86177-3	
⚠	.500	.200	.200	10	1-86177-2	
⚠	2.000	.900	1.000	40	1-86177-1	
⚠	1.900	.900	.900	38	1-86177-0	
⚠	1.800	.800	.900	36	86177-9	
⚠	1.700	.800	.800	34	86177-8	
⚠	1.600	.700	.800	32	86177-7	
⚠	1.500	.700	.700	30	86177-6	
⚠	1.400	.600	.700	28	86177-5	
⚠	1.300	.600	.600	26	86177-4	
⚠	1.200	.500	.600	24	86177-3	
⚠	1.100	.500	.500	22	86177-2	
⚠	1.000	.400	.500	20	86177-1	
		C	B	A	NO. OF POS.	PART NUMBER

THIS DRAWING IS A CONTROLLED DOCUMENT. **FOR BOLES BC** 07SEP99
OK J. GESFORD 230CT89
APPC J. GESFORD 230CT89
PRODUCT SPEC J. GESFORD 230CT89
APPLICATION SPEC -
WEIGHT -
MATERIAL GLASS FILLED NYLON
FINISH COLOR-BLACK
TYCO ELECTRONICS Tyco Electronics Corporation
 Harrisburg, PA 17105-3608
MOD IV CRIMP SNAP-IN CONNECTOR, DOUBLE ROW, .100 CENTERS
SIZE CAGE CODE **DRAWING NO.** RESTRICTED TO
A2 00779 **C-86177**
CUSTOMER DRAWING **SCALE** 4:1 **SHEET** 1 of 1 **REV** P1

A

B

C

D