

4

3

2

1

THIS DRAWING IS UNPUBLISHED. RELEASED FOR PUBLICATION. ALL RIGHTS RESERVED.

LOC	DIST	REVISIONS					
AD	00	F	LNK	DESCRIPTION	DATE	MIN	APD
		V2		REVISED PER ECO-11-004820	11MAR11	RK	HMR

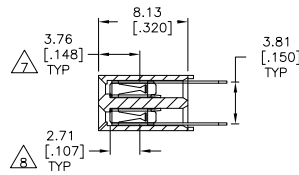
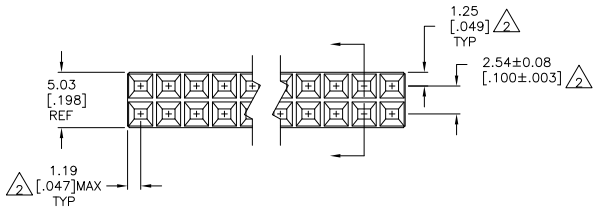
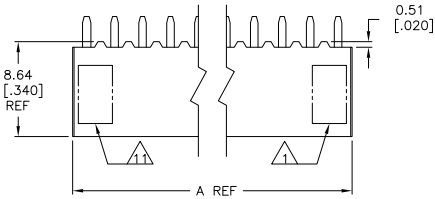

- △ TE CONNECTIVITY LOGO AND CSA LOGO ARE MOLDED INTO THE HOUSING.
- △ TOLERANCE NON-CUMULATIVE.
- △ DUPLEX PLATED: 0.00076 (.000030) GOLD IN CONTACT AREA, .00381-.00762 (.000150-.000300) BRIGHT TIN-LEAD ON LEADS, ALL OVER 0.00127 (.000050) MIN NICKEL.
- △ THESE DIMENSIONS PERTAIN TO CAVITY C/L'S ONLY, NOT TO CONTACT LOCATIONS.
- △ NO PART NUMBER MARKING REQUIRED ON THIS PART NUMBER.
- △ HOUSING: FLAME RETARDANT GLASS FILLED POLYESTER - BLACK. CONTACTS: PHOS. BRONZE.
- △ POINT OF CONTACT DIMENSION.
- △ POINT OF MEASUREMENT FOR PLATING THICKNESS (INSIDE CONTACT BEAMS).
- △ DUPLEX PLATED: 0.00076 (.000030) GOLD DUPLEX IN CONTACT AREA, 0.00381-0.00762 (.000150-.000300) MATTE TIN ON LEADS, ALL OVER 0.00127 (.000050) MIN NICKEL.
- △ ROHS 2002/95/EC COMPLIANT
- △ PART NUMBER AND DATE CODE ARE MARKED IN APPROXIMATE LOCATION SHOWN.
- △ OBSOLETE PARTS: OBSOLETE CIS STREAMLINING PER D.RENAUD/D.SINISI

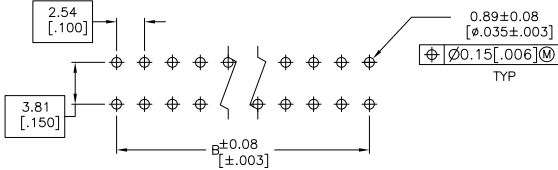

RECOMMENDED HOLE LAYOUT FOR TOP ENTRY

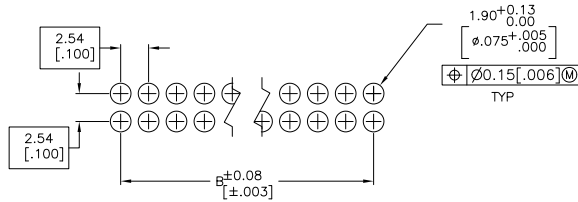

RECOMMENDED HOLE LAYOUT FOR BOTTOM ENTRY OR PASS THROUGH APPLICATIONS

THIS DRAWING IS A CONTROLLED DOCUMENT.		DR R. BOLES 19-11-92	 TE Connectivity
		CHK T. KINSEY 19-11-92	
DIMENSIONS: mm [INCHES]		APPC -	NAME
TOLERANCES UNLESS OTHERWISE SPECIFIED:		PRODUCT SPEC 108-25026	ASSEMBLY, MOD II DOUBLE ROW, .100 X .100 C/L, VERTICAL MOUNTED, CLOSED ENTRY, SHORT PT. CONTACTS
0 P.L.C. ± .		APPLICATION SPEC 114-25018	RESTRICTED TO
1 P.L.C. ± .		SIZE CAGE CODE (DRAWING NO) A2 00779 C=534236	
2 P.L.C. ± .005		WEIGHT -	
3 P.L.C. ± .		CUSTOMER DRAWING	SCALE 4:1 SHEET 1 of 2 REV V2
4 P.L.C. ± .			
ANGLES ± .			
MATERIAL	FINISH		

