

4

3

2

1

THIS DRAWING IS UNPUBLISHED. RELEASED FOR PUBLICATION AUG. 2006.
 COPYRIGHT - BY TYCO ELECTRONICS CORPORATION. ALL RIGHTS RESERVED.

LOC	DIST	REVISIONS			
P	LTR	DESCRIPTION	DATE	DWN	APVD
C2		REVISED (ECR-11-015593)	27JUL11	JL	WK

- NOTE :
- MATERIAL : HOUSING : PA6T WITH 30% GF, UL94V-0, BLACK COLOR. CONTACT : BRASS.
 - FINISH : CONTACT : 0.2um [8um] MIN. GOLD PLATED ON CONTACT AREA
2.54um [100um] MIN. MATTE TIN PLATED ON SOLDER TAIL,
1.27um [50um] MIN. NICKEL UNDERPLATED OVER ALL
 - APPLICATION : SOLDER TAIL LENGTH 2.6 FOR PCB THICKNESS 1.6±0.1
 - WAVE SOLDER CAPABLE TO 265°C PER TE SPEC 109-202, CONDITION B.

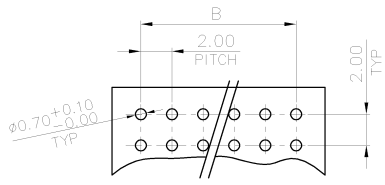
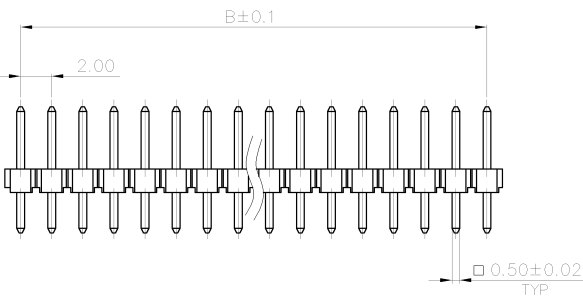
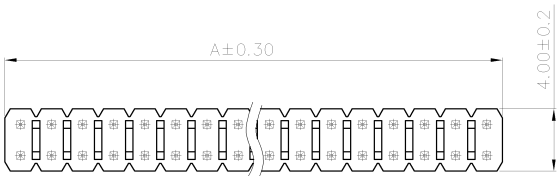

RECOMMENDED PCB LAYOUT
 TOLERANCE: ±0.05; THICKNESS: 1.0~1.6MM

KEYING POS.	A	B	POSITION NUMBER	PART NUMBER
	10.00	8.00	10	1- -1
	80.00	78.00	80	8- -0
	78.00	76.00	78	7- -8
	76.00	74.00	76	7- -6
	74.00	72.00	74	7- -4
	72.00	70.00	72	7- -2
	70.00	68.00	70	7- -0
	68.00	66.00	68	6- -8
	66.00	64.00	66	6- -6
	64.00	62.00	64	6- -4
	62.00	60.00	62	6- -2
	60.00	58.00	60	6- -0
	58.00	56.00	58	5- -8
	56.00	54.00	56	5- -6
	54.00	52.00	54	5- -4
	52.00	50.00	52	5- -2
	50.00	48.00	50	5- -0
	48.00	46.00	48	4- -8
	46.00	44.00	46	4- -6
	44.00	42.00	44	4- -4
	42.00	40.00	42	4- -2
	40.00	38.00	40	4- -0
	38.00	36.00	38	3- -8
	36.00	34.00	36	3- -6
	34.00	32.00	34	3- -4
	32.00	30.00	32	3- -2
	30.00	28.00	30	3- -0
	28.00	26.00	28	2- -8
	26.00	24.00	26	2- -6
	24.00	22.00	24	2- -4
	22.00	20.00	22	2- -2
	20.00	18.00	20	2- -0
	18.00	16.00	18	1- -8
	16.00	14.00	16	1- -6
	14.00	12.00	14	1- -4
	12.00	10.00	12	1- -2
	10.00	8.00	10	1- -0
	8.00	6.00	8	- -8
	6.00	4.00	6	- -6
	4.00	2.00	4	- -4
				1734508-4

THIS DRAWING IS A CONTROLLED DOCUMENT.

DIMENSIONS: MM	TOLERANCES UNLESS OTHERWISE SPECIFIED:	DWN S. CHIEN 02DEC2008	STE TE Connectivity	
0 PLC ± 0.5	1 PLC ± 0.2	CHK S. CHIEN 02DEC2008	AMPMODU 2.0mm PITCH POST HDR, VERTICAL, MOUNT TYPE	
2 PLC ± 0.1	3 PLC ± 0.05	APVD W. KODAMA 02DEC2008	NAME	RESTRICTED
4 PLC ± -	ANGLES ± 3°	PRODUCT SPEC	SIZE	CAGE CODE
MATERIAL	FINISH	108-57197	A3	00779
SEE NOTE	SEE NOTE	QUALIFICATION TEST REPORT	DRAWING NO	C-1734508
		501-57197	SCALE	SHEET
		WEIGHT	1 of 4	REV C2
		CUSTOMER DRAWING		

4

3

2

1

THIS DRAWING IS UNPUBLISHED. RELEASED FOR PUBLICATION
 © COPYRIGHT 2011 BY TYCO ELECTRONICS CORPORATION. ALL RIGHTS RESERVED.

LOC	DIST	REVISIONS				
P	LTR	DESCRIPTION	DATE	DWN	APVD	
		SEE SHEET 1.				

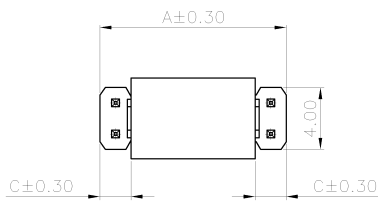

NOTE:
 1. MATERIAL:
 HOUSING: PA6T WITH 30% GF, UL 94V-0, BLACK COLOR.
 CAP: LCP WITH 30% GF, UL 94V-0, BLACK COLOR.
 CONTACT: BRASS.
 2. FINISH :
 CONTACT:
 0.0254um [10u"] MIN. GOLD PLATED ON CONTACT AREA
 2.54um [100u"] MIN. MATTE-TIN PLATED ON SOLDER TAIL,
 1.27um [50u"] MIN. NICKEL UNDERPLATED OVER ALL
 4. WAVE SOLDER CAPABLE TO 265°C PER TEST SPEC 109-202, CONDITION B.

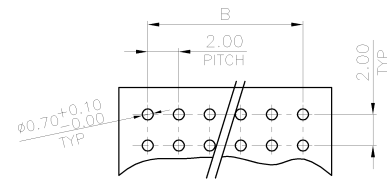
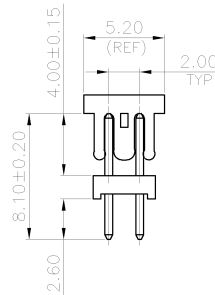
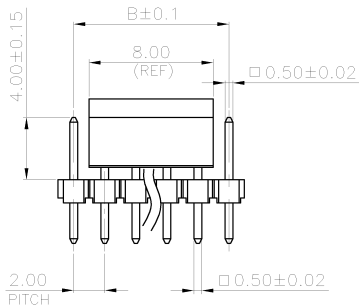

RECOMMENDED PCB LAYOUT
 TOLERANCE: ±0.05; THICKNESS: 1.0~1.6MM

3.00	14.00	12.00	14	9-1734508-4
2.00	12.00	10.00	12	9-1734508-2
C	A	B	POSITION NUMBER	PART NUMBER

THIS DRAWING IS A CONTROLLED DOCUMENT.		DWN	TE Connectivity		
DIMENSIONS: mm		CHK			
TOLERANCES UNLESS OTHERWISE SPECIFIED:		APVD	NAME		
0 PLC ± - 1 PLC ± 0.3 2 PLC ± 0.2 3 PLC ± 0.15 4 PLC ± - ANGLES ± 3°		PRODUCT SPEC	AMPMODU, 2.0mm PITCH, POST HDR, VERTICAL, MOUNT TYPE		
MATERIAL	FINISH	APPLICATION SPEC	SIZE	CAGE CODE	DRAWING NO
SEE NOTE	SEE NOTE	WEIGHT	A3	00779	C-1734508
		CUSTOMER DRAWING	SCALE	SHEET	REV
				2 of 4	C2

4

3

2

1

THIS DRAWING IS UNPUBLISHED. RELEASED FOR PUBLICATION AUG. 2006.
 COPYRIGHT - BY TYCO ELECTRONICS CORPORATION. ALL RIGHTS RESERVED.

LOC	DIST	REVISIONS				
P	LTR	DESCRIPTION	DATE	DWN	APVD	
SEE SHEET 1.						

HEADER(P=2.00)
DUAL ROW SERIES(1.50)

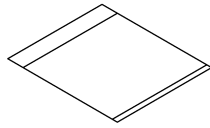
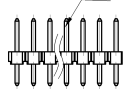

BUSINESS ESTABLISHMENT LABEL

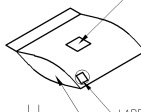

LABEL
BAG
150MM(L)x120MM(W)

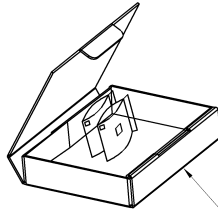
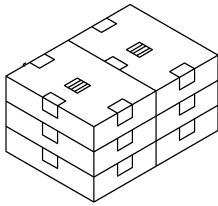

INNER BOX

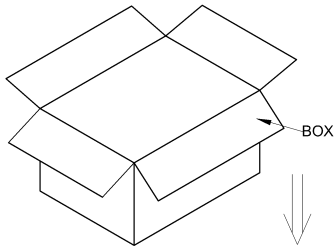

BOX

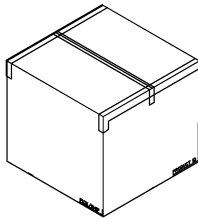

NOTE:
1. DIMENSIONS:
BOX: 392*245*260MM
INNER BOX: 218*185*80MM
PE BAG: 150*120*0.08MM

ITEM NO.	DESCRIPTION	UNIT	QTY	WEIGHT	VOLUME	PCS/BAG	BAGS /INNER CARTON	INNER CARTON /CARTON	QUANTITY	NO. OF POSTS
6.90	KG	5.52	500	8	6	24000	PCS	10		
5.788	KG	4.408	50	8	6	2400	PCS	80		
5.678	KG	4.298	50	8	6	2400	PCS	78		
5.665	KG	4.185	50	8	6	2400	PCS	76		
5.433	KG	4.053	50	8	6	2400	PCS	74		
5.344	KG	3.964	50	8	6	2400	PCS	72		
5.236	KG	3.856	50	8	6	2400	PCS	70		
5.128	KG	3.748	50	8	6	2400	PCS	68		
5.74	KG	4.36	60	8	6	2880	PCS	66		
5.61	KG	4.23	60	8	6	2880	PCS	64		
5.478	KG	4.098	60	8	6	2880	PCS	62		
6.096	KG	4.626	70	8	6	3360	PCS	60		
5.852	KG	4.472	70	8	6	3360	PCS	58		
7.548	KG	6.168	100	8	6	4800	PCS	56		
7.33	KG	5.947	100	8	6	4800	PCS	54		
7.106	KG	5.726	100	8	6	4800	PCS	52		
6.89	KG	5.51	100	8	6	4800	PCS	50		
6.669	KG	5.289	100	8	6	4800	PCS	48		
6.448	KG	5.068	100	8	6	4800	PCS	46		
6.228	KG	4.848	100	8	6	4800	PCS	44		
6.007	KG	4.627	100	8	6	4800	PCS	42		
5.786	KG	4.406	100	8	6	4800	PCS	40		
5.565	KG	4.185	100	8	6	4800	PCS	38		
5.344	KG	3.964	100	8	6	4800	PCS	36		
5.124	KG	3.744	100	8	6	4800	PCS	34		
4.903	KG	3.523	100	8	6	4800	PCS	32		
4.687	KG	3.307	100	8	6	4800	PCS	30		
4.466	KG	3.086	100	8	6	4800	PCS	28		
5.678	KG	4.298	150	8	6	7200	PCS	26		
5.35	KG	3.97	150	8	6	7200	PCS	24		
6.23	KG	4.85	200	8	6	9600	PCS	22		
5.79	KG	4.41	200	8	6	9600	PCS	20		
6.35	KG	4.97	250	8	6	12000	PCS	18		
5.78	KG	4.40	250	8	6	12000	PCS	16		
6.00	KG	4.62	300	8	6	14400	PCS	14		
5.34	KG	3.96	300	8	6	14400	PCS	12		
6.90	KG	5.52	500	8	6	24000	PCS	10		
5.80	KG	4.42	500	8	6	24000	PCS	8		
6.68	KG	5.30	800	8	6	38400	PCS	6		
5.79	KG	4.41	1000	8	6	48000	PCS	4		
GROSS WEIGHT	NET WEIGHT	PCS/BAG	BAGS /INNER CARTON	INNER CARTON /CARTON	QUANTITY	NO. OF POSTS				

THIS DRAWING IS A CONTROLLED DOCUMENT.	
DIMENSIONS: MM	TOLERANCES UNLESS OTHERWISE SPECIFIED:
0 PLC ± .05	1 PLC ± .05
2 PLC ± .05	3 PLC ± .05
4 PLC ± .05	ANGLES ± .05
MATERIAL	FINISH
CHK	APVD
PRODUCT SPEC	APPLICATION SPEC
WEIGHT	CUSTOMER DRAWING

STE TE Connectivity

AMP/ODU 2.0mm PITCH, POST HDR, VERTICAL, MOUNT TYPE

SIZE: A3 CAGE CODE: 00779 DRAWING NO: C-1734508

SCALE: SHEET 3 OF 4 REV: C2

4

3

2

1

THIS DRAWING IS UNPUBLISHED. RELEASED FOR PUBLICATION
 © COPYRIGHT 2011 BY TYCO ELECTRONICS CORPORATION. ALL RIGHTS RESERVED.

LOC	DIST	REVISIONS			
P	LTR	DESCRIPTION	DATE	DWN	APVD
SEE SHEET 1.					

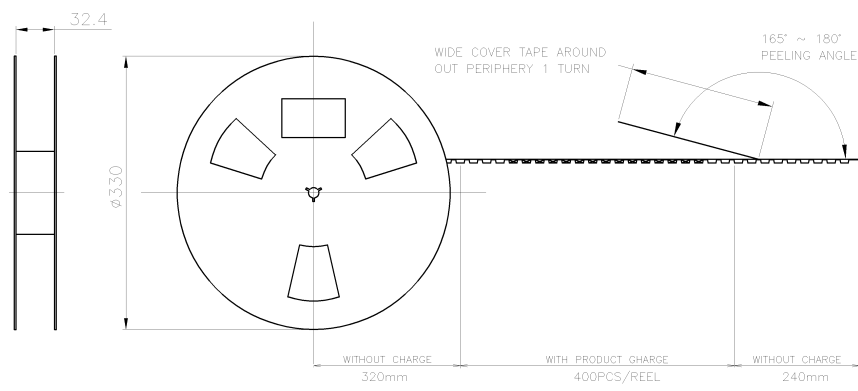

- NOTES :
- MATERIAL :
 COVER TAPE : PT+ABS, COLOR: TRANSPARENT
 CARRIER TAPE : PS
 REEL : PS
 SHIPPING BOX : CORRUGATED FIBER
 - PEELING RESISTANCE : 10gf~130gf (for 12mm~56mm)
 - PEELING SPEED : 300mm/MINUTES

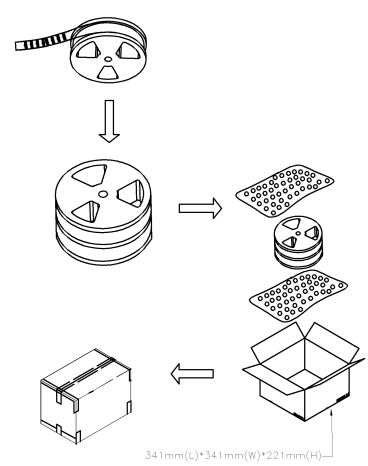

22.00	14.80	3.70KG	1.03KG	2000	400	14	9-1734508-4
20.00	12.80	3.51KG	0.94KG	2000	400	12	9-1734508-2
DIM. B	DIM. A	GROSS WEIGHT	NET WEIGHT	PCS/BOX	PCS/REEL	POS	PART NO.

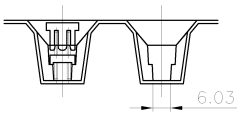
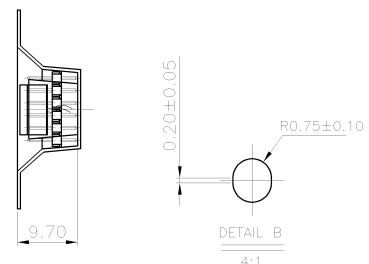
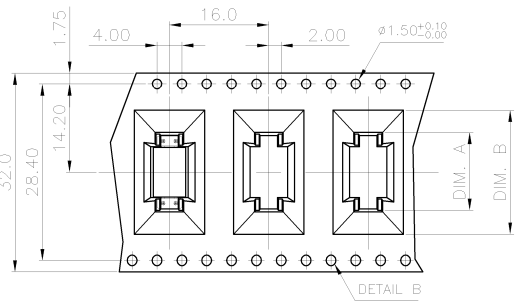

THIS DRAWING IS A CONTROLLED DOCUMENT.

DIMENSIONS: mm	TOLERANCES UNLESS OTHERWISE SPECIFIED:	DWN	TE Connectivity			
0 PLC ±	1 PLC ±0.3	CHK	NAME			
2 PLC ±0.2	3 PLC ±0.15	APVD	AMPMODU, 2.0mm PITCH, POST HDR, VERTICAL, MOUNT TYPE			
4 PLC ±	ANGLES ±°	PRODUCT SPEC	SIZE	CAGE CODE	DRAWING NO	RESTRICTED TO
MATERIAL	FINISH	APPLICATION SPEC	A3	00779	1734508	
WEIGHT			CUSTOMER DRAWING		SCALE	SHEET 4 of 4
REV			C2			