

4

3

2

1

THIS DRAWING IS UNPUBLISHED. RELEASED FOR PUBLICATION. BY TYCO ELECTRONICS CORPORATION. ALL RIGHTS RESERVED.

LOC	DIST	REVISIONS					
AD	00	F	LTR	DESCRIPTION	DATE	MIN	APD
		G		REVISED PER EC 0512-0273-05	19SEP05	JDP	DD

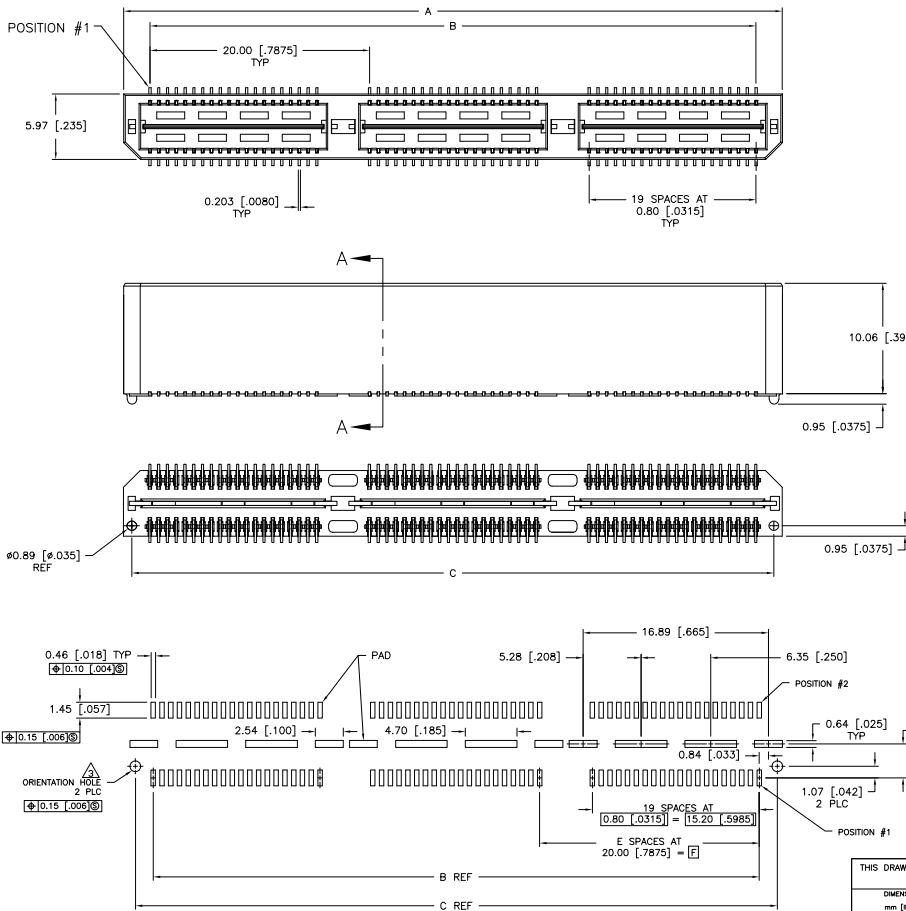

RECOMMENDED PC BOARD LAYOUT  
(VIEWED FROM CONNECTOR SIDE)

- 1 HOUSING: LCP, BLACK.  
CONTACT & GROUND PLANE: PHOS BRONZE.
- 2 CONTACT PLATING: SELECT 0.76 MICROMETERS (.000030 IN) MIN GOLD.
- 3 FOR STANDARD APPLICATIONS, ORIENTATION HOLE TO BE  $\phi 1.02$  [ $\phi .0400$ ].

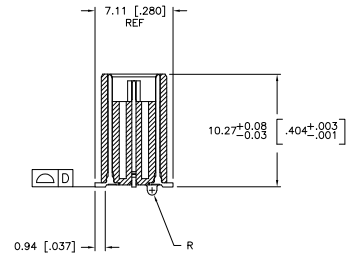

SECTION A-A

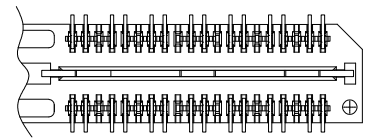

DIFFERENTIAL PAIR LOADING  
(BOTTOM VIEW)  
SCALE 2:1

THIS DRAWING IS A CONTROLLED DOCUMENT.		DIM: B CARBO 27MAV03 CHK: DIXON 27MAV03 D: DIXON 27MAV03 DATE: 27MAV03 NAME:	Tyco Electronics Corporation Harrisburg, PA 17105-3608
DIMENSIONS: mm [INCHES]	TO MANUFACTURE: 0 PLC ± .1 1 PLC ± 0.3(0.1) 2 PLC ± 0.15(0.05) 3 PLC ± 0.05(0.025) 4 PLC ± .1 ANGLE ± .1 FINISH	PRODUCT SPEC: APPLICATION SPEC: WEIGHT: CUSTOMER DRAWING	HEADER ASSEMBLY, 11.0MM [.433] VERTICAL, 0.80MM CL, MICTOR SB SIZE: A2 CAGE CODE: 00779 DRAWING NO: 1658465 RESTRICTED TO: G SCALE: 3:1 SHEET: 1 of 2 REV: G

4

3

2

1

THIS DRAWING IS UNPUBLISHED. RELEASED FOR PUBLICATION  
 © COPYRIGHT BY TYCO ELECTRONICS CORPORATION. ALL RIGHTS RESERVED.

LOC	DIST	REVISIONS					
AD	00	F	LTR	DESCRIPTION	DATE	BY	APP
				SEE SHEET 1			

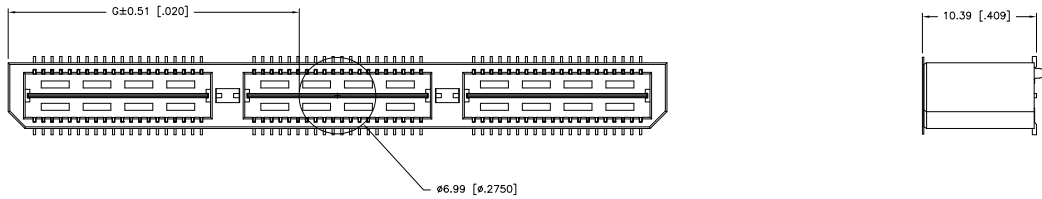

26.52(1.044)	40.00(1.575)	2	0.102(0.040)	58.50(2.303)	55.20(2.173)	60.00(2.362)	YES	POCKET TAPE	YES	84	7-1658465-3
16.51(650)	20.00(7874)	1	0.102(0.040)	38.48(1.515)	35.20(1.386)	40.00(1.575)	YES	POCKET TAPE	YES	56	7-1658465-2
6.50(256)	0(000)	0	0.102(0.040)	18.49(728)	15.20(598)	20.00(787)	YES	POCKET TAPE	YES	28	7-1658465-1
26.52(1.044)	40.00(1.575)	2	0.102(0.040)	58.50(2.303)	55.20(2.173)	60.00(2.362)	YES	POCKET TAPE	NO	120	6-1658465-3
16.51(650)	20.00(7874)	1	0.102(0.040)	38.48(1.515)	35.20(1.386)	40.00(1.575)	YES	POCKET TAPE	NO	80	6-1658465-2
6.50(256)	0(000)	0	0.102(0.040)	18.49(728)	15.20(598)	20.00(787)	YES	POCKET TAPE	NO	40	6-1658465-1
-	40.00(1.575)	2	0.102(0.040)	58.50(2.303)	55.20(2.173)	60.00(2.362)	NO	POCKET TAPE	YES	84	5-1658465-3
-	20.00(7874)	1	0.102(0.040)	38.48(1.515)	35.20(1.386)	40.00(1.575)	NO	POCKET TAPE	YES	56	5-1658465-2
-	0(000)	0	0.102(0.040)	18.49(728)	15.20(598)	20.00(787)	NO	POCKET TAPE	YES	28	5-1658465-1
-	40.00(1.575)	2	0.102(0.040)	58.50(2.303)	55.20(2.173)	60.00(2.362)	NO	POCKET TAPE	NO	120	4-1658465-3
-	20.00(7874)	1	0.102(0.040)	38.48(1.515)	35.20(1.386)	40.00(1.575)	NO	POCKET TAPE	NO	80	4-1658465-2
-	0(000)	0	0.102(0.040)	18.49(728)	15.20(598)	20.00(787)	NO	POCKET TAPE	NO	40	4-1658465-1
46.51(1.831)	80.00(3.150)	4	0.152(0.060)	98.50(3.748)	95.20(3.748)	100.00(3.937)	YES	TRAY	YES	140	3-1658465-5
36.53(1.438)	60.00(2.362)	3	0.152(0.060)	78.49(3.090)	75.20(2.961)	80.00(3.150)	YES	TRAY	YES	112	3-1658465-4
26.52(1.044)	40.00(1.575)	2	0.102(0.040)	58.50(2.303)	55.20(2.173)	60.00(2.362)	YES	TRAY	YES	84	3-1658465-3
16.51(650)	20.00(7874)	1	0.102(0.040)	38.48(1.515)	35.20(1.386)	40.00(1.575)	YES	TRAY	YES	56	3-1658465-2
6.50(256)	0(000)	0	0.102(0.040)	18.49(728)	15.20(598)	20.00(787)	YES	TRAY	YES	28	3-1658465-1
46.51(1.831)	80.00(3.150)	4	0.152(0.060)	98.50(3.748)	95.20(3.748)	100.00(3.937)	YES	TRAY	NO	200	2-1658465-5
36.53(1.438)	60.00(2.362)	3	0.152(0.060)	78.49(3.090)	75.20(2.961)	80.00(3.150)	YES	TRAY	NO	160	2-1658465-4
26.52(1.044)	40.00(1.575)	2	0.102(0.040)	58.50(2.303)	55.20(2.173)	60.00(2.362)	YES	TRAY	NO	120	2-1658465-3
16.51(650)	20.00(7874)	1	0.102(0.040)	38.48(1.515)	35.20(1.386)	40.00(1.575)	YES	TRAY	NO	80	2-1658465-2
6.50(256)	0(000)	0	0.102(0.040)	18.49(728)	15.20(598)	20.00(787)	YES	TRAY	NO	40	2-1658465-1
-	80.00(3.150)	4	0.152(0.060)	98.50(3.748)	95.20(3.748)	100.00(3.937)	NO	TRAY	YES	140	1-1658465-5
-	60.00(2.362)	3	0.152(0.060)	78.49(3.090)	75.20(2.961)	80.00(3.150)	NO	TRAY	YES	112	1-1658465-4
-	40.00(1.575)	2	0.102(0.040)	58.50(2.303)	55.20(2.173)	60.00(2.362)	NO	TRAY	YES	84	1-1658465-3
-	20.00(7874)	1	0.102(0.040)	38.48(1.515)	35.20(1.386)	40.00(1.575)	NO	TRAY	YES	56	1-1658465-2
-	0(000)	0	0.102(0.040)	18.49(728)	15.20(598)	20.00(787)	NO	TRAY	YES	28	1-1658465-1
-	80.00(3.150)	4	0.152(0.060)	98.50(3.748)	95.20(3.748)	100.00(3.937)	NO	TRAY	NO	200	1658465-5
-	60.00(2.362)	3	0.152(0.060)	78.49(3.090)	75.20(2.961)	80.00(3.150)	NO	TRAY	NO	160	1658465-4
-	40.00(1.575)	2	0.102(0.040)	58.50(2.303)	55.20(2.173)	60.00(2.362)	NO	TRAY	NO	120	1658465-3
-	20.00(7874)	1	0.102(0.040)	38.48(1.515)	35.20(1.386)	40.00(1.575)	NO	TRAY	NO	80	1658465-2
-	0(000)	0	0.102(0.040)	18.49(728)	15.20(598)	20.00(787)	NO	TRAY	NO	40	1658465-1
G	F	E	D	C	B	A		POLYIMIDE FILM PAD	PACKAGING TYPE	DIFF PAIR POS	PART NUMBER

THIS DRAWING IS A CONTROLLED DOCUMENT.

DIMENSIONS: mm [INCHES] TOLERANCES UNLESS OTHERWISE SPECIFIED: 0 PL ± 0.3(0.1) 1 PL ± 0.13(0.005) 2 PL ± 0.08(0.002) 3 PL ± 0.1 ANGLE ± 0.1 FINISH SEE SHEET 1	DIM: B. CARBO 27MAY03 CHK: D. DIXON 27MAY03 APP: D. DIXON 27MAY03 PRODUCT SPEC: -- APPLICATION SPEC: -- WEIGHT: -- CUSTOMER DRAWING	Tyco Electronics Corporation Harrisburg, PA 17105-3608 HEADER ASSEMBLY, 11.0MM [433] VERTICAL, 0.80MM CL, MICTOR SB SIZE: A2 CASE CODE: 00779 DRAWING NO: C-1658465 RESTRICTED TO: -- SCALE: 3:1 SHEET: 2 of 2 REV: G
---	---	--

1658465

A