

4

3

2

1

THIS DRAWING IS UNPUBLISHED. RELEASED FOR PUBLICATION.  
 BY TYCO ELECTRONICS CORPORATION. ALL RIGHTS RESERVED.

LOC	DIST	REVISIONS			
F	LNK	DESCRIPTION	DATE	BY	APPD
Z		REV PER 0030-0515-04	05JAN05	JR	MM
Z1		REVISED PER ECO-09-024927	09NOV09	KK	AEG

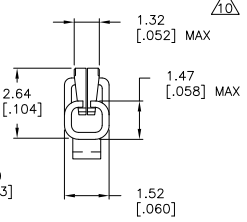
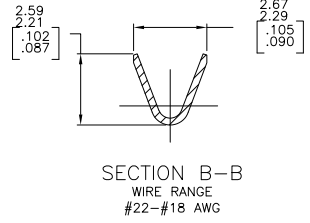
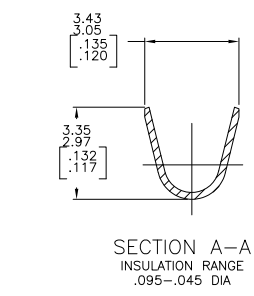
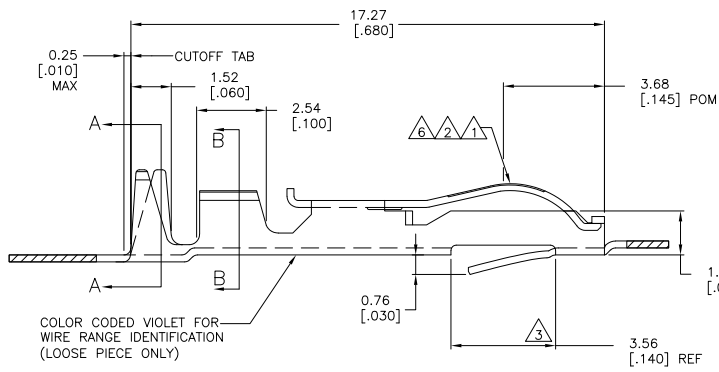
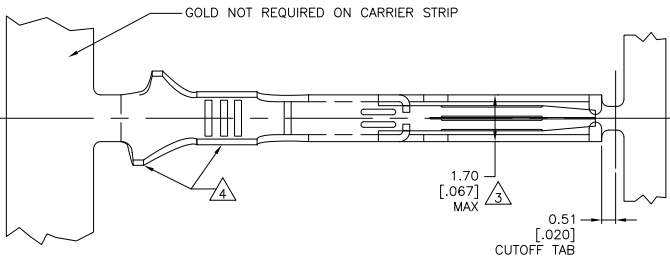

- 1 .000030 GOLD OVER .000030 NICKEL IN CONTACT AREA.
- 2 .000015 GOLD OVER .000030 NICKEL IN CONTACT AREA.
- 3 .067 MAX ALLOWED IN LOCKING POSITION AREA FOR .140 REF LENGTH.
- 4 TIN-LEAD IN CRIMP AREA.
- 5 OBSOLETE
- 6 .000050 GOLD OVER .000050 NICKEL IN CONTACT AREA. REMAINDER OF CONTACT GOLD FLASH OVER NICKEL.
- 7 CRIMP TWIN LEAF CONTACTS WITH 22-18 AWG WIRE RANGE TO BE USED ONLY WITH .125CL & .156CL CRIMP TWIN LEAF HOUSINGS.
- 8 UNPLATED PARTS IN STRIP FORM REELED ON CORRUGATED REEL FOR SALABLE PART.
- 9 TIN IN CRIMP AREA.
- 10 OBSOLETE PARTS; OBSOLETE CIS STREAMLINING PER D.RENAUD/D.SINISI

OBSOLETE	5-583649-3	-583649-8	1 9	10 5-583649-6
OBSOLETE	5-583649-2	-583649-9	2 9	10 5-583649-5
OBSOLETE	1-583649-1	-	8	-
OBSOLETE	583649-4	1-583649-0	6	10 583649-7
OBSOLETE	583649-3	583649-8	1 4	583649-6
OBSOLETE	583649-2	583649-9	2 4	10 583649-5
	STRIP PART #	STD REELING LEFT TO RIGHT	STRIP PART #	REELING RIGHT TO LEFT
			FINISH	LOOSE PIECE

THIS DRAWING IS A CONTROLLED DOCUMENT. DIM A STAUJL BG 02AJG93  
 CHK H ROSE 18FEB94  
 APPD H ROSE 18FEB94  
 PRODUCT SPEC: -  
 APPLICATION SPEC: -  
 WEIGHT: -  
 MATERIAL: PHOS BRONZE  
 FINISH: SEE TABLE  
 CUSTOMER DRAWING

Tyco Electronics Corporation  
 Harrisburg, PA 17105-3608

CONTACT-TWIN LEAF  
 (CRIMP-SNAP)

SIZE: A2 CASE CODE: C-583649 DRAWING NO: 00779  
 SCALE: 10:1 SHEET: 1 of 1 REV: Z1

583649

A