

THIS DRAWING IS UNPUBLISHED
 ALL RIGHTS RESERVED

| REV | DATE | DESCRIPTION | BY | CHK | APP |
|-----|------|---------------------------|--------|-----|-----|
| AD | 00 | | | | |
| B1 | | REVISED PER EDD-11-004835 | 11MR11 | RK | HMR |

- △ MATERIAL: HOUSING : POLYESTER, GRAY, UL 94V-0.
CONTACT: HIGH CURRENT COPPER ALLOY.
- △ FINISH: CONTACT MATING AREA: 1.27µm MIN GOLD OR 0.08µm MIN GOLD OVER 0.76µm PALLADIUM-NICKEL.
ACTION PIN AREA: 0.5µm MIN MATTE TIN PLATE, ALL OVER 1.27µm MIN NICKEL UNDERPLATE.
- △ TOLERANCE TO BE ±0.28 AFTER CONNECTOR IS APPLIED TO PC BOARD.
- △ DATE CODE THIS APPROXIMATE AREA, OPPOSITE SIDE.
- △ REFERENCE APPLICATION SPEC 114-1103 FOR RECOMMENDED PLATED THRU HOLE DIAMETER AND PLATING THICKNESS.
- 6. CURRENT RATING 16A/CONTACT PER PRODUCT SPEC 108-1651.
- △ FINISH: CONTACT LUBRICATION WITH BELLCORE APPROVED LUBRICANT.
TECHNICAL REFERENCE: GR-1217-CORE ISSUE 1, NOVEMBER 1995.

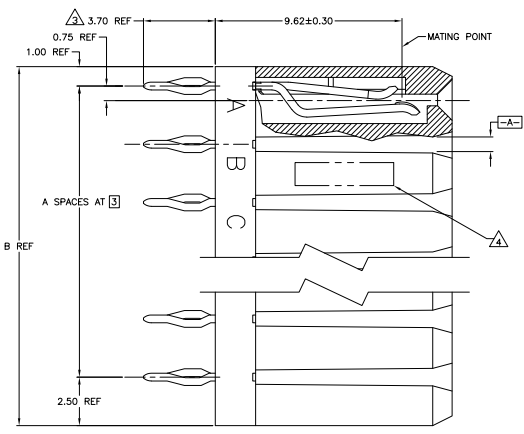
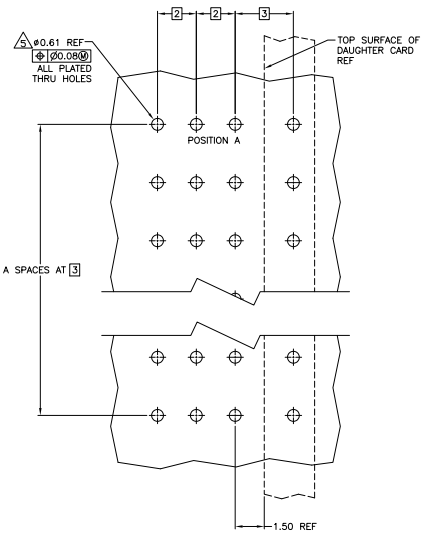
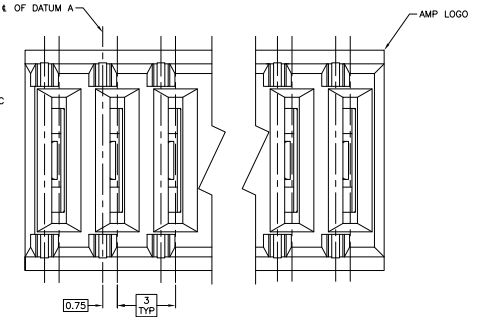
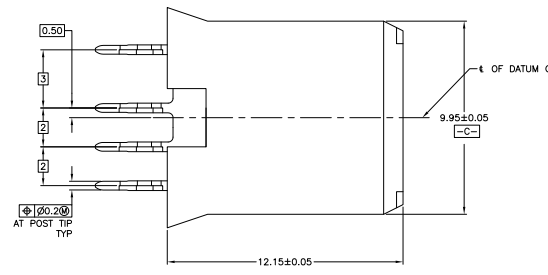
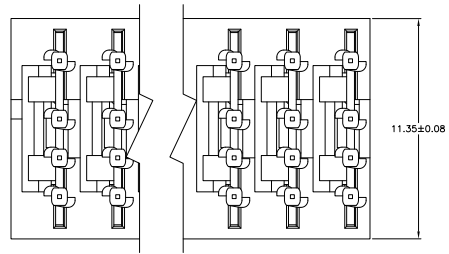

RECOMMENDED PCB HOLE LAYOUT

| | | | |
|----|------|----|----------|
| 12 | 36.5 | 11 | 120953-9 |
| 11 | 33.5 | 10 | 120953-8 |
| 10 | 30.5 | 9 | 120953-7 |
| 9 | 27.5 | 8 | 120953-6 |
| 8 | 24.5 | 7 | 120953-5 |
| 7 | 21.5 | 6 | 120953-4 |
| 6 | 18.5 | 5 | 120953-3 |
| 5 | 15.5 | 4 | 120953-2 |
| 4 | 12.5 | 3 | 120953-1 |

THIS DRAWING IS A CONTROLLED DOCUMENT. 120953

TE Connectivity
 RECEPTACLE ASSEMBLY,
 UNIVERSAL POWER MODULE

DATE: 10-11-00
 DRAWING NO: 100779
 REV: G
 PART NUMBER: 120953-1