

LOC	DIST	REVISIONS				
P	LTR	DESCRIPTION	DATE	DWN	APVD	
		3		REVISED PER ECO-09-023313	100CT09	AEG -
		4		ECR-10-001372	10MAR10	RK SRE
		5		ECR-10-025774	20JAN11	KK HMR

POLZ.	L±0.5	BESTELL-NR.
1	3.3	826 544-1
2	7.3	2
3	11.3	3
4	15.2	4
5	19.2	5
6	23.1	6
7	27.1	7
8	31.1	8
9	35.1	9
10	39.0	0
11	43.0	1
12	46.9	2
13	50.9	3
14	54.8	4
15	58.8	5
16	62.8	6
17	66.7	7
18	70.7	8
19	74.7	9
20	78.6	0
21	82.6	1
22	86.5	2
23	90.5	3
24	94.4	4
25	98.4	5
26	102.4	6
27	106.3	7
28	110.3	8
29	114.2	9
30	118.2	0
31	122.2	1
32	126.1	2
33	130.1	3
34	134.0	4
35	138.0	5
36	141.6	3-826 544-6

ZEICHNUNG GÜLTIG AB 20/90.

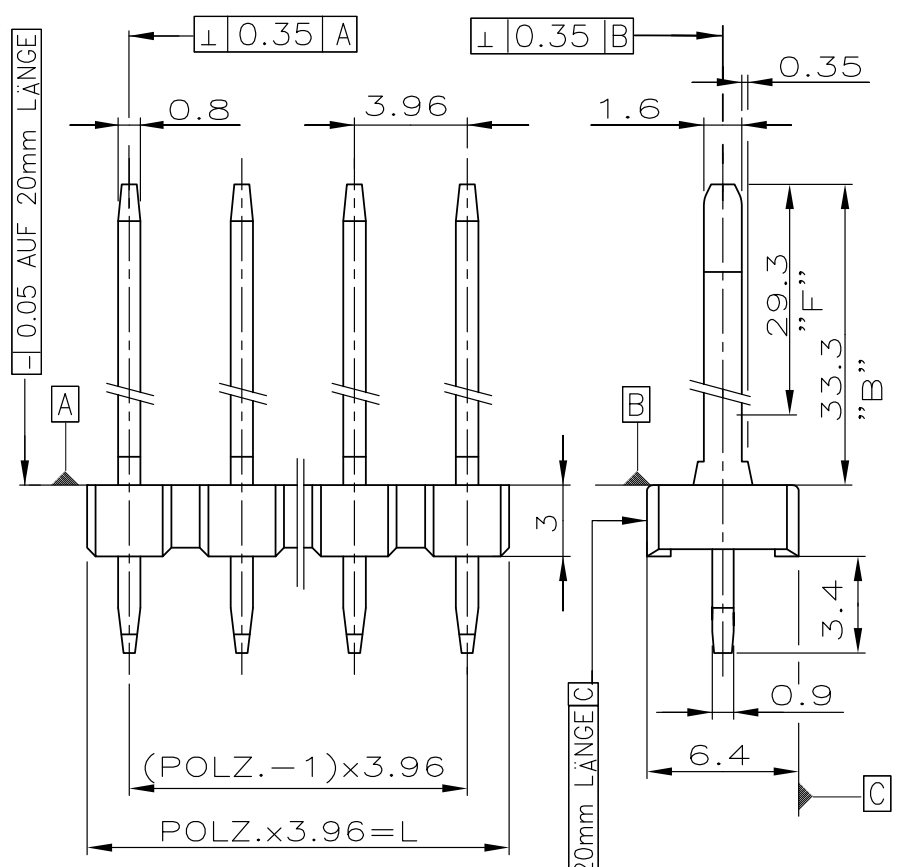

BOHRBILD

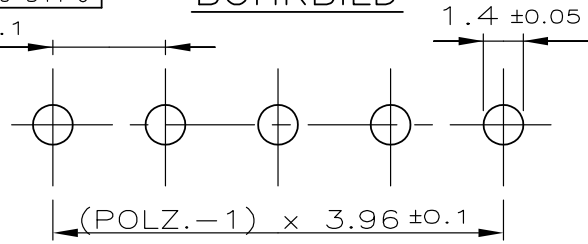

- 1 STECKSEITE: IM BEREICH "F" 0.8 μm GOLD ÜBER 1.27 μm NICKEL IM BEREICH "B"
- 2 LÖTSEITE: MIN. 2.5 μm ZINN ÜBER 1.27 μm NICKEL
- 3 OBSOLETE PARTS: OBSOLETE CIS STREAMLINING PER D.RENAUD/D.SINISI
- OBSOLETE

KONTAKTSTIFT	Cu Zn	1
STIFTGEHÄUSE	PBTP GV	GRÜN
BENENNUNG	WERKSTOFF	OBERFLÄCHE FARBE

RELEASED FOR PUBLICATION
 ALL RIGHTS RESERVED.
 VERWENDET FÜR
 THIS DRAWING IS UNPUBLISHED.
 COPYRIGHT - By -

DIMENSIONS: mm		DWN S.RIEGER 11.12.84	MATERIAL -	FINISH -		
TOLERANCES UNLESS OTHERWISE SPECIFIED: ±0.3mm		CHK SCHAARSCHMIDT 11.12.84	TE Connectivity			
0 PLC ± - 1 PLC ± - 2 PLC ± - 3 PLC ± - 4 PLC ± - ANGLES ± -		APVD -				
		PRODUCT SPEC -	NAME AMPMODU I STIFTL. RASTER 3.96 EINREIHIG			
WEIGHT -		APPLICATION SPEC -	SIZE A4	CAGE CODE 00779	DRAWING NO C-826544	RESTRICTED TO -
CUSTOMER DRAWING			SCALE 4:1	SHEET 1 OF 1	REV 5	