

REV	DATE	DESCRIPTION	BY	CHK	APP
0	REL. PER 0600-2664-94				
A	REL. -2, PER 0600-3553-95				
B	REVISED PER 0600-3710-95				

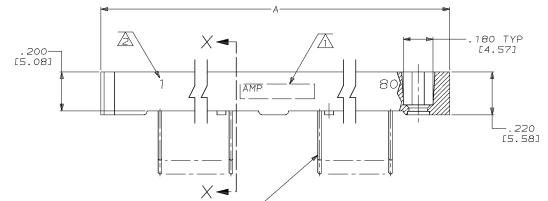

CONTACTS (QTY=160)
 MAT'L: Be Cu PER QQ-C-533

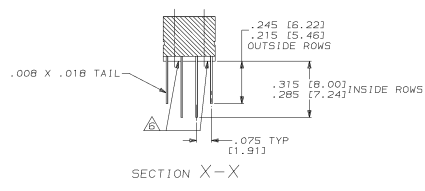
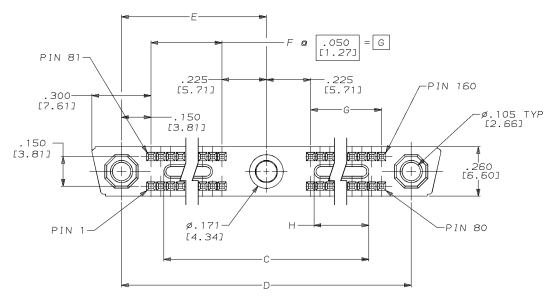
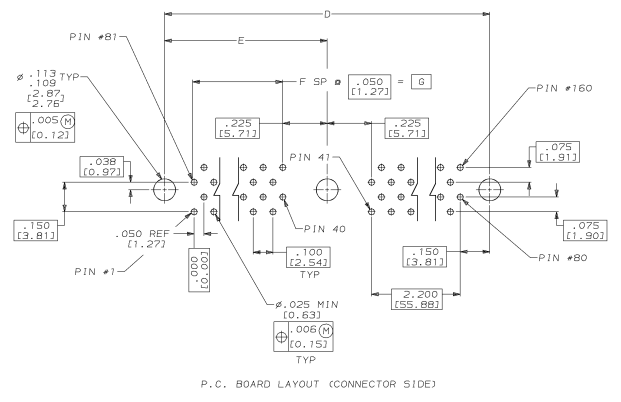
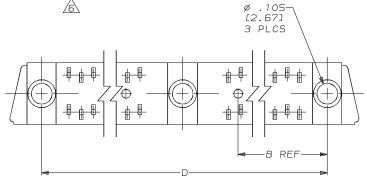

- △ AMP, AMP PART NUMBER, CAGE CODE, CUSTOMER PART NUMBER AND DATE CODE MARKED IN THIS APPROXIMATE AREA.
- △ NUMBERS INDICATING END POSITIONS MARKED THIS SIDE ONLY.
- 3. MEETS ALL APPLICABLE REQUIREMENTS OF MIL-C-55302.
- △ FINISH: .000050 (0.0012) GOLD PER MIL-G-45204 OVER NICKEL PER QQ-N-290 IN CONTACT AREA. REMAINDER OF CONTACT TIN-LEAD OVER NICKEL.
- △ HOUSING MATERIAL: LIQUID CRYSTAL POLYMER PER MIL-M-24519, GLCP-30F; COLOR, GRAY.
- △ BOTTOM SURFACE OF HOUSING SEALED.

CUSTOMER PART NUMBER	CONTACT IDENT NUMBERS	H	G	F	E	D	C	B	A	NUMBER OF CONTACTS	PART NUMBER
13328436	1 & 80	1.800 [45.72]	1.950 [49.53]	39	2.325 [59.06]	4.650 [118.11]	4.200 [106.68]	1.162 [29.51]	4.950 [125.73]	160	443040-2
34103972-00	1 & 80	1.800 [45.72]	1.950 [49.53]	39	2.325 [59.06]	4.650 [118.11]	4.200 [106.68]	1.162 [29.51]	4.950 [125.73]	160	443040-1

DESIGNED BY	ALEXANDER	DATE	9-16-94
DRWING ENGINEER	GUTIER	DATE	9-16-94
CHECKED BY	GUTIER	DATE	9-16-94
APPROVED BY		DATE	
WORK CENTER		ORDER CODE	443040
REV		ISSUE	4.1