

DRAWING MADE IN THIRD ANGLE PROJECTION
 THIS DRAWING IS UNPUBLISHED. RELEASED FOR PUBLICATION
 © COPYRIGHT 19 BY AMP INCORPORATED. ALL INTERNATIONAL RIGHTS RESERVED.

REV. NO.		DATE	APPROV.	DESCRIPTION
B	REV PER 0600-0297-93	TA	12-21-90	DG
C	REV PER 0600-3448-95	TA	1-17-96	DG

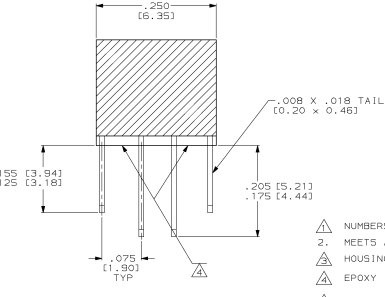
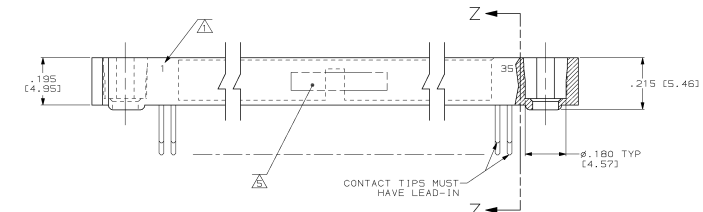
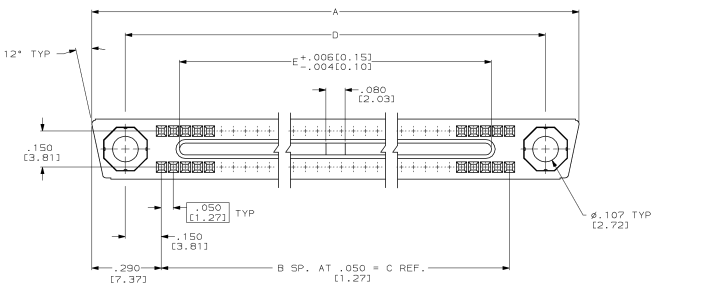

- 1. NUMBERS INDICATING END POSITIONS MARKED THIS SIDE ONLY.
- 2. MEETS ALL APPLICABLE REQUIREMENTS OF MIL-C-55302.
- 3. HOUSING MAT'L: LIQUID CRYSTAL POLYMER PER MIL-M-24519, GLCP-30F; COLOR: GRAY.
- 4. EPOXY IS ADDED TO BOTTOM OF HOUSING FOR SEALING.
- 5. AMP, 00779, PART NO. MILITARY P/N AND DATE CODE MARKED IN THIS APPROXIMATE AREA.

SECTION Z-Z
 SCALE 10:1

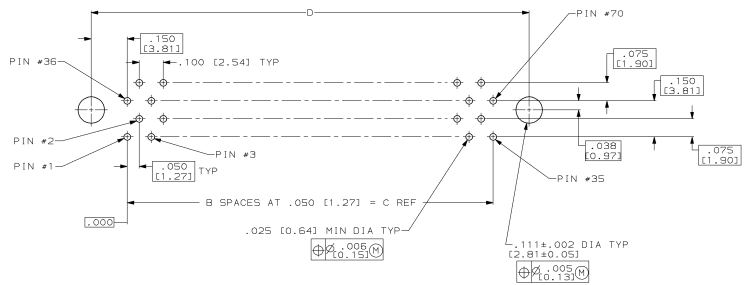

RECOMMENDED P.C. BOARD HOLE PATTERN
 (CONNECTOR SIDE)

M55302/119-08	1 - 35	1.550 (39.37)	2.000 (50.80)	1.700 (43.18)	34	2.280 (57.91)	70	447784-1
MILITARY P/N	CAVITY ID	E	D	C	B	A	POSN.	PART NO
DO NOT SCALE PRINT. UNLESS SPECIFIED, DIMENSIONS IN INCHES (mm) 1/16 INCHES = .015625 INCHES 1/32 INCHES = .03125 INCHES 1/64 INCHES = .015625 INCHES 1/128 INCHES = .0078125 INCHES		DR C.C. THOMAS 3-19-91		CHK 3-20-91 0.0UTTER		AMP INCORPORATED Harrisburg, Pa. 17108		
MATERIAL: HOUSING, 3		APPRO 3-20-91 0.0UTTER		PRODUCT SPEC -		RCPT ASSY, SEALED, MINI-BOX MILITARY, WITH LOW FORCE CONTACTS		
FINISH: .000050 GOLD IN CONTACT AREA, TIN-LEAD ON TAILS		APPLICATION SPEC -		SIZE: D		P/SR NO: 00779 DRAWING NO: 447784		
WEIGHT: -		SCALE: 5:1		SHEET: 1 OF 1		CUSTOMER DRAWING		