

SEE SHEET 1 FOR REVISION

SPECIFICATIONS:

MATERIALS:

- A. SHELL ALUMINUM ALLOY PER QQ-A-591
- B. ADAPTER SCREW STAINLESS STEEL PER QQ-S-763, 300 SERIES
- C. ADAPTER NUT STAINLESS STEEL PER QQ-S-763, 300 SERIES
- D. STANDARD PANEL GASKET SILICONE ELASTOMER PER MIL-R-25988
- E. INSERT HIGH GRADE POLYARYLENE THERMOPLASTIC
- F. INTERFACIAL SEAL SILICONE ELASTOMER PER MIL-R-25988
- G. KEYING PIN HIGH GRADE POLYARYLENE THERMOPLASTIC
- H. PIN CONTACT COPPER ALLOY PER QQ-B-750
- I. PANEL WASHER STAINLESS STEEL PER QQ-S-763, 300 SERIES
- J. KEYING PIN INSERT HIGH GRADE POLYARYLENE THERMOPLASTIC

FINISH:

APPLIES TO CADMIUM PLATED CONNECTORS

- A. SHELL CADMIUM PLATED PER QQ-P-416 OVER NICKEL UNDERPLATE
- B. ADAPTER SCREW CADMIUM PLATED PER QQ-P-416
- C. ADAPTER NUT CADMIUM PLATED PER QQ-P-416
- D. PANEL WASHER CADMIUM PLATED PER QQ-P-416
- E. PIN CONTACT ENGAGING END - GOLD PLATED PER MIL-G-45204 TYPE 1, GRADE C, CLASS 1
TERMINATION POST - TINNED WITH Sn63 SOLDER PER QQ-S-571

DESIGN AND CONSTRUCTION:

THE CONNECTORS SPECIFIED HEREIN ARE PANEL MOUNTED RECEPTACLES WITH FIXED (NON REMOVABLE) PIN INSERTS AND CONTACTS. THE CONNECTOR IS WITHOUT PROVISIONS FOR CABLE CLAMPS OR TERMINATION SEALS.

PERFORMANCE:

THE APPLICABLE RAYCHEM SPECIFICATION FOR THIS PART IS C6111. THIS PART IS NOT QUALIFIED TO C6111.

HUMIDITY ALTITUDE IMMERSION } THE CONNECTOR TERMINATION END MUST BE SUITABLY PROTECTED FOR TESTING OR APPLICATION IN ANY OF THESE ENVIRONMENTS.
ALTITUDE-LOW TEMPERATURE
FLUID IMMERSION

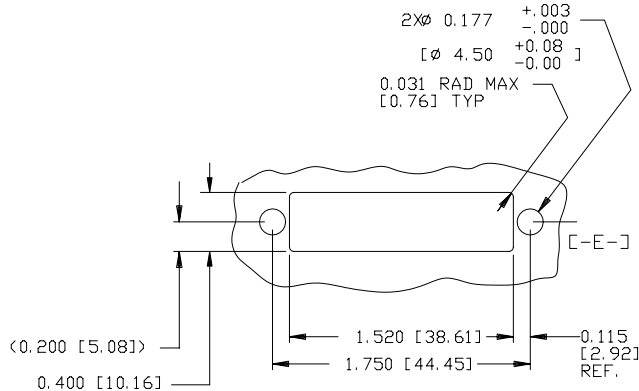

RECOMMENDED PANEL CUT-OUT

PANEL THICKNESS	NUMBER OF PANEL WASHERS FOR EACH FASTENER
0.031/0.036 [0.81/0.91]	2
0.062/0.067 [1.57/1.71]	1
0.093/0.097 [2.31/2.41]	0

WEIGHT (lbs. [gr.]) MAX.	
CONNECTOR SIZE	FLANGED
1 INCH	0.044 [19.96]

DRAWN	DATE	SIZE	CODE IDENT. NO.	DWG. NO.	REV.
ISSUED	DATE	A	06090	MTC100-BY1-013	B
DO NOT SCALE THIS DRAWING FROM 008111-2.DWG SHEET 2 OF 2					

SHEET 2
DWG. NO. MTC100-BY1-013