

REV	DESCRIPTION	DATE	BY	CHK
00	INITIAL DESIGN			
01	CONVERTED FROM 1738228-1			
02	REVISION			
03	REVISION			

△ SHELL & KEY RETENTION PLATE: ALUMINUM ALLOY
 QUARTER-TURN FASTENER: COPPER ALLOY PER ASTM B196
 INSERT RETENTION CLIP, CURVED WASHER & FASTENER RETENTION CLIP: COPPER ALLOY PER ASTM B194
 CAPTIVE SCREW: STAINLESS STEEL PER AISI 303
 SCREW RETENTION CLIPS: STAINLESS STEEL PER AISI 304
 PROTECTIVE COVER: THERMOPLASTIC ELASTOMER
 POLARIZATION KEY: PEI THERMOPLASTIC PER ASTM D5205

- △ SHELL: ELECTROLESS NICKEL PER SAE AMS-C-26074, CLASS 1.
KEY RETENTION PLATE: ANODIZED, CLEAR
- △ DATE CODE - YEAR & WEEK (YY WW)
- △ 4-40 CAPTIVE SCREWS ON KEY RETENTION PLATE
RECOMMENDED LOCKING TORQUE: 0.8 N.m [7in-lb]
- △ THE POLARIZATION KEYS & RETENTION PLATE ARE SHIPPED UNASSEMBLED.
- △ SHELL CAVITY FOR GPRA SERIES INSERTS WITH KEYING CODE A.

7. DESCRIPTIVE PART NUMBER: GPRA1PB04N
 SERIES: GPRA
 SHELL SIZE: 1 (SINGLE-CAVITY SHELL)
 SHELL STYLE: P (PLUG)
 MODIFICATION CODE: B (NO MOUNTING HOLES)
 LOCKING DEVICE: 0 (QUARTER-TURN FASTENER)
 POLARIZATION CODE: 4 (KIT, WITH POLARIZING HARDWARE UNASSEMBLED)
 SHELL PLATING: N (NICKEL PLATING)

8. THIS PRODUCT IS SOLD BY TYCO ELECTRONICS UNDER A LICENSE FROM RADIALL SA.

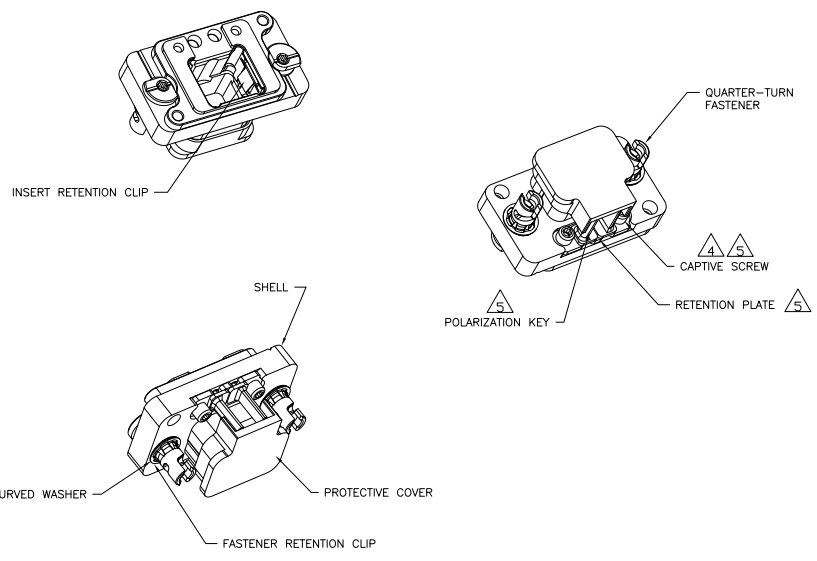
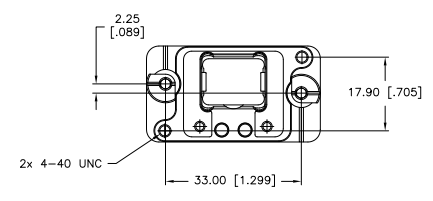
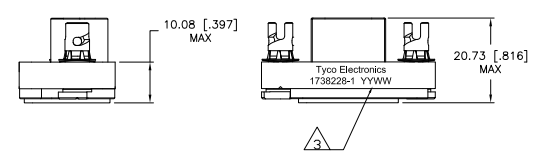
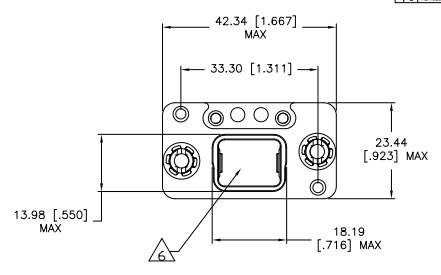

THIS PRINT IS
PRELIMINARY
 UNQUALIFIED PRODUCT
 CONTACT PRODUCT ENGINEERING
 BEFORE USING THIS PRINT

THIS DRAWING IS A CONTROLLED DOCUMENT		DATE	BY	CHK	REV	DESCRIPTION
1738228-1	1738228-1				00	INITIAL DESIGN
					01	CONVERTED FROM 1738228-1
					02	REVISION
					03	REVISION

REV	DESCRIPTION	DATE	BY
00	1758228-1	-	-

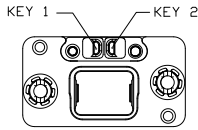

CODE NUMBER 08 SHOWN: B-D
 POLARIZATION KEY 1 —┐ POLARIZATION KEY 2

PLUG CONNECTOR POLARIZATION

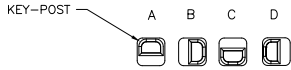

CODE NUMBER	KEY 1	KEY 2
01	A	A
02	A	B
03	A	C
04	A	D
05	B	A
06	B	B
07	B	C
08	B	D
09	C	A
10	C	B
11	C	C
12	C	D
13	D	A
14	D	B
15	D	C
16	D	D

KEY-POST ORIENTATION

THIS PRINT IS
PRELIMINARY
 UNQUALIFIED PRODUCT
 CONTACT PRODUCT ENGINEERING
 BEFORE USING THIS PRINT

PART NUMBER
 1758228-1

THE DRAWING IS A CONTROLLED DOCUMENT	DATE	REV	BY	APP	REV	DATE	BY	APP
REVISION	DATE	BY	APP	DATE	BY	APP	DATE	BY
1								
CUSTOMER CHANGE			AO1007740-1758228			1758228-1		