

4

3

2

1

THIS DRAWING IS UNPUBLISHED. RELEASED FOR PUBLICATION .19		
© COPYRIGHT 19 BY AMP INCORPORATED. ALL RIGHTS RESERVED.		
DESCRIPTION	MATERIAL	FINISH
GROMMET	FLUOROSILICONE	MIL-T-81714, CLASS D, BLUE
SPLICE ASSEMBLY HOUSING	EPIALL TYPE 1908	MIL-T-81714, CLASS D, BLACK
TUBE SHRINK	PER MIL-1-23053/8	COLOR TRANSPARENT
CONTACT FEMALE SOCKET	BERYLLIUM COPPER PER ASTM-B194	GOLD PLATE PER MIL-G-45204
RETENTION CLIP	BERYLLIUM COPPER PER ASTM-B194 OR SST PER QQ-S-766	NONE
CONTACTS PIN	COPPER ALLDY PER MIL-C-39029/1	GOLD PLATE PER MIL-G-45204

LOC	DIST	REVISIONS					
DF	A0	F	LYR	DESCRIPTION	DATE	BY	APPV
		B		REV PER 0600-5711-96	2-98	TT	DM

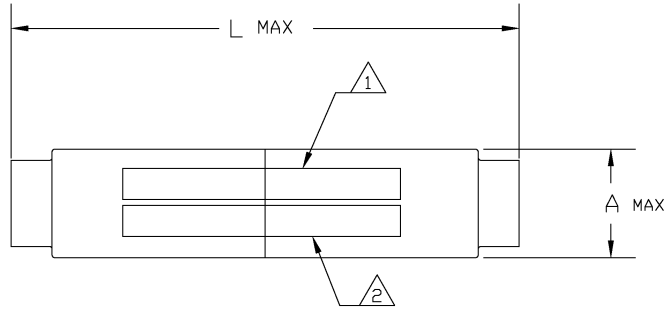
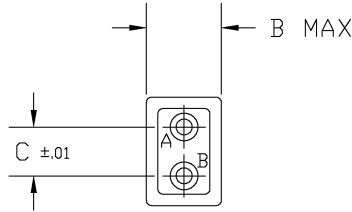

- ⚠ MARK WIRE SPLICE MARKED WITH 'AMP', AMP PART NO., AND DATE CODE AT APPROXIMATE AREA SHOWN.
- ⚠ MARK CUSTOMER/MILITARY PART NUMBER MARKED AT APPROXIMATE AREA SHOWN.
- ⚠ A QUANTITY OF 4 M39029/1-100 PIN CONTACTS ARE SUPPLIED WITH WIRE SPLICE.
- ⚠ A QUANTITY OF 4 M39029/1-101 PIN CONTACTS ARE SUPPLIED WITH WIRE SPLICE.
- ⚠ A QUANTITY OF 4 M39029/1-102 PIN CONTACTS ARE SUPPLIED WITH WIRE SPLICE.

1552	.13	.275	.400	⚠	CLASS D		22	592588-6	
1552	.13	.275	.400	⚠	CLASS D		20	592588-5	
1922	.18	.300	.500	⚠	CLASS D		16	592588-4	
SUPSD BY -4	1922	.18	.300	.500	⚠	CLASS D	M81714/12-16D-1	16	592588-3
SUPSD BY -5	1552	.13	.275	.400	⚠	CLASS D	M81714/12-20D-1	20	592588-2
SUPSD BY -6	1552	.13	.275	.400	⚠	CLASS D	M81714/12-22D-1	22	592588-1
L	C	B	A	REMARKS	MIL-T-81714 CLASS	MILITARY/CUSTOMER PART #	SIZE		

THIS DRAWING IS A CONTROLLED DOCUMENT

AMP INCORPORATED
Harrisburg, PA 17105-3608A

WIRE SPLICE ASSY, T.J. MILITARY, CLASS D

SIZE: A2 00779 C-592588

SCALE: 1:1 SHEET: 1 OF 1 REV: B