

4

3

2

1

THIS DRAWING IS UNPUBLISHED. RELEASED FOR PUBLICATION. ALL RIGHTS RESERVED.

LOC	DIST	REVISIONS		
P	LR	DESCRIPTION	DATE	BY
Y		REV PER ECO 11-004686	4-4-11	CT RL

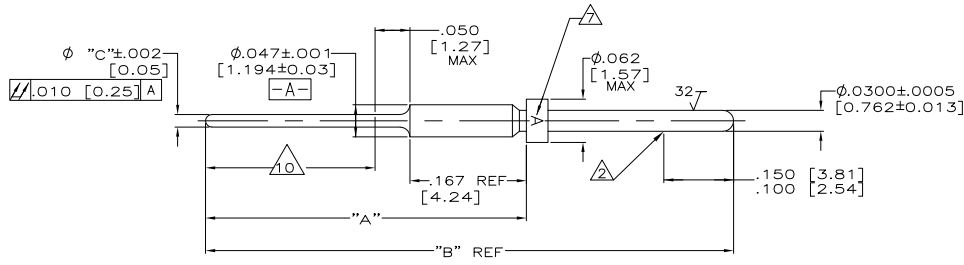

1. INSERTION/EXTRACTION TOOL AMP P/N 91067-1.
- △ POINT OF PLATING THICKNESS MEASUREMENT.
- △ FINISH: .000050 [0.00127] MIN THK GOLD PLATED PER ASTM-B-488, TYPE 3, CODE C, CLASS 1.25 OVER .000100 [0.00254] TO .000150 [0.00381] THK COPPER PER MIL-C-14550, CLASS IV.
- △ FINISH: .000050 [0.00127] MIN THK GOLD PLATED PER ASTM-B-488, TYPE 3, CODE C, CLASS 1.25 OVER .000050 [0.00127] TO .000150 [0.00381] THK NICKEL PER QQ-N-290.
- △ FINISH: .000050 [0.00127] MIN THK GOLD PLATED PER ASTM-B-488, TYPE 3, CODE C, CLASS 1.25 OVER .000200 [0.00508] TO .000250 [0.00635] THK NICKEL PER QQ-N-290.
6. CONTACTS MEET ALL APPLICABLE PERFORMANCE REQUIREMENTS OF MIL-C-39029.
- △ GOTHIC "A" LOCATED APPROX AS SHOWN.
- △ CONTACT BODY MAT'L: LEADED NICKEL COPPER (PROPRIETARY) EQUIVALENT ALTERNATE MAT'L: COPPER ALLOY PER ASTM-B-197
- △ FINISH: .000100 [0.00254] MIN THK GOLD PLATED PER ASTM-B-488, TYPE 3, CODE C, CLASS 1.25 OVER .000050 [0.00127] TO .000150 [0.00381] THK NICKEL PER QQ-N-290.
- △ SOLDER DIP WITH 63/37 TIN-LEAD. MUST MEET SOLDERABILITY REQUIREMENT OF MIL-STD-202, METHOD 208.

△	.018 [0.46]	.735 [18.67]	.435 [11.05]	2-207683-7
△	.018 [0.46]	.642 [16.31]	.345 [8.76]	2-207683-3
△	.018 [0.46]	.707 [17.96]	.410 [10.41]	2-207683-1
△	.018 [0.46]	.707 [17.96]	.410 [10.41]	2-207683-0
△	.018 [0.46]	.665 [16.89]	.368 [9.35]	1-207683-8
△	.018 [0.46]	.760 [19.30]	.460 [11.68]	1-207683-4
△	.018 [0.46]	.860 [21.84]	.560 [14.22]	1-207683-3
△	.025 [0.64]	.860 [21.84]	.560 [14.22]	1-207683-2
△	.018 [0.46]	.760 [19.30]	.460 [11.68]	1-207683-1
△	.018 [0.46]	1.107 [28.12]	.810 [20.57]	207683-9
△	.025 [0.64]	.860 [21.84]	.560 [14.22]	207683-8
△	.018 [0.46]	.760 [19.30]	.460 [11.68]	207683-6
△	.018 [0.46]	1.107 [28.12]	.810 [20.57]	207683-4
△	.018 [0.46]	.860 [21.84]	.560 [14.22]	207683-2
FINISH	ϕ "C"	"B"	"A"	PART NO

THIS DRAWING IS A CONTROLLED DOCUMENT.

DESIGNED BY: T. ALEXANDER 11-11-91	TE Connectivity
OK'D BY: F. KINSEY 11-19-91	
APPROVED BY: F. KINSEY 11-19-91	
PRODUCT SPEC: -	
APPLICATION SPEC: -	
WEIGHT: -	
MATERIAL: -	
FINISH: -	
SIZE: A2	CAGE CODE: 00779
DRAWING NO: C-207683	RESTRICTED TO: -
CUSTOMER DRAWING	SCALE: 10:1 SHEET: 1 of 1 REV: Y

207683

A