

REV	DATE	DESCRIPTION	BY	APP
DF	DO			
E		REVISED PER ECO-09-013174		10-04-08 CT RL

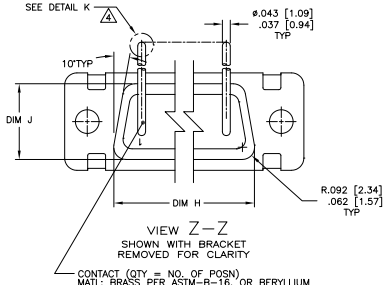

CONTACT (QTY = NO. OF POSN)
 MAT'L: BRASS PER ASTM-B-16, OR BERYLLIUM COPPER PER ASTM-B-194
 FINISH: GOLD PER MIL-G-45204, TYPE II, GRADE C, CLASS I IN CONTACT MATING AREA, .000010 [0.0003] MIN THK GOLD PER MIL-G-45204 OVER .000050 [0.0013] MIN THK NICKEL PER QQ-N-290 ON CONTACT BODY

- △ SEE SHEET 2 FOR RECOMMENDED P.C. BOARD LAYOUT. TRUE POSITION TOLERANCE FOR P.C. BOARD LAYOUT IS .010 [0.25] AT MAX MATERIAL CONDITION. SUGGESTED BOARD THICKNESS IS .062 [1.57]
- 2. THE CONNECTORS DESCRIBED IN THIS DOCUMENT MEET THE REQUIREMENTS OF MIL-C-24308 AND MATE WITH ANY RECEPTACLE CONNECTOR WITH SAME INSERT ARRANGEMENT.
- △ MARKED WITH .047 [1.19]-.062 [1.57] HIGH CHARACTERS. FAR SIDE REFERS TO THE WIDE SIDE OF THE KEYSTONE. NEAR SIDE REFERS TO THE NARROW SIDE OF THE KEYSTONE. IF THE FRONT SHELL IS TOO SMALL FOR "TE", TE PART NUMBER AND DATE CODE, MARKING SHALL BE SPLIT AS FOLLOWS:
 - A. TE PART NUMBER ON REAR SHELL, FAR SIDE.
 - B. "TE" AND DATE CODE ON FRONT SHELL, FAR SIDE.
- △ REQUIREMENT FOR FULL PIN DIAMETER EXTENSION: .159 [4.04] MIN, SHELL SIZES 1 AND 2, .150 [3.81] MIN, SHELL SIZES 3, 4 AND 5.
- 5. THIS DRAWING SHALL BE INTERPRETED IN ACCORDANCE WITH APPLICABLE STANDARDS LISTED IN MIL-STD-100.
- △ SOLDER DIPPED PER MIL-STD-2000 COMPOSITION Sn63 CONFORMING TO QQ-S-571 IN THE ENTIRE AREA OF DIMENSION SHOWN. 1218836-6 THRU -10 ONLY.

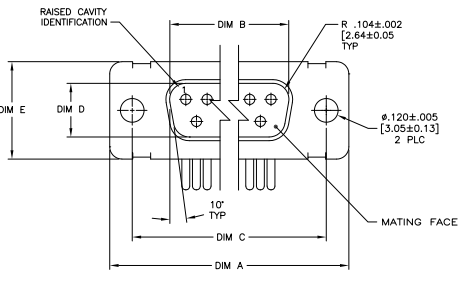
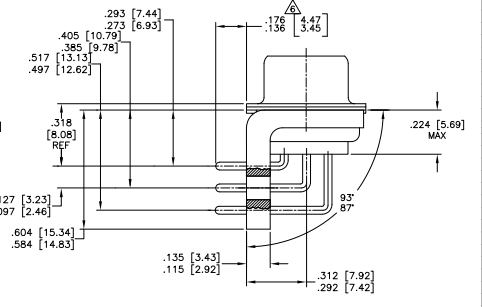
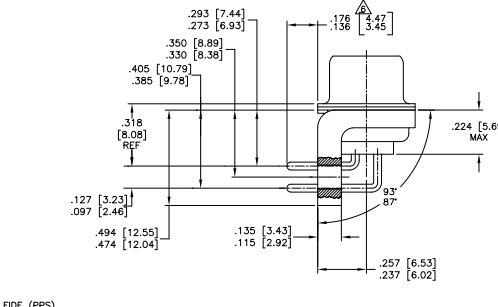
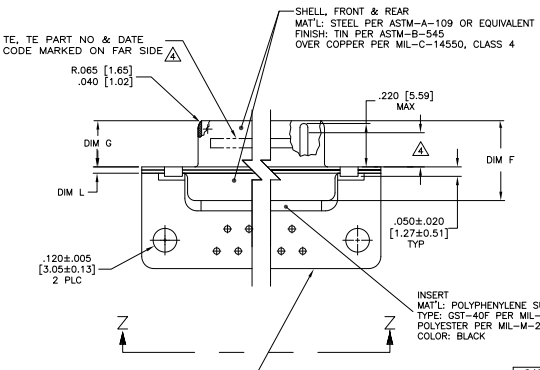

SHELL SIZES 1 THRU 4 CONTACT CONFIGURATION

SHELL SIZE 5 CONTACT CONFIGURATION

DIM L	DIM J	DIM H	DIM G	DIM F	DIM E	DIM D	DIM C	DIM B	DIM A	INSERT ARRANGEMENT	No. OF POS	SHELL SIZE	TE PART NO.
.049 [1.24]	.544 [13.82]	2.188 [55.58]	.236 [5.99]	.436 [11.07]	.620 [15.75]	.446 [11.33]	2.411 [61.24]	2.084 [52.55]	2.850 [72.51]	MS18277-1	50	5	1-1218836-0
.029 [0.74]	.524 [13.31]	2.168 [55.07]	.224 [5.69]	.416 [10.57]	.590 [14.99]	.436 [11.07]	2.401 [60.99]	2.074 [52.30]	2.820 [71.66]	MS18276-1	37	4	1218836-9
.049 [1.24]	.432 [10.97]	2.282 [57.96]	.236 [5.99]	.436 [11.07]	.509 [12.93]	.334 [8.48]	2.505 [63.63]	2.187 [54.97]	2.744 [69.70]	MS18275-1	25	3	1218836-8
.029 [0.74]	.412 [10.46]	2.262 [57.45]	.224 [5.69]	.416 [10.57]	.509 [12.93]	.334 [8.48]	2.495 [63.37]	2.177 [54.71]	2.714 [68.84]	MS18274-1	15	2	1218836-7
.049 [1.24]	.432 [10.97]	2.282 [57.96]	.236 [5.99]	.436 [11.07]	.509 [12.93]	.334 [8.48]	2.505 [63.63]	2.187 [54.97]	2.744 [69.70]	MS18273-1	9	1	1218836-5
.029 [0.74]	.412 [10.46]	2.262 [57.45]	.224 [5.69]	.416 [10.57]	.509 [12.93]	.334 [8.48]	2.495 [63.37]	2.177 [54.71]	2.714 [68.84]	MS18272-1	50	5	1218836-6
.049 [1.24]	.432 [10.97]	2.282 [57.96]	.236 [5.99]	.436 [11.07]	.509 [12.93]	.334 [8.48]	2.505 [63.63]	2.187 [54.97]	2.744 [69.70]	MS18271-1	37	4	1218836-4
.029 [0.74]	.412 [10.46]	2.262 [57.45]	.224 [5.69]	.416 [10.57]	.509 [12.93]	.334 [8.48]	2.495 [63.37]	2.177 [54.71]	2.714 [68.84]	MS18270-1	25	3	1218836-3
.049 [1.24]	.432 [10.97]	2.282 [57.96]	.236 [5.99]	.436 [11.07]	.509 [12.93]	.334 [8.48]	2.505 [63.63]	2.187 [54.97]	2.744 [69.70]	MS18269-1	15	2	1218836-2
.029 [0.74]	.412 [10.46]	2.262 [57.45]	.224 [5.69]	.416 [10.57]	.509 [12.93]	.334 [8.48]	2.495 [63.37]	2.177 [54.71]	2.714 [68.84]	MS18268-1	9	1	1218836-1

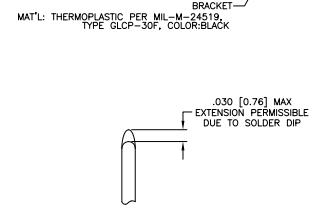

DETAIL K
 SCALE: 8:1
 FOR 1218836-6 THRU -10 ONLY

THIS DRAWING IS A CONTROLLED DOCUMENT. TYS ELECTRONICS CORPORATION, Harrisburg, PA 17105-3608

REVISIONS: 1. PLUG ASSY, AMPHITE, RIGHT ANGLE, SERIES 109, SIZE 1 THRU 5

DATE: 10/07/09

CUSTOMER DRAWING: 1218836

THIS DRAWING IS UNAPPROVED
 UNLESS INDICATED OTHERWISE BY THE DESIGN ENGINEER
 © 2008 TYS
 ALL RIGHTS RESERVED

REV	DATE	DESCRIPTION	BY	APP'D
DF	DO	SEE SHEET 1	-	-

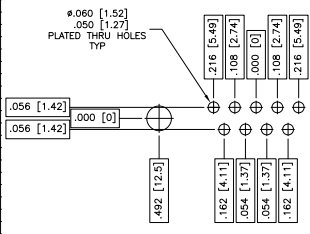

RECOMMENDED P.C. BOARD LAYOUT
 SHELL SIZE 1 (9 POSITION)

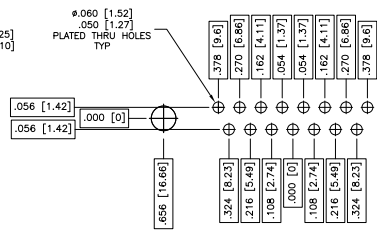

RECOMMENDED P.C. BOARD LAYOUT
 SHELL SIZE 2 (15 POSITION)

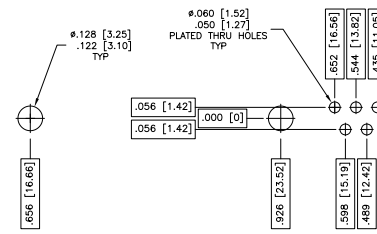

RECOMMENDED P.C. BOARD LAYOUT
 SHELL SIZE 3 (25 POSITION)

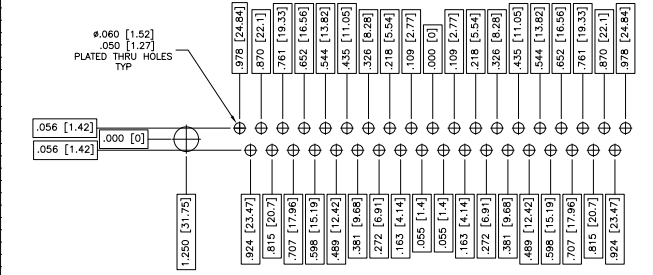

RECOMMENDED P.C. BOARD LAYOUT
 SHELL SIZE 4 (37 POSITION)

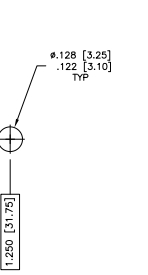

RECOMMENDED P.C. BOARD LAYOUT
 SHELL SIZE 5 (50 POSITION)

THIS DRAWING IS A CONTROLLED DOCUMENT.		DESIGNED BY: J. THOMAS	DATE: 11/10/08
DRAWN BY: J. THOMAS		CHECKED BY: J. THOMAS	DATE: 11/10/08
APPROVED BY: J. THOMAS		DATE: 11/10/08	REVISED BY: J. THOMAS
SEE CALLOUTS		CUSTOMER DRAWING	DATE: 11/10/08
TYS Electronics Corporation Harrisburg, PA 17105-3608		PLUG ASSY-AMPLITE-RIGHT ANGLE, SERIES 109, SIZE 1 THRU 5	REVISED TO: ---
SIZE: A1	DATE: 11/10/08	DRAWING NO: 1218836	REVISED TO: ---
SHEET: 4-1		TOTAL SHEETS: 2	REVISED TO: ---

488 (1/08)