

- △ SEE SHEET 2 FOR RECOMMENDED P.C. BOARD LAYOUT. TRUE POSITION TOLERANCE FOR P.C. BOARD LAYOUT IS .010 [0.25] AT MAX MATERIAL CONDITION. SUGGESTED BOARD THICKNESS IS .125 [3.18]
- △ THE CONNECTORS DESCRIBED IN THIS DOCUMENT MATE WITH ANY RECEPTACLE CONNECTOR WITH THE SAME INSERT ARRANGEMENT.
- △ MARKED WITH .047 [1.19]-.062 [1.57] HIGH CHARACTERS. FAR SIDE REFERS TO THE WIDE SIDE OF THE KEYSTONE. NEAR SIDE REFERS TO THE NARROW SIDE OF THE KEYSTONE. IF THE FRONT SHELL IS TOO SMALL FOR "AMP", AMP PART NUMBER AND DATE CODE, THEN SPLIT AS FOLLOWS:
 A. AMP PART NUMBER ON REAR SHELL, NEAR SIDE.
 B. "AMP" AND DATE CODE ON FRONT SHELL, NEAR SIDE.
- △ REQUIREMENT FOR FULL PIN DIAMETER EXTENSION:
 .159 [4.04] MIN, SHELL SIZES 1 AND 2.
 .150 [3.81] MIN, SHELL SIZES 3 AND 4.
- △ SOLDER DIPPED PER MIL-STD-2000 COMPOSITION Sn63 CONFORMING TO QQ-S-571. COVERAGE SHALL BE COMPLETE TO A DISTANCE .020 [0.51] MAX FROM INSERT ASSEMBLY.
- △ SPACERS (QTY 2) ARE SUPPLIED WITH CONNECTORS (NOT ATTACHED TO THE CONNECTOR).
- 7. DIMENSIONS APPLY PRIOR TO SOLDER DIPPING.

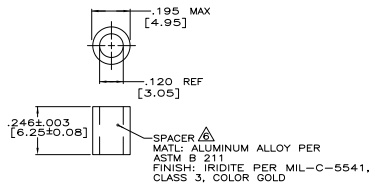

N	M	L	J	H	G	F	E	D	C	B	A	INSERT ARRANGEMENT	NO OF POS	SHELL SIZE	AMP P/N ON CONNECTOR	PART NUMBER
.033 [0.84]	.208 [5.28]	.049 [1.24]	.544 [13.82]	2.188 [55.58]	.236 [5.99]	.436 [11.07]	.620 [15.75]	.448 [11.33]	2.411 [61.24]	2.084 [52.93]	2.650 [67.31]	MS18277-1	50	5	1-1218379-0	1-1218379-0
.027 [0.69]	.188 [4.77]	.029 [0.74]	.524 [13.31]	2.168 [55.07]	.224 [5.69]	.416 [10.57]	.590 [14.99]	.436 [11.07]	2.401 [60.99]	2.074 [52.66]	2.620 [66.50]	MS18276-1	50	5	1-1218379-9	1-1218379-9
.033 [0.84]	.208 [5.28]	.049 [1.24]	.432 [10.97]	2.282 [57.96]	.236 [5.99]	.436 [11.07]	.509 [12.93]	.334 [8.48]	2.505 [63.63]	2.187 [55.50]	2.744 [69.70]	MS18275-1	37	4	1-1218378-8	1-1218378-8
.027 [0.69]	.188 [4.77]	.029 [0.74]	.412 [10.46]	2.262 [57.45]	.224 [5.69]	.416 [10.57]	.509 [12.93]	.334 [8.48]	2.496 [63.37]	2.177 [55.30]	2.714 [68.94]	MS18274-1	15	2	1-1218379-7	1-1218379-7
.033 [0.84]	.208 [5.28]	.049 [1.24]	.432 [10.97]	1.635 [41.53]	.236 [5.99]	.436 [11.07]	.509 [12.93]	.334 [8.48]	1.857 [47.17]	1.529 [38.84]	2.073 [52.66]	MS18273-1	9	1	1-1218379-5	1-1218379-5
.027 [0.69]	.188 [4.77]	.029 [0.74]	.412 [10.46]	1.615 [41.02]	.224 [5.69]	.416 [10.57]	.479 [12.17]	.324 [8.23]	1.847 [46.91]	1.529 [38.84]	2.073 [52.66]	MS18272-1	37	4	1-1218379-4	1-1218379-4
.033 [0.84]	.208 [5.28]	.049 [1.24]	.432 [10.97]	1.073 [27.25]	.229 [5.82]	.412 [10.46]	.479 [12.17]	.324 [8.23]	1.307 [33.20]	.989 [25.12]	1.128 [28.43]	MS18271-1	15	2	1-1218379-2	1-1218379-2
.027 [0.69]	.188 [4.77]	.029 [0.74]	.412 [10.46]	1.053 [26.74]	.229 [5.82]	.412 [10.46]	.479 [12.17]	.324 [8.23]	1.307 [33.20]	.989 [25.12]	1.128 [28.43]	MS18270-1	9	1	1-1218379-1	1-1218379-1

THIS DRAWING IS A CONTROLLED DOCUMENT. IT IS THE PROPERTY OF TTI ELECTRONICS CORPORATION. IT IS TO BE KEPT IN CONFIDENCE AND NOT TO BE REPRODUCED OR TRANSMITTED IN ANY FORM OR BY ANY MEANS, ELECTRONIC OR MECHANICAL, INCLUDING PHOTOCOPYING, RECORDING, OR BY ANY INFORMATION STORAGE AND RETRIEVAL SYSTEM. WITHOUT THE WRITTEN PERMISSION OF TTI ELECTRONICS CORPORATION.

DATE: 07/10/08
 DRAWN BY: [Signature]
 CHECKED BY: [Signature]
 APPROVED BY: [Signature]

CUSTOMER DRAWING: 1218379

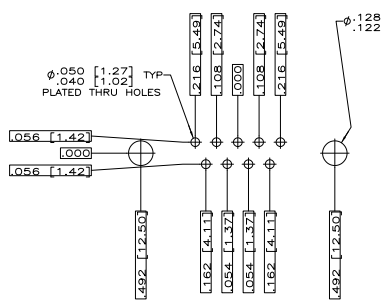

RECOMMENDED P.C. BOARD LAYOUT SHELL SIZE 1 (9 POSITION) Δ

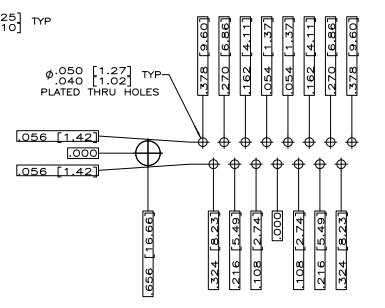

RECOMMENDED P.C. BOARD LAYOUT SHELL SIZE 2 (15 POSITION) Δ

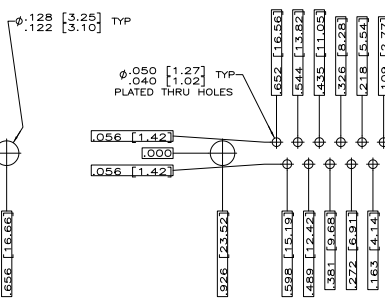

RECOMMENDED P.C. BOARD LAYOUT SHELL SIZE 3 (25 POSITION) Δ

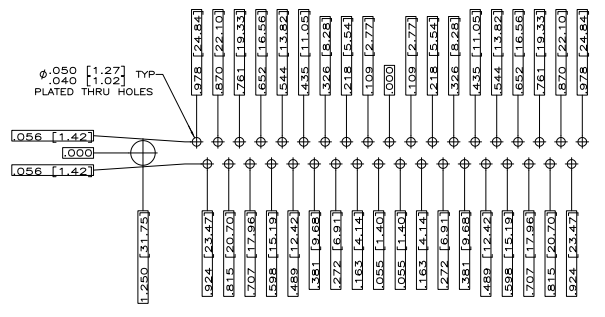

RECOMMENDED P.C. BOARD LAYOUT SHELL SIZE 4 (37 POSITION) Δ

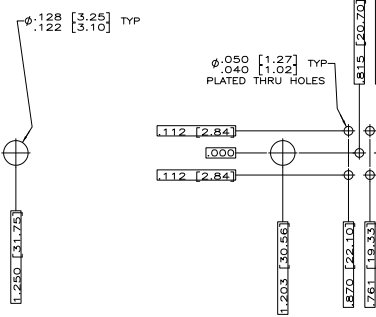

RECOMMENDED P.C. BOARD LAYOUT SHELL SIZE 5 (50 POSITION) Δ

THIS DRAWING IS A CONTROLLED DOCUMENT.		DATE: 8-18-78		BY: T. THOMAS		TYP: T. THOMAS		REV: 1	
DRAWING NO: 100779		REV: 1		DATE: 8-18-78		BY: T. THOMAS		TYP: T. THOMAS	
CUSTOMER DRAWING		DATE: 8-18-78		BY: T. THOMAS		TYP: T. THOMAS		REV: 1	
PROJECT: AMPULITE PLUG ASSY, LOW PROFILE		DATE: 8-18-78		BY: T. THOMAS		TYP: T. THOMAS		REV: 1	
SIZE: 20 POSTED P.C. BOARD CONTACTS,		DATE: 8-18-78		BY: T. THOMAS		TYP: T. THOMAS		REV: 1	
SIZES 10, SIZE 1 THRU 5		DATE: 8-18-78		BY: T. THOMAS		TYP: T. THOMAS		REV: 1	
DRAWING NO: 100779		DATE: 8-18-78		BY: T. THOMAS		TYP: T. THOMAS		REV: 1	
CUSTOMER DRAWING		DATE: 8-18-78		BY: T. THOMAS		TYP: T. THOMAS		REV: 1	