

**SWITCHMODE SERIES
NPN SILICON POWER DARLINGTON TRANSISTOR
WITH BASE-EMITTER SPEEDUP DIODE**

The MJ10006 and MJ10007 darlington transistors are designed for high-voltage, high-speed, power switching in inductive circuits where fall time is critical. They are particularly suited for line operated switch-mode applications such as:

FEATURES:

- *Continuous Collector Current - $I_C = 10$ A
- *Switching Regulators
- *Inverters
- *Solenoid and Relay Drivers

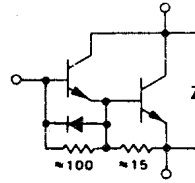

**NPN
MJ10006
MJ10007**

**10 AMPERE
POWER DARLINGTON
TRANSISTORS
350-400 VOLTS
150 WATTS**

MAXIMUM RATINGS

Characteristic	Symbol	MJ10006	MJ10007	Unit
Collector-Emitter Voltage	V_{CEV}	450	500	V
Collector-Emitter Voltage	$V_{CEX(SUS)}$	400	450	V
Collector-Emitter Voltage	$V_{CEO(SUS)}$	350	400	V
Emitter-Base Voltage	V_{EBO}	8.0		V
Collector Current-Continuous -Peak	I_C I_{CM}	10 20		A
Base current	I_B	2.5		A
Total Power Dissipation @ $T_C=25^\circ C$ Derate above $25^\circ C$ @ $T_C=100^\circ C$	P_D	150 85 0.86		W W W/ $^\circ C$
Operating and Storage Junction Temperature Range	T_J, T_{STG}	- 65 to +200		$^\circ C$

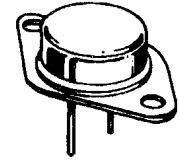

TO-3

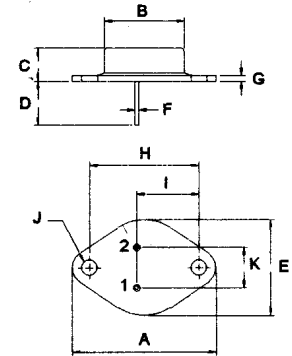

PIN 1.BASE
2.EMITTER
COLLECTOR(CASE)

THERMAL CHARACTERISTICS

Characteristic	Symbol	Max	Unit
Thermal Resistance Junction to Case	$R_{\theta jc}$	1.17	$^\circ C/W$

FIGURE -1 POWER DERATING

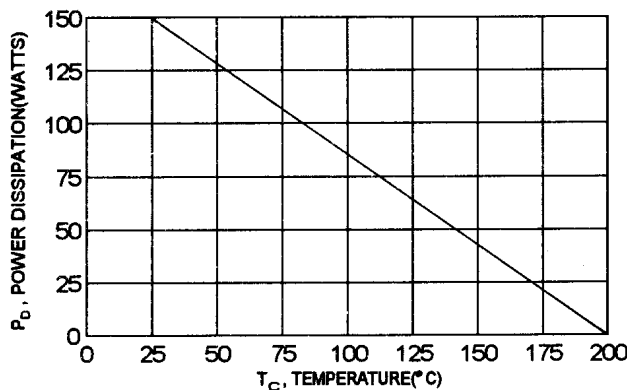

DIM	MILLIMETERS	
	MIN	MAX
A	38.75	39.96
B	19.28	22.23
C	7.96	9.28
D	11.18	12.19
E	25.20	26.67
F	0.92	1.09
G	1.38	1.62
H	29.90	30.40
I	16.64	17.30
J	3.88	4.36
K	10.67	11.18

ELECTRICAL CHARACTERISTICS ($T_c = 25^\circ\text{C}$ unless otherwise noted)

Characteristic	Symbol	Min	Max	Unit
----------------	--------	-----	-----	------

OFF CHARACTERISTICS

Collector - Emitter Sustaining Voltage ($I_C = 250 \text{ mA}, I_B = 0, V_{\text{clamp}} = \text{Rate } V_{\text{CEO}}$)	MJ10006 MJ10007	$V_{\text{CEO(SUS)}}$	350 400	V
Collector Cutoff Current ($V_{\text{CE}} = \text{Rated } V_{\text{CEV}}, R_{\text{BE}} = 50 \text{ ohm}, T_c = 100^\circ\text{C}$)		I_{CER}	5.0	mA
Collector Cutoff Current ($V_{\text{CEV}} = \text{Rated Value}, V_{\text{BE(OFF)}} = 1.5 \text{ V}$) ($V_{\text{CEV}} = \text{Rated Value}, V_{\text{BE(OFF)}} = 1.5 \text{ V}, T_c = 100^\circ\text{C}$)		I_{CEV}	0.25 5.0	mA
Emitter Cutoff Current ($V_{\text{EB}} = 2.0 \text{ V}, I_C = 0$)		I_{EBO}	175	mA

ON CHARACTERISTICS (1)

DC Current Gain ($I_C = 2.5 \text{ A}, V_{\text{CE}} = 5.0 \text{ V}$) ($I_C = 5.0 \text{ A}, V_{\text{CE}} = 5.0 \text{ V}$)	h_{FE}	40 30	500 300	
Collector - Emitter Saturation Voltage ($I_C = 5.0 \text{ A}, I_B = 250 \text{ mA}$) ($I_C = 10 \text{ A}, I_B = 1.0 \text{ A}$) ($I_C = 5.0 \text{ A}, I_B = 250 \text{ mA}, T_c = 100^\circ\text{C}$)	$V_{\text{CE(sat)}}$		1.9 2.9 2.0	V
Base - Emitter Saturation Voltage ($I_C = 5.0 \text{ A}, I_B = 250 \text{ mA}$) ($I_C = 5.0 \text{ A}, I_B = 250 \text{ mA}, T_c = 100^\circ\text{C}$)	$V_{\text{BE(sat)}}$		2.5 2.5	V
Diode Forward Voltage ($I_F = 5.0 \text{ A}$)	V_F		5.0	V

DYNAMIC CHARACTERISTICS

Small-Signal Current Gain(2) ($I_C = 1.0 \text{ A}, V_{\text{CE}} = 10 \text{ V}, f = 1.0 \text{ MHz}$)	$ h_{\text{fe}} $	10		
Output Capacitance ($V_{\text{CB}} = 10 \text{ V}, I_E = 0, f = 100 \text{ kHz}$)	C_{ob}	60		pF

SWITCHING CHARACTERISTICS

Delay Time	$V_{\text{CC}} = 250 \text{ V}, I_C = 5.0 \text{ A}$ $I_{\text{B1}} = 250 \text{ mA}, V_{\text{BE(off)}} = 5.0 \text{ V}$ $t_p = 50 \text{ us}, \text{Duty Cycle} \leq 2\%$	t_d	0.2	us
Rise Time		t_r	0.6	us
Storage Time		t_s	1.5	us
Fall Time		t_f	0.5	us

(1) Pulse Test: Pulse width = 300 us , Duty Cycle $\leq 2.0\%$ (2) $f_T = |h_{\text{re}}| \cdot f_{\text{test}}$

DC CURRENT GAIN

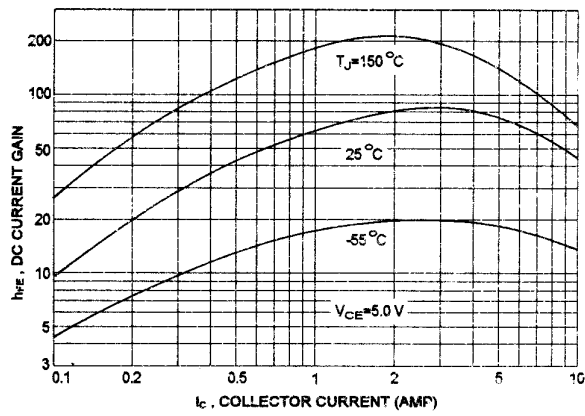

COLLECTOR SATURATION REGION

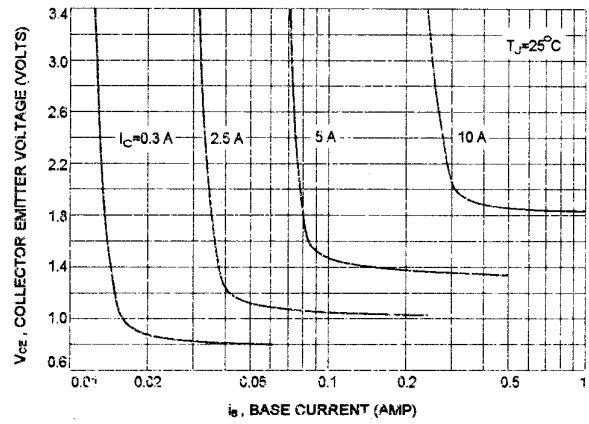

COLLECTOR EMITTER SATURATION VOLTAGE

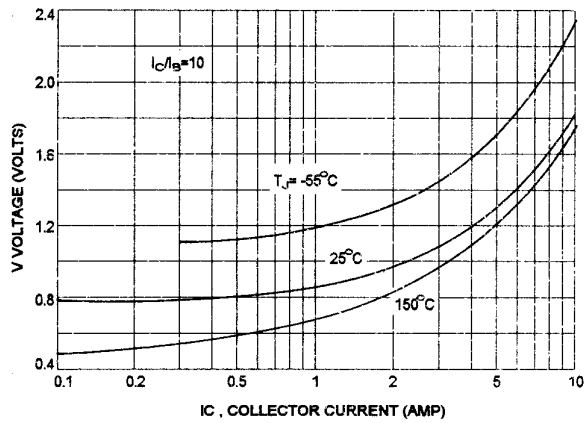

BASE EMITTER VOLTAGE

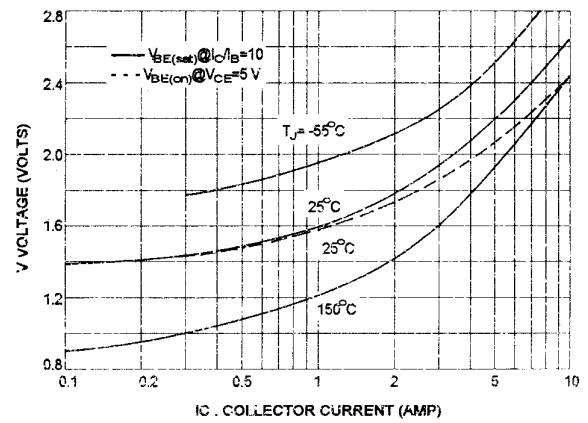

COLLECTOR CUT-OFF REGION

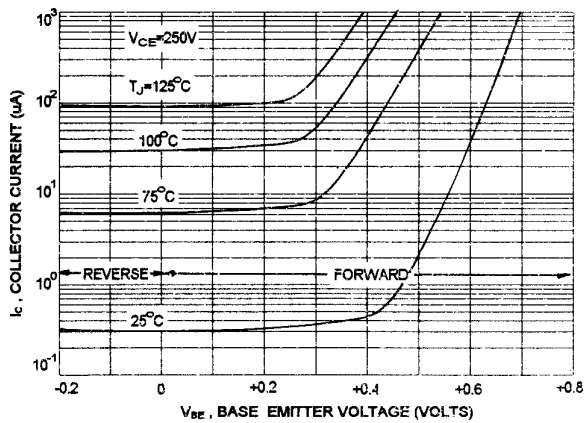

OUTPUT CAPACITANCES

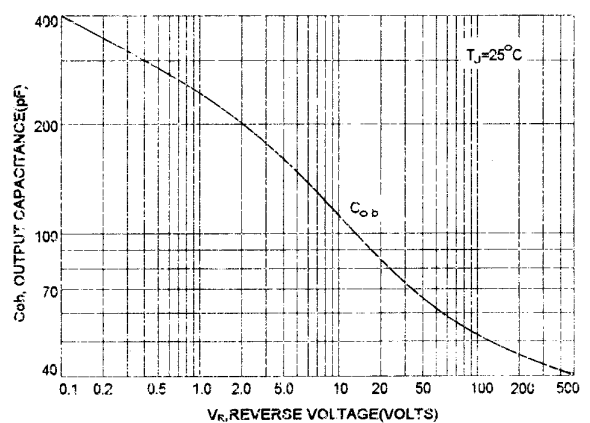

TURN-ON TIME

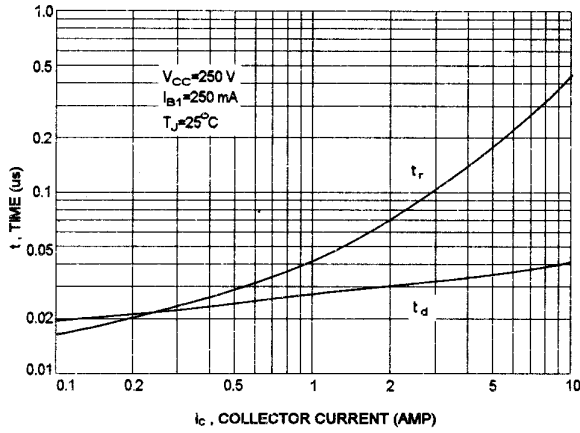

TURN-OFF TIME

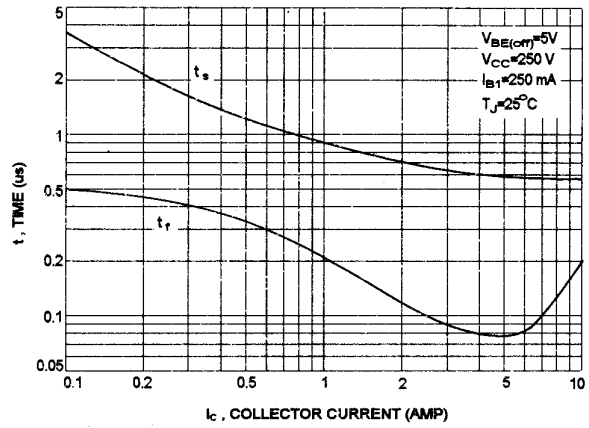

ACTIVE REGION SAFE OPERATING AREA

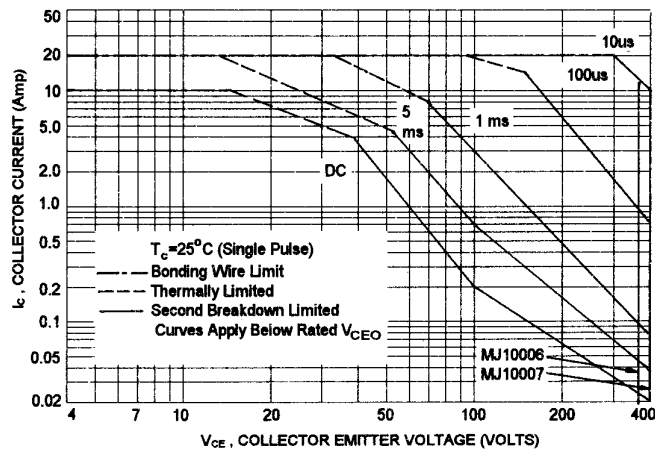

REVERSE BIAS SWITCHING SAFE OPERATING AREA

