

The RF Line 128-Channel (860 MHz) CATV Line Extender Amplifier

- Specified for 128-Channel Performance
- Broadband Power Gain — @ f = 50 MHz
G_p = 27.2 dB (Typ)
- Broadband Noise Figure
NF = 6 dB (Typ) @ 860 MHz
- All Gold Metallization
- Improved CTB Performance over Previous Version

MHW8272A

**27 dB GAIN
860 MHz
128-CHANNEL
CATV AMPLIFIER**

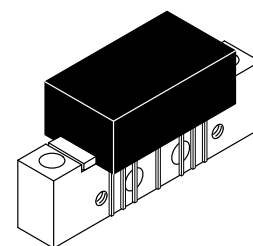

CASE 714Y-03, STYLE 1

MAXIMUM RATINGS

| Rating | Symbol | Value | Unit |
|----------------------------------|------------------|-------------|------|
| RF Voltage Input (Single Tone) | V _{in} | +55 | dBmV |
| DC Supply Voltage | V _{CC} | +28 | Vdc |
| Operating Case Temperature Range | T _C | -20 to +100 | °C |
| Storage Temperature Range | T _{stg} | -40 to +100 | °C |

ELECTRICAL CHARACTERISTICS (V_{CC} = 24 Vdc, T_C = +30°C, 75 Ω system unless otherwise noted)

| Characteristic | Symbol | Min | Typ | Max | Unit | |
|--|--------------------|-----------------------|------|------|-------|--------|
| Frequency Range | BW | 40 | — | 860 | MHz | |
| Power Gain | G _p | 50 MHz | 26.2 | 27.2 | 27.8 | dB |
| | | 860 MHz | 27 | 27.7 | 29.5 | |
| Slope | S | 0 | 0.6 | 2 | dB | |
| Gain Flatness (40–860 MHz, Peak to Valley) | — | — | 0.4 | 0.8 | dB | |
| Return Loss — Input/Output (Z ₀ = 75 Ohms) | IRL/ORL | @ 40 MHz | 20 | — | — | dB |
| | | @ f > 40 MHz (Derate) | — | — | 0.007 | dB/MHz |
| Composite Second Order (V _{out} = +38 dBmV/ch., Worst Case) | CSO ₁₂₈ | — | -69 | -64 | dBc | |
| Cross Modulation Distortion @ Ch 2 (V _{out} = +38 dBmV/ch., FM = 55 MHz) | XMD ₁₂₈ | — | -65 | -62 | dBc | |
| Composite Triple Beat (V _{out} = +38 dBmV/ch., Worst Case) | CTB ₁₂₈ | — | -69 | -64 | dBc | |
| Noise Figure | NF | 50 MHz | — | — | 5.5 | dB |
| | | 860 MHz | — | 6.0 | 7.0 | |
| DC Current (V _{DC} = 24 V, T _C = 30°C) | I _{DC} | 280 | 310 | 350 | mA | |

PACKAGE DIMENSIONS

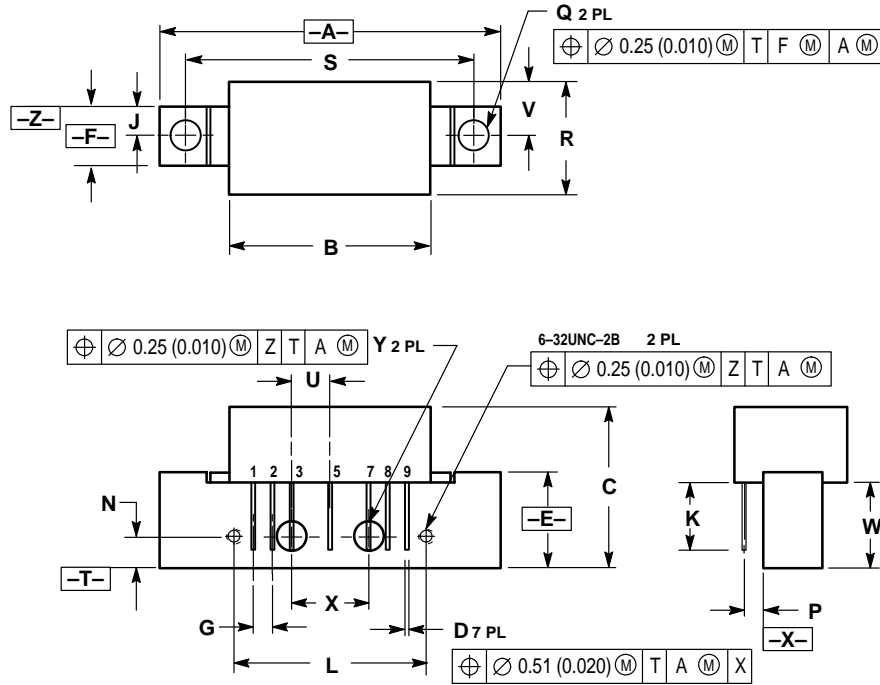

- NOTES:
 1. DIMENSIONING AND TOLERANCING PER ANSI Y14.5M, 1982.
 2. CONTROLLING DIMENSION: INCH.

| DIM | INCHES | | MILLIMETERS | |
|-----|-----------|-------|-------------|-------|
| | MIN | MAX | MIN | MAX |
| A | — | 1.775 | — | 45.08 |
| B | — | 1.085 | — | 27.56 |
| C | — | 0.840 | — | 21.34 |
| D | 0.018 | 0.022 | 0.46 | 0.56 |
| E | 0.465 | 0.510 | 11.81 | 12.95 |
| F | 0.300 | 0.325 | 7.62 | 8.25 |
| G | 0.100 BSC | — | 2.54 BSC | — |
| J | 0.156 BSC | — | 3.96 BSC | — |
| K | 0.315 | 0.355 | 8.00 | 8.50 |
| L | 1.00 BSC | — | 25.40 BSC | — |
| N | 0.165 BSC | — | 4.19 BSC | — |
| P | 0.100 BSC | — | 2.54 BSC | — |
| Q | 0.148 | 0.168 | 3.76 | 4.27 |
| R | — | 0.600 | — | 15.24 |
| S | 1.500 BSC | — | 38.10 BSC | — |
| U | 0.200 BSC | — | 5.08 BSC | — |
| V | — | 0.250 | — | 6.35 |
| W | 0.435 | 0.450 | 11.05 | 11.43 |
| X | 0.400 BSC | — | 10.16 BSC | — |
| Y | 0.152 | 0.163 | 3.85 | 4.15 |

- STYLE 1:
 PIN 1. RF INPUT
 2. GROUND
 3. GROUND
 4. DELETED
 5. VDC
 6. DELETED
 7. GROUND
 8. GROUND
 9. RF OUTPUT

CASE 714Y-03 ISSUE D

Motorola reserves the right to make changes without further notice to any products herein. Motorola makes no warranty, representation or guarantee regarding the suitability of its products for any particular purpose, nor does Motorola assume any liability arising out of the application or use of any product or circuit, and specifically disclaims any and all liability, including without limitation consequential or incidental damages. "Typical" parameters which may be provided in Motorola data sheets and/or specifications can and do vary in different applications and actual performance may vary over time. All operating parameters, including "Typicals" must be validated for each customer application by customer's technical experts. Motorola does not convey any license under its patent rights nor the rights of others. Motorola products are not designed, intended, or authorized for use as components in systems intended for surgical implant into the body, or other applications intended to support or sustain life, or for any other application in which the failure of the Motorola product could create a situation where personal injury or death may occur. Should Buyer purchase or use Motorola products for any such unintended or unauthorized application, Buyer shall indemnify and hold Motorola and its officers, employees, subsidiaries, affiliates, and distributors harmless against all claims, costs, damages, and expenses, and reasonable attorney fees arising out of, directly or indirectly, any claim of personal injury or death associated with such unintended or unauthorized use, even if such claim alleges that Motorola was negligent regarding the design or manufacture of the part. Motorola and are registered trademarks of Motorola, Inc. Motorola, Inc. is an Equal Opportunity/Affirmative Action Employer.

Mfax is a trademark of Motorola, Inc.

How to reach us:

USA/EUROPE/Locations Not Listed: Motorola Literature Distribution;
 P.O. Box 5405, Denver, Colorado 80217. 1-303-675-2140 or 1-800-441-2447

JAPAN: Nippon Motorola Ltd.: SPD, Strategic Planning Office, 141,
 4-32-1 Nishi-Gotanda, Shagawa-ku, Tokyo, Japan. 03-5487-8488

Customer Focus Center: 1-800-521-6274

Mfax™: RMFAX0@email.sps.mot.com – TOUCHTONE 1-602-244-6609
 Motorola Fax Back System – US & Canada ONLY 1-800-774-1848
 – http://sps.motorola.com/mfax/

ASIA/PACIFIC: Motorola Semiconductors H.K. Ltd.; 8B Tai Ping Industrial Park,
 51 Ting Kok Road, Tai Po, N.T., Hong Kong. 852-26629298

HOME PAGE: <http://motorola.com/sps/>



MHW8272A/D