

FCI CONFIDENTIAL

This document is the property of and embodies CONFIDENTIAL and PROPRIETARY information of FCI. No part of this information shall be disclosed, copied, reproduced, or transmitted in any form or by any means without the written consent of FCI. Copyright FCI.

PRODUCT NUMBER  
67032-001LF

WHEN REQUIRED, ADD SUFFIX LETTER "LF"  
INDICATES THE PRODUCT IS RoHS  
COMPATIBLE, SEE NOTE 3

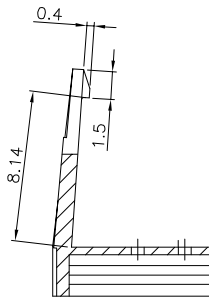

SECTION Z-Z

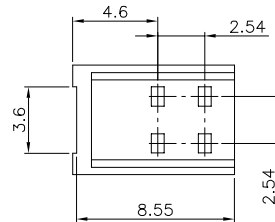
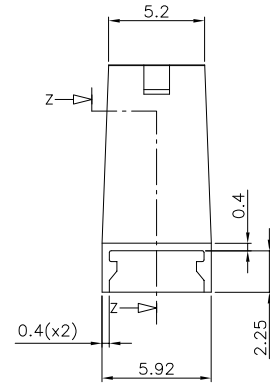

NOTES :

1. MATERIAL : NYLON 6/6, 25% GLASSFIBER  
FLAMMABILITY PER UL-94-V0.  
COLOUR : BLACK
2. FOR LATCH APPLICATION SEE TA 339
3. RoHS COMPATIBLE PRODUCT
  - a - LABELLING:
    - MEETS PACKAGING SPECS AS PER GS-14-920
  - b - LEGAL STATEMENT : SEE GS-22-008
  - c - THE PRODUCT IS NOT INTENDED TO BE EXPOSED TO MANUFACTURING SOLDER PROCESS
  - d - PRODUCT MEETS WITH EU 2002/EG/95

mat'l. code	surface	tolerance	projection	product family
SEE NOTE	ISO 1302	ISO 406 ISO 1101		BERGSTIK
ltr	ecn no	dr	date	title
B	F05-0256	LMU	05.10.11	DR QUICKIE
C	F06-0236	LMU	06.07.17	BERGSTIK LATCH
D	F07-0179	LMU	07.04.12	
		dr	L.MULIN 05.09.28	dwg no
		engr	J.COMPAGNON 05.09.28	67032
		chr		sheet 1 of 1
		appd	JM.C 05.09.28	size
				A3
sheet index	revision sheet			type
				CUSTOMER Drawing

form: A3  
Engineering/Prod/CP/02-07/15/02/01.dwg