



ALL RIGHTS RESERVED. NO PORTION OF THIS PUBLICATION, WHETHER IN WHOLE OR IN PART CAN BE REPRODUCED WITHOUT THE EXPRESS WRITTEN CONSENT OF SPC TECHNOLOGY.

SPC-F005.DWG

REVISIONS

DOC. NO. SPC-F005 * Effective: 7/8/02 * DCP No: 1398

DCP #	REV	DESCRIPTION	DRAWN	DATE	CHECKD	DATE	APPRVD	DATE
1501	A	RELEASED	JWM	9/22/03	HO	9/23/03	DJC	9/23/03

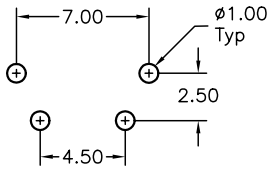
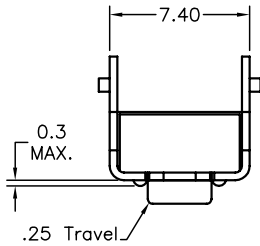

PCB LAYOUT (TOP VIEW)

SPECIFICATIONS

Electrical

- Contact Rating: 50mA at 12 VDC
- Contact Resistance: 100 milliohms max.
- Insulation Resistance: 100 Megohms min. at 500 VDC
- Dielectric Strength: 250 VAC for 1 minute

Environmental

- Operating Temperature: -25°C to 70°C
- Storage Temperature: -30°C to 80°C
- Humidity Range: 10% to 80% RH

Material

- Frame: Steel, Tin Plated 100 microinches min.
- Housing: Black Nylon, UL94V-0
- Actuator: Nylon, UL94V-0
- Terminals: Brass, Silver Plated
- Contact: Phosphor Bronze, Silver Plated

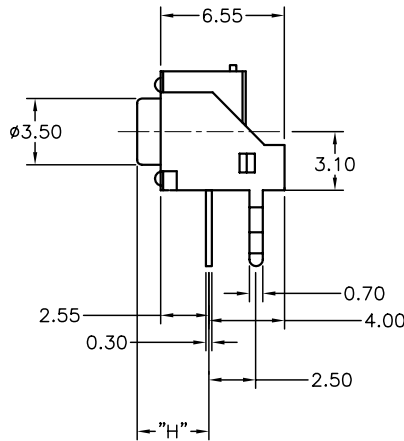
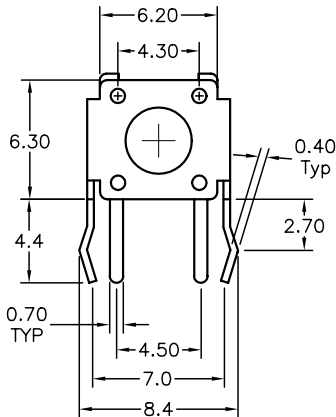

SPC Type No.	"H" Dim Actuator Height (mm)	Operating Force (gf)
SPC12381	3.85	160
SPC12385	3.85	120
SPC12386	8.35	260
SPC12387	8.35	160
SPC12389	8.35	120
SPC12390	3.85	260

DISCLAIMER: ALL STATEMENTS AND TECHNICAL INFORMATION CONTAINED HEREIN ARE BASED UPON INFORMATION AND/OR TESTS WE BELIEVE TO BE ACCURATE AND RELIABLE. SINCE CONDITIONS OF USE ARE BEYOND OUR CONTROL, THE USER SHALL DETERMINE THE SUITABILITY OF THE PRODUCT FOR THE INTENDED USE AND ASSUME ALL RISK AND LIABILITY WHATSOEVER IN CONNECTION THEREWITH.

TOLERANCES: UNLESS OTHERWISE SPECIFIED, DIMENSIONS ARE FOR REFERENCE PURPOSES ONLY.

DRAWN BY:	DATE:
Jeff McVicker	9/22/03
CHECKED BY:	DATE:
Hisham Odish	9/23/03
APPROVED BY:	DATE:
Daniel Carey	9/23/03

DRAWING TITLE:			
Tactile Switch			
SIZE	DWG. NO.	ELECTRONIC FILE	REV
A	TA-588	TA-588.dwg	A
SCALE: NTS	U.O.M.: Millimeters	SHEET: 1 OF 1	