

MICRO SWITCH
a Honeywell Division

FED. MFG. CODE 91929

SWITCH - BASIC

CATALOG LISTING

V7-1D10D8

CW-B2061

REPLACES X110332-V7

RELEASE NO. PR-23274

CATALOG LISTING
V7-1D10D8
PAGE 1 OF 1

M

ISSUE
4

CHECK

04 JUN 04

AK

CHECK

17 DEC 97

DCS

17 DEC 97

DCS

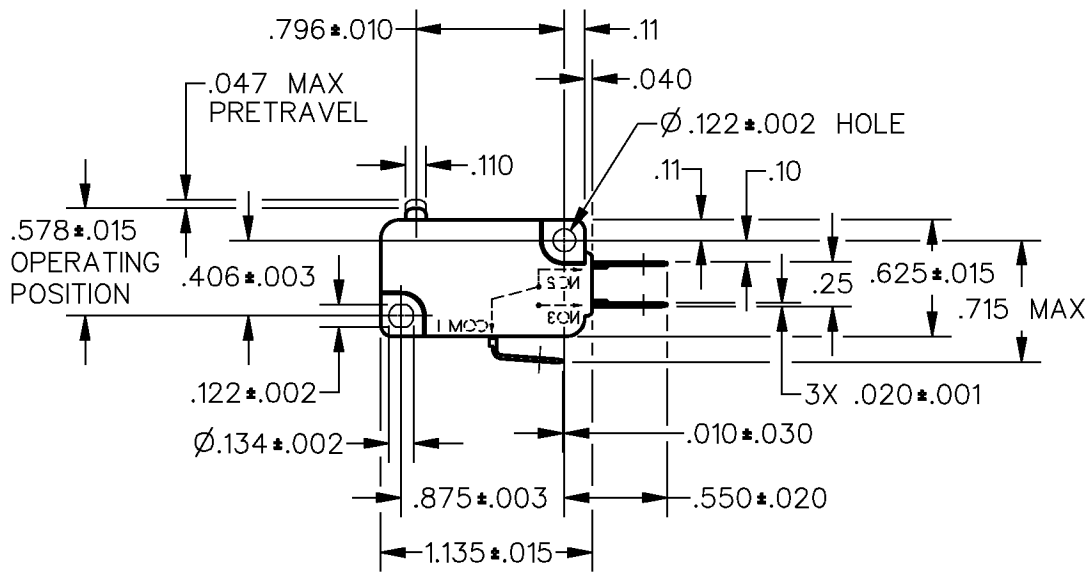
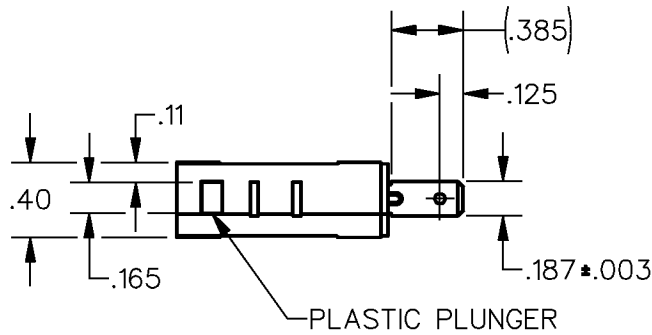

NOTES

- 1 - IN INSPECTION, DO NOT BURN OUT - GOLD CONTACTS
- 2 - IN INSPECTION, DO NOT EXCEED 10 VDC, .1A RESISTIVE LOAD
- 3 - INSPECT SWITCH RESISTANCE PER CONTROL PLAN

ANSI Y14.5M-1982 APPLIES

THIS DRAWING COVERS A PROPRIETARY ITEM AND IS THE PROPERTY OF MICRO SWITCH, A DIVISION OF HONEYWELL. THIS DRAWING IS NOT TO BE COPIED OR USED WITHOUT THE APPROVAL OF MICRO SWITCH.

THIRD ANGLE PROJECTION

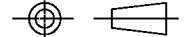

CHARACTERISTICS	ELECTRICAL DATA	SCALE FULL	DO NOT SCALE PRINT
OPERATING FORCE --- 150 GRAMS MAX	CONTACT ARRANGEMENT S P D T	UNLESS OTHERWISE SPECIFIED TOLERANCES ARE ONE PLACE (.0) ±.030 TWO PLACE (.00) ±.015 THREE PLACE (.000) ±.005 ANGLES ± WEIGHT	
RELEASE FORCE --- 25 GRAMS MIN	L22		
DIFFERENTIAL TRAVEL --- .002-.010	1A 125 VAC		
OVERTRAVEL --- .050 MIN			
FREE POSITION --- .625 MAX			
RELEASE TRAVEL --- .010 MIN			



RASTER
DRAWN