

13	12	11	10	9	8	7	6	5	4	3	2	1
1302441203	2.5 mm ² / 14 AWG	5.8-6.7 / .23-.26	7.0 / .28									
1302441201	4.0-6.0 mm ² / 12-10 AWG	6.7-7.8 / .26-.31	8.4 / .33									
MATERIAL NO.	CABLE SIZE	CABLE Ø RANGE	DIM. "A"									

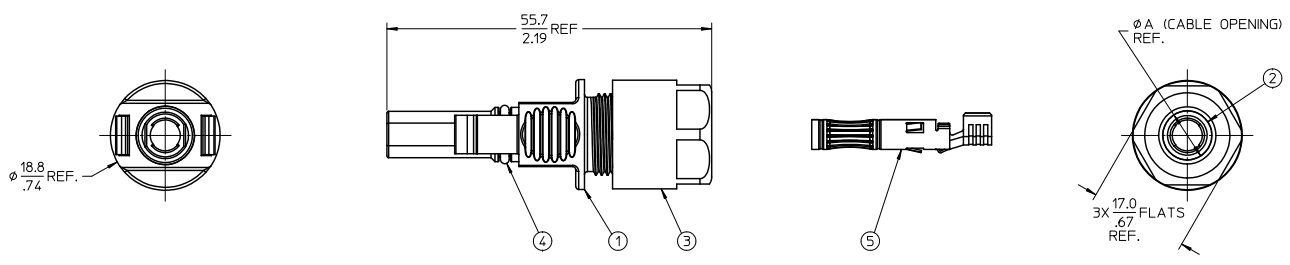
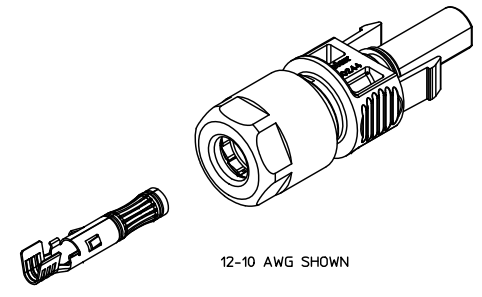

- NOTES:
1. MATERIALS: SEE TABLE
 2. FINISHES: SEE TABLE
 3. PRODUCT SPECIFICATION: PS-130244-001
 4. PACKAGING SPECIFICATION: PK-130244-021
 5. MATES WITH: 1302441202 OR 1302441204
 6. ASSEMBLY IS ROHS COMPLIANT.
 7. 5 ASSEMBLIES PER KIT.

5	1	CONTACT, SOCKET	COPPER ALLOY	SELECTIVE SILVER
4	1	O-RING SEAL	SILICONE	DARK GRAY
3	1	CABLE RETENTION NUT	POLYCARBONATE (PC)	BLACK
2	1	CABLE GROMMET	SILICONE	TRANSLUCENT
1	1	SOCKET HOUSING	POLYCARBONATE (PC)	BLACK
ITEM	QTY.	DESCRIPTION	MATERIAL	FINISH

PRELIMINARY EC NO: WNA2011-0282 DRAWN BY: CLYORK 2010/11/24 CHECKED BY: DTITUS APPROVED BY: DTITUS 2010/12/06	QUALITY SYMBOLS ◀=0 ▷=0	GENERAL TOLERANCES (UNLESS SPECIFIED)		DIMENSION STYLE MM/IN		SCALE 2:1	DESIGN UNITS METRIC	THIRD ANGLE PROJECTION
		4 PLACES ±.005 ±.005 3 PLACES ±.013 ±.010 2 PLACES ±0.25 ±.005 1 PLACE ±.025 ±.005 ANGULAR ± 2°	mm INCH --- --- --- ±.005 ±0.13 ±.010 ±.025 ±.005	DRAWN BY CLYORK CHECKED BY DTITUS APPROVED BY DTITUS DATE 2010/08/13 DATE 2010/08/13 DATE 2010/12/06	TITLE SOCKET ASSEMBLY KIT, PV SOLAR DC CONNECTOR, 14-10 AWG	MOLEX INCORPORATED	DOCUMENT NO. SD-130244-021 SHEET NO. 1 OF 1	
DRAFT WHERE APPLICABLE MUST REMAIN WITHIN DIMENSIONS		SEE CHART		THIS DRAWING CONTAINS INFORMATION THAT IS PROPRIETARY TO MOLEX INCORPORATED AND SHOULD NOT BE USED WITHOUT WRITTEN PERMISSION				