

Front view and mounting

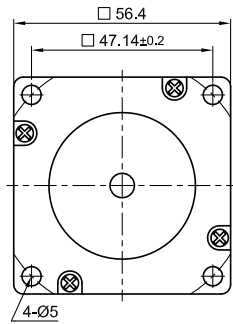

Side view

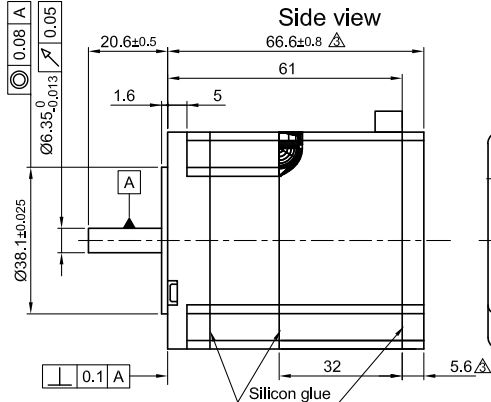

Rear view

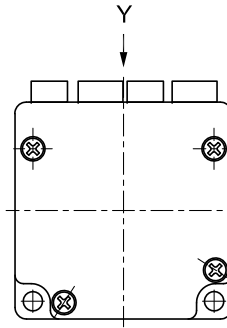

Y view

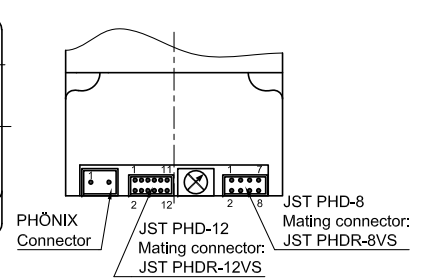

SPECIFICATION	CONNECTION	BIPOLAR PARALLEL
SUPPLY VOLTAGE (VDC)	24 TO 48	
AMPS/PHASE		* UP TO 4.8 (100%=3.2)
HOLDING TORQUE (Nm) [lb-in]		0.537 [4.752]
DETENT TORQUE (Nm) [lb-in]		0.0147 [0.13]
STEP ANGLE (°) ± ACCURACY		* 1.8 TO MICROSTEP
WEIGHT (Kg) [lb]		0.49 [1.08]

* ADJUSTABLE WITH NANOPRO.

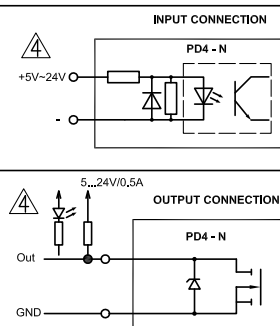

PERMISSIBLE RADIAL+AXIAL FORCE

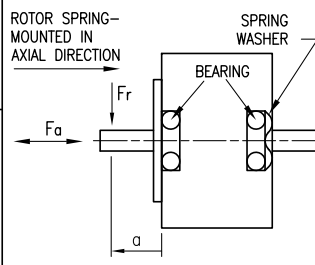

OVERTEMPERATURE PROTECTION (ELECTRONICS): 80°C	AXIAL-FORCE Fa (N)	Fa=10
AMBIENT TEMPERATURE -10°~ 40°C [14°F ~ 104°F] (HIGHER TEMPERATURE REDUCES DUTY CYCLE)	DISTANCE a (mm)	5 10 15 20
INSULATION RESISTANCE 100 MΩ (UNDER NORMAL TEMPERATURE AND HUMIDITY)	RADIAL-FORCE Fr (N)	130 90 70 52
INSULATION CLASS B 130° [266°F]		AXIAL RADIAL
DIELECTRIC STRENGTH 500VAC FOR 1 MIN. (BETWEEN THE MOTOR COILS AND THE MOTOR CASE)	SHAFT PLAY (mm)	0.08 0.02
AMBIENT HUMIDITY MAX. 85% (NO CONDENSATION)	AT LOAD MAX: (N)	4.5 4.5

JST PHDR-8VS			JST PHDR-12VS		
PIN No.	WIRE COLOUR	ASSIGNMENT	PIN No.	WIRE COLOUR	ASSIGNMENT
1	BU	GND	1	GY-BN	COM
2	WH-PK	+UB extern	2	RD	GND
3	YE	RS485 Rx-	3	BK	INPUT 1
4	GN	RS485 Rx+	4	VT	INPUT 2
5	PK	RS485 Tx-	5	GY-PK	INPUT 3
6	GY	RS485 Tx+	6	RD-BU	INPUT 4
7	BN	CAN+	7	WH-GN	INPUT 5
8	WH	CAN-	8	BN-GN	INPUT 6
FK-MCP-1.5/2-ST-3.5 gn			9	WH-BU	ANALOG INPUT
PIN No.	WIRE COLOUR	ASSIGNMENT	10	WH-YE	OUTPUT 1
1	BK	GND	11	YE-BN	OUTPUT 2
2	BN	Vcc	12	WH-GY	OUTPUT 3

FULL STEP 2 PHASE-Ex., WHEN FACING MOUNTING END (X)				
STEP	A	B	A'	B'
1	+	+	-	-
2	-	+	+	-
3	-	-	+	+
4	+	-	-	+

CABLE SET:
ZK-PD4N
L=500mm

3	MOTOR LENGTH	20.07.10	J.W.
2	NEW VALUE OF ADJUSTABLE CURRENT	07.04.10	J.W.
4	NEW CONNECTION OF IN-, OUTPUT	07.09.10	J.W.
REV	DESCRIPTION	DATE	APVD



PD4-N5918X4204

SCALE FREE	APVD	S.H.	30.10.09
X ±0.5	CHKD		
1PL ±0.2	DRN	J.W.	30.10.09
2PL ±0.1	SIGNATURE		
ANGLE ±30'	DATE		

PLUG&DRIVE MOTOR

DWG.NO

PD4-N5918X4204