

NEW!

AP Series Industrial Pushbutton Switch



A

Pushbutton

Features/Benefits

- IP67 sealed
- 1,000,000 life cycle
- Illumination / non-illumination
- Multiple colored caps
- Threaded or snap-in mounting
- SPST, normally open
- Caps available separately

Typical Applications

- Harsh environments
- Off-Road
- Industrial
- Medical
- Transportation
- Joystick control modules
- Gaming
- Military



Specifications

FUNCTION: SPST Momentary
 CONTACT ARRANGEMENT: N.O.
 MOUNTING TYPE:
 Snap-in (panel front) or threaded (nut with locking washer)

Mechanical

TOTAL TRAVEL: 1.9 ± 0.1 mm
 PRE-TRAVEL: 1.2 ± 0.1 mm
 OVER TRAVEL: 0.7 ± 0.1 mm
 OPERATING FORCE: 3.5N standard configuration; other force option 2N
 VIBRATION: 10-500 Hz 10g Max
 SHOCK: 60g 11ms sawtooth wave

Electrical

CONTACT RATING:
 200mA @ 24 V DC resistive
 100mA @ 50 V DC resistive
 400mA @ 32 V AC resistive
 125mA @ 125 V AC resistive
 DIELECTRIC STRENGTH: 1000 V AC min.
 INSULATION RESISTANCE: 1 G |
 INITIAL CONTACT RESISTANCE 50 m | max (without wire leads)
 BOUNCE TIME: <5 ms

Materials

HOUSING: PBT
 BASE: PBT
 CAP: PBT
 ACTUATOR:
 Illuminated: Clear polycarbonate
 Non-illuminated: PBT
 INTERNAL SEAL: Silicone rubber
 TERMINALS: Copper alloy, gold over silver plating
 MOVABLE CONTACT: Copper alloy, gold over silver plating
 TERMINAL SEAL: Epoxy

Operating Environment

OPERATING TEMPERATURE: -40°C to 85°C (+105°C non-illuminated)
 OPERATING LIFE: 1,000,000 cycles

Process Environment

SEALING: IP67

NOTE: Specifications and materials listed above are for switches with standard options. For information on specific and custom switches, please contact Customer Service.

Build-A-Switch

To order, simply select desired option from each category and place in the appropriate box.

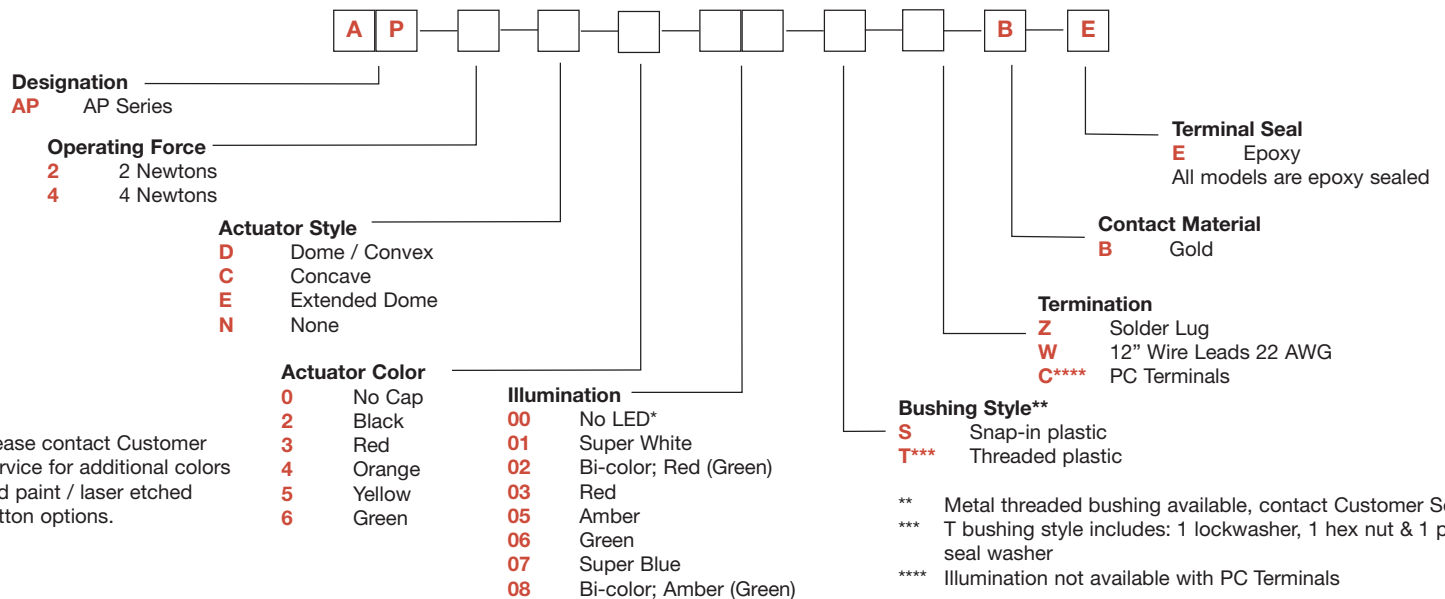

Please contact Customer Service for additional colors and paint / laser etched button options.

** Metal threaded bushing available, contact Customer Service
 *** T bushing style includes: 1 lockwasher, 1 hex nut & 1 panel seal washer
 **** Illumination not available with PC Terminals

* No LED available in short body only

Contact Customer Service for additional hardware options.

Specifications and dimensions subject to change





AP Series Industrial Pushbutton Switch

NEW!

STANDARD VIEW

A

Pushbutton

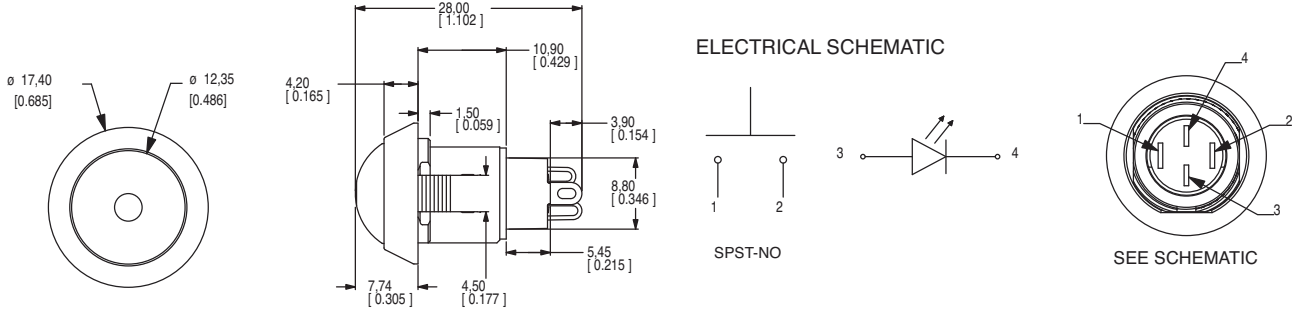

OPERATING FORCE

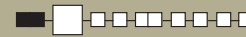

OPTION CODE	OPERATING FORCE
2	2 N, 200 g
4	4 N, 400 g

ACTUATOR STYLE

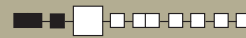

D DOME / CONVEX

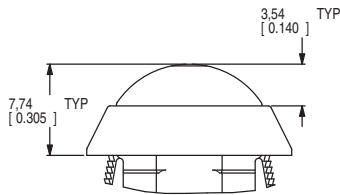

E EXTENDED DOME

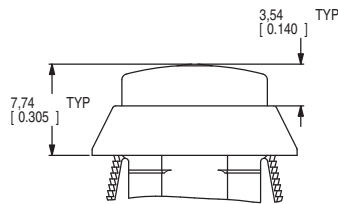

C CONCAVE

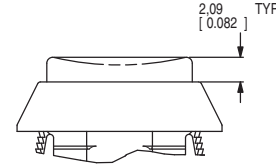
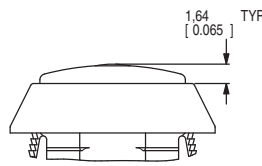
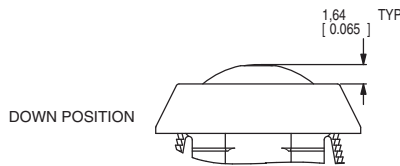
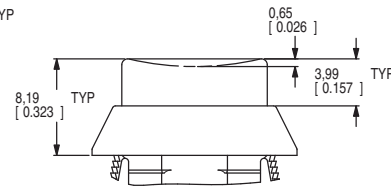

ACTUATOR COLOR

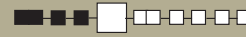

OPTION CODE	ACTUATOR COLOR
0	No Cap
2	Black
3	Red
4	Orange
5	Yellow
6	Green

For additional colors please contact Customer Service.

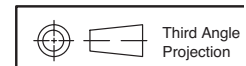

Third Angle Projection

Dimensions are shown: mm (inches)
Specifications and dimensions subject to change

www.ck-components.com

NEW!

AP Series Industrial Pushbutton Switch

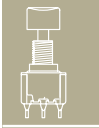

A

Pushbutton

ILLUMINATION



OPTION CODE	ILLUMINATION TYPE	TYPICAL INTENSITY*		PEAK WAVELENGTH	Vf Forward Voltage
		MIN	MAX		
		(mcd)		(nm)	
00	Model without illumination	N/A		N/A	
01	LED Super White	4,000	5,000	N/A	3.5
02	LED Bi-Color – Red (Green)	10	20	635/565	2.0
03	LED Red	4	8	700	2.0
05	LED Amber	35	50	610	2.0
06	LED Green	35	50	565	2.0
07	LED Super Blue	800	1,500	470	3.8
08	LED Bi-Color – Amber (Green)	10	10	585/565	2.0

*LED FORWARD CURRENT: 20 mA
 LED FORWARD VOLTAGE: see chart above
 LED REVERSE VOLTAGE: 5.0 V MAX

* For information on specific and custom LED, please contact Customer Service.

BUSHING STYLE



S SNAP-IN

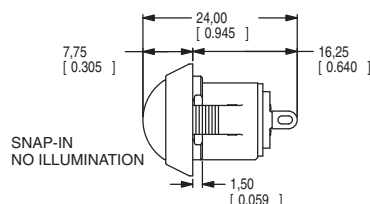
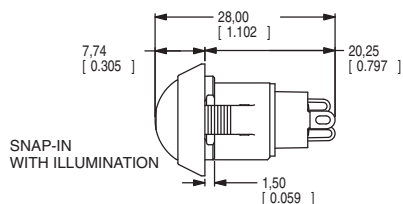

T THREADED PLASTIC

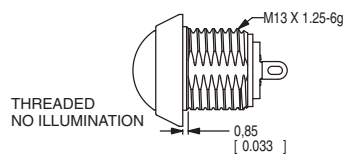
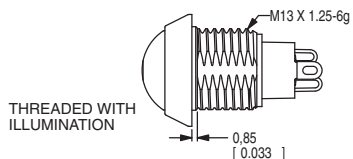

PANEL CUTOUT

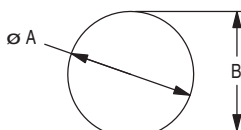

PANEL THICKNESS	DIM A	DIM B
1 mm [0.039 in]	13.70 mm [0.539 in]	13.00 mm [0.512 in]
2 mm [0.079 in]	13.70 mm [0.539 in]	13.00 mm [0.512 in]
3 mm [0.118 in]	13.90 mm [0.547 in]	13.10 mm [0.516 in]
THREADED BODY MIN PANEL THICKNESS 1 mm	13.70 mm [0.539 in]	13.00 mm [0.512 in]

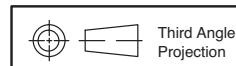

Dimensions are shown: mm (inches)
 Specifications and dimensions subject to change



www.ck-components.com



AP Series Industrial Pushbutton Switch

NEW!

TERMINATION



Pushbutton

A

Z SOLDER LUG

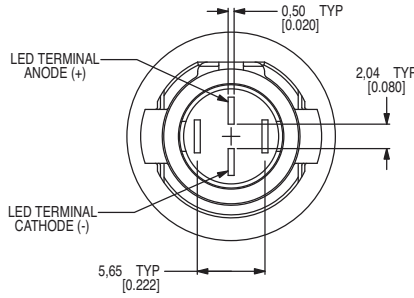
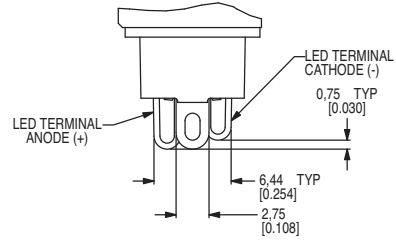
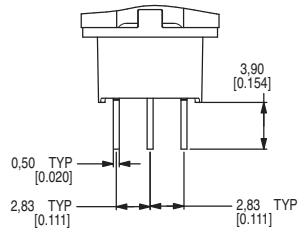

C PC TERMINALS

**** Illumination not available with PC Terminals

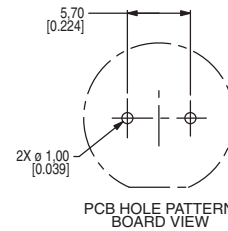
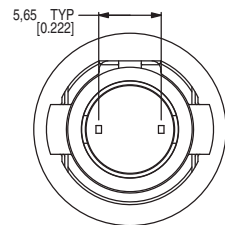
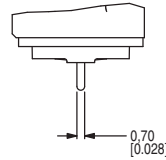
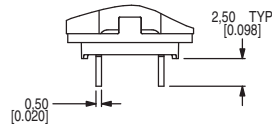

W 12" WIRE LEADS 22 AWG

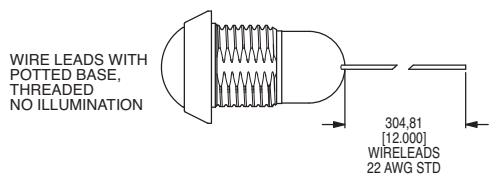
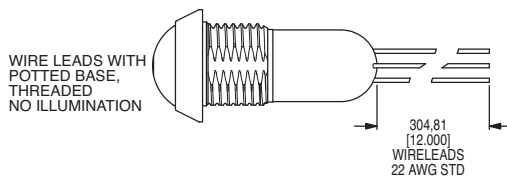
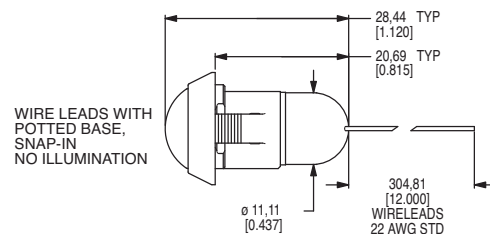
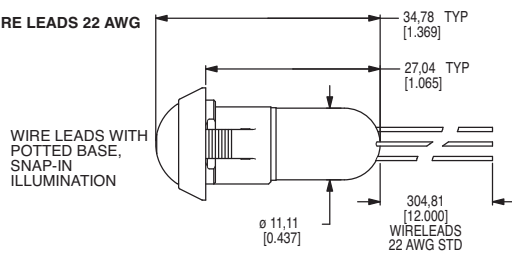

Dimensions are shown: mm (inches)
Specifications and dimensions subject to change

www.ck-components.com



NEW!

AP Series Industrial Pushbutton Switch



A

Pushbutton

CONTACT MATERIAL



B GOLD

OPTION CODE	CONTACT MATERIAL
B	Gold

TERMINAL SEAL



E EPOXY

All models are epoxy sealed

HARDWARE

LOCK WASHER
Part Number 647D

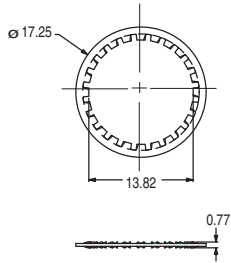

HEX NUT
Part number 515D

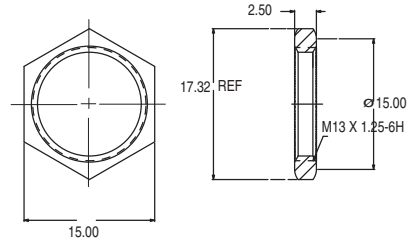

AVAILABLE CAPS



D DOME

481D XX XXX
Cap
Cap Color
Actuator Style

OPTION	CAP COLOR
02	BLACK
03	RED
04	ORANGE
05	YELLOW
06	GREEN

PART NUMBER	HOLE	ACTUATOR STYLE
481DXX000	NO	DOME
481DXX001	YES	DOME
481DXX002	NO	CONCAVE
481DXX003	YES	CONCAVE
481DXX004	NO	EXTENDED DOME
481DXX005	YES	EXTENDED DOME

C CONCAVE

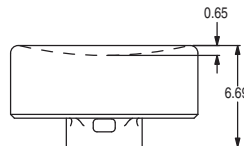
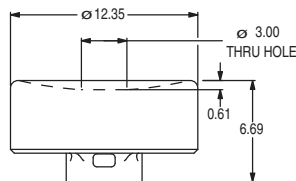
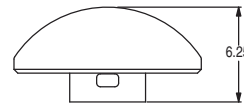
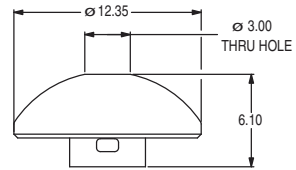

E EXTENDED DOME

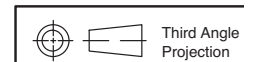
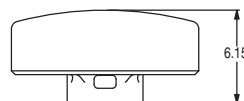
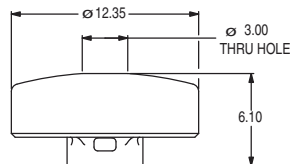

Dimensions are shown: mm (inches)
Specifications and dimensions subject to change



www.ck-components.com