

AMPLIMITE .050 Series Panel Mount Receptacle Assemblies With Rails, Latch Blocks, Series III (Continued)

AMPLIMITE .050 Series
Connectors, Series III

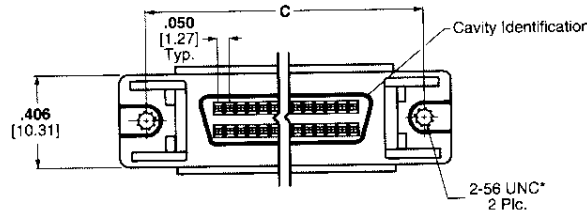
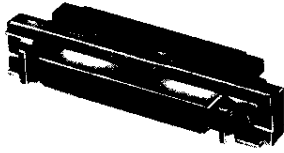

Materials:

Housing and Termination

Covers—Thermoplastic, 94V-0 rated, black

Shell—Steel, plated bright nickel over copper

Bracket—Zinc, plated nickel over copper

Contacts—Phosphor bronze, duplex plated .000030 [0.00076] min. gold on mating end, bright tin-lead in termination area, all nickel underplated

Recommended wire size—

28 AWG [0.08-0.09mm²] or 30 AWG [0.05mm²], solid or 7 strand, with a .029- .036 [0.74-0.89] insulation diameter or .050 [1.27] centerline, 28 AWG [0.08-0.09mm²] stranded, PVC, flat ribbon cable.

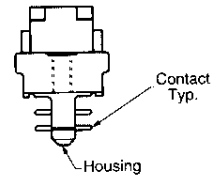
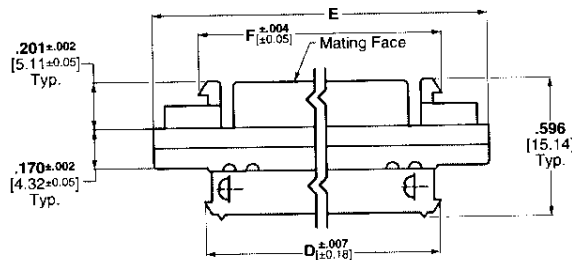

Technical Documents:

Product Specifications—108-1228

Application Specifications—114-40029

Note: Extra pin contact protection is provided by rails, which facilitate a straight-out, unmating motion. A side-to-side rocking motion should not be used to disengage the connector system.

Note: Refer to Tyco Electronics Customer drawings and Application Spec for PCB & panel layouts.

| No. of Pos. | Dimensions | | | | Part Numbers |
|-------------|----------------|----------------|----------------|----------------|---|
| | C | D | E | F | Connectors With Assembled Standard Termination Covers |
| 20 | 1.080 27.43 | .879 22.33 | 1.315 33.40 | .915 23.24 | 749611-2 |
| 26 | 1.230 31.24 | 1.029 26.14 | 1.465 37.21 | 1.065 27.05 | 749611-1 |
| 50 | 1.830 46.48 | 1.629 41.38 | 2.065 52.45 | 1.665 42.29 | 749611-5 |
| 50 | 1.830 46.48 | 1.629 41.38 | 2.065 52.45 | 1.665 42.29 | 750450-1* |
| 100 | 3.080 78.23 | 2.879 73.13 | 3.315 84.20 | 2.915 74.04 | 749611-9 |

*Part Number 750450-1 has 4-40 threaded holes. All others have 2-56 threaded holes.
Note: For termination, cover closing and wire lacing tooling, see page 14.
 For termination tooling other than wire lacing see pages 28,29.