

This document is the property of Amphenol Corporation and is intended for use only in connection with the products described herein. It is not to be used for any other purpose without the express written approval of Amphenol Corporation. The user assumes all liability for any damage or loss of data resulting from the use of this document.

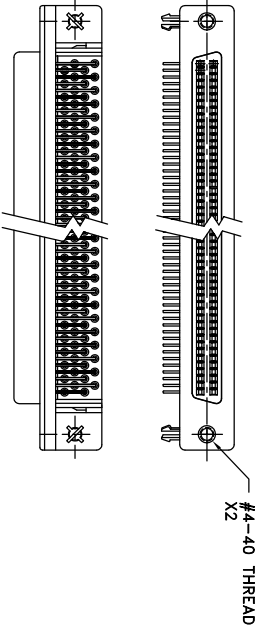

257-F100S-XX-92
SCALE: 1:2

REVISIONS			
REV	ENR	DESCRIPTION	DATE
A	HK2613	RELEASE TO PRODUCTION	07/16/03 Y.M. Lee

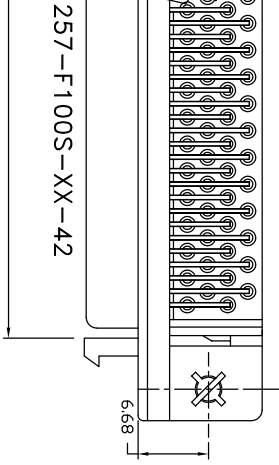
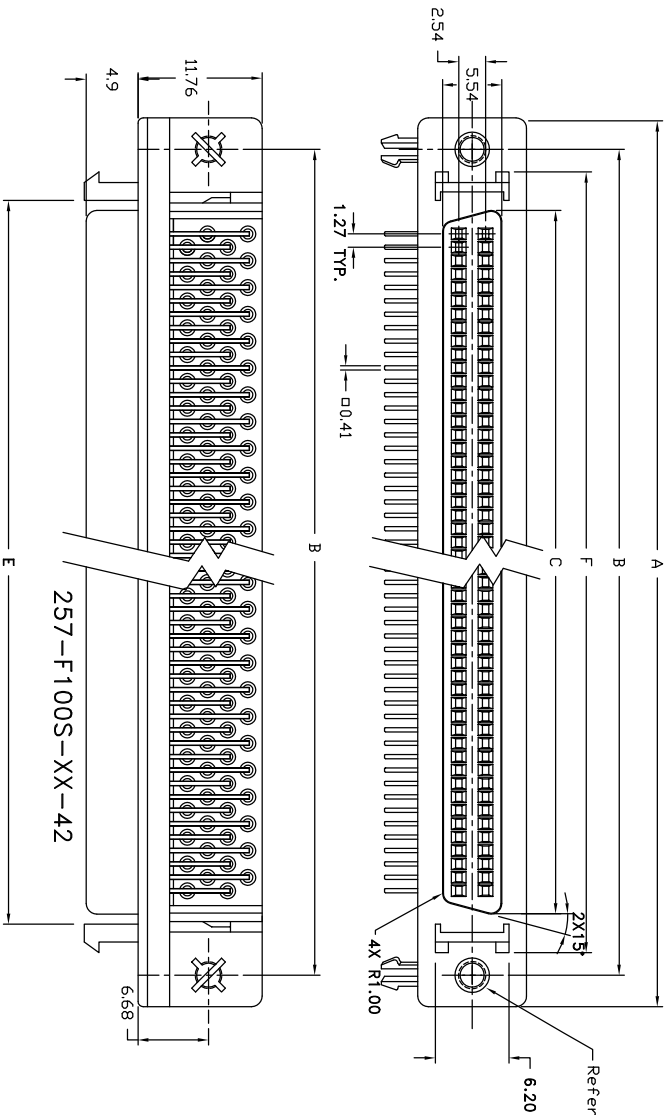
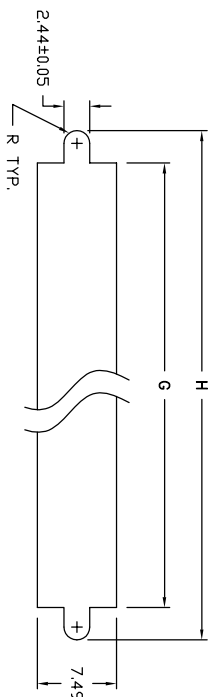
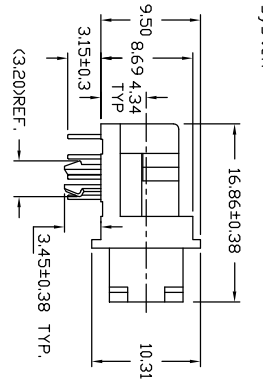

CUSTOMER INFORMATION DRAWING

Part Number	No. of Contacts	A	B	C	D	E	F	G	H	Layout Style
257-F050S-XX-XX	50	52.45	46.48	34.70	30.48	37.29	42.29	42.80	48.92	1
257-F068S-XX-XX	68	63.88	57.91	46.13	41.91	48.72	53.72	54.23	60.35	2
257-F100S-XX-XX	100	84.20	78.23	66.45	62.23	69.04	74.04	74.55	80.67	2

UNLESS OTHERWISE SPECIFIED		APPROVAL		DATE
TOLERANCES	U.S. METRIC	DRAWN	Y.M. LEE	07/16/03
X	+/-	CHECKED	Y.M. LEE	07/16/03
XX	+/-			
FRACTIONS	+/-			
ANGLES	+/-			
FOR MATERIALS AND FINISHES	SEE NOTES			
REMOVE SHARP EDGES				

DRAWING FILE:		ANGLE OF PROJECTION		TITLE
DRAWING	257\F100S\REV1.DWG	1ST ANGLE		257 SCSI-2 RIGHT ANGLE, SHIELD RECEPTACLE CONNECTOR WITH LOCATION PLATE

DIMENSIONS		SIZE		SCALE	SHEET	OF	REV.
INCHES	MM	A3	DRAWING NO.	NONE	1	OF	A
		A3	C257-FXXXX-XX-XX				

4 3 2 1

This document is the property of Amphenol Connector and is subject to the express condition that it is not to be altered, reproduced or used, in whole or in part, for manufacturing or sale by anyone other than Amphenol without the express written consent of Amphenol. Any use of this document or its contents without the express written consent of Amphenol is prohibited.

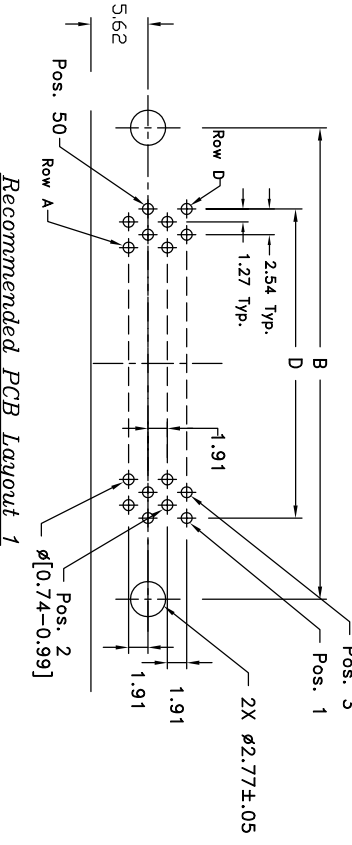
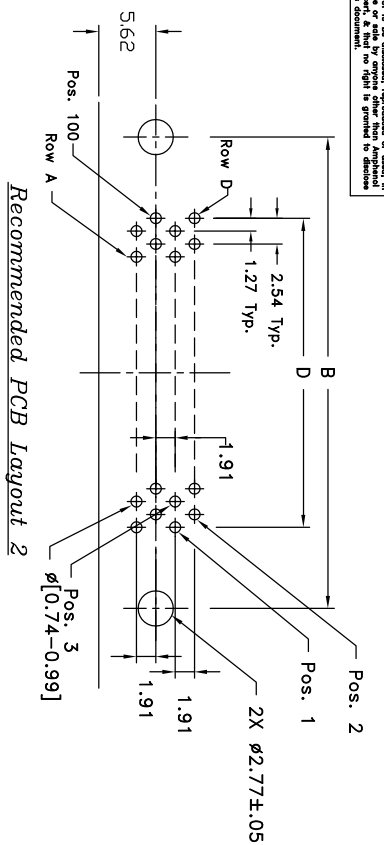

P/N System
 257-FXXXX-XX-XX
 Contact Type
 F - High temp. LCP material's body for board mount R/A 3.15mm tail
 No. of ways
 050 - 50 ways
 068 - 68 ways
 100 - 100 ways
 S - Socket (Female)
 P - Pin (Male)

Board Mounting Option (R/A bracket)
 2 - Boardlock
 3 - Clear hole
Panel Mount Option
 9 - #4-40 thr'd hole, w/o latch & rail
 6 - #2-56 thr'd hole, w/o latch & rail
 5 - #4-40 thr'd hole + latch block
 4 - #2-56 thr'd hole + latch block
Plating Option
 AA - Gold flash on mating area
 2.54-5.08µm Tin/Lead plated on termination area
 1.27-2.54µm Nickel underplated
 AF - 0.38µm Gold plated on mating area
 2.54-5.08µm Tin/Lead plated on termination area
 1.27-2.54µm Nickel underplated
 AM - 0.76µm Gold plated on mating area
 1.27-2.54µm Nickel underplated
 2.54-5.08µm Tin/Lead plated on termination area

Note:

- All dimensions are in mm.
- Materials

Contact : Phosphor Bronze,

AA - Gold flash on mating area
 2.54-5.08µm Tin/Lead plated on termination area
 1.27-2.54µm Nickel underplated

AF - 0.38µm Gold plated on mating area
 2.54-5.08µm Tin/Lead plated on termination area
 1.27-2.54µm Nickel underplated

AM - 0.76µm Gold plated on mating area
 2.54-5.08µm Tin/Lead plated on termination area
 1.27-2.54µm Nickel underplated

Shell : Cold Roll Steel,
 5.08-7.62µm Tin/Lead plated.
 Insulator : LCP, color black, UL94V-0 rated.
 Die Casting bracket : Zinc alloy
 1.27-3.81µm Nickel plated with copper underplated.

3. Mechanical Characteristics

Durability
 : 500 cycles min. for 0.76µm gold
 250 cycles min. for 0.38µm
 50 cycles min. for gold flash
Contact Retention Force with Insulator
 : 4.4 N min. per contact
Mating force
 : 1.22 N Max./contact (total 9.8 kgf approx.)
Umating force
 : 0.20 N Max./contact (total 5 kgf approx.)
The housing flatness
 : should be within 0.003 mm/mm
No. of insertion into PCB
 : once

4. Electrical Characteristics

Contact Rating
 : 1 A Max.
Contact Resistance
 : 25 mΩ Max.
Insulation Resistance
 : 1000 MΩ Min.at 500 VDC
Operation Temperature
 : -55°C to 105°C
Dielectric Strength
 : 500 VAC
 5. Suitable for PCB with a nominal thickness of 1.56 mm
 6. Material should be fulfilled Amphenol Spec.# S5N001.

CUSTOMER INFORMATION DRAWING

REVISONS				
SNW	ECN	DESCRIPTION	DATE	APPROVED
A	HK	SEE SHEET 1		Y.M.LEE

UNLESS OTHERWISE SPECIFIED		APPROVAL		DATE	
TOLERANCES	U.S.	DRAWN	Y.M.LEE	07/16/03	
	METRIC	CHECKED	Y.M.LEE	07/16/03	
* +/-	0.20	DRAWING FILE : D:\DRAWING\257\FXXXX\AM			
** +/-	0.13	TITLE : 257 SCSI-2 RIGHT ANGLE, SHIELD			
*** +/-	0.10	RECEPTACLE CONNECTOR WITH			
ANGLES +/-	3°	LOCATION PLATE			
FOR MATERIALS AND FINISHES					
REMOVE SHARP EDGES					
SEE NOTES					
DIMENSIONS		SIZE		DRAWING NO.	
U.S.	INCHES	A3	C257-FXXXX-XX-XX	REV. A	
(METRIC)	(MM)	SCALE	NONE	SHEET 2 OF 2	