

- NOTES:**
- MATERIALS:**
HOUSING- LCP, GLASS FILLED, UL94V-0, BLACK.
TERMINALS- COPPER ALLOY
 - FINISH:**
TERMINALS:
.000030/(0.00076) MINIMUM GOLD IN CONTACT AREA AND
.000050/(0.00127) MINIMUM TIN IN TAIL AREA OVER
.000075/(0.00191) MINIMUM NICKEL UNDERPLATING OVERALL.
 - ASSEMBLY MATES WITH MOLEX P/N SDA-71661-7***.
CONFORMS TO PRODUCT SPECIFICATION PS-71660.
- ⚠ SEE TABLE ON SHEET 2 FOR ADVANCED TERMINAL LIST
- ⚠ FOUR DIGIT DATE CODE (WK YR), EXAMPLE => 26 96 LOCATED IN AREA INDICATED.

NOTE FOR LEAD FREE CONVERSION:
THE PRIMARY SHIPPING CARTON WILL BE LABELED 'COMPLIANT TO ROHS DIRECTIVE 2002/95/EC AND ELV ANNEX II OF DIRECTIVE 2000/53/EC'. CARTONS WITHOUT THIS LABEL MAY CONTAIN PRODUCT WITH LEAD.

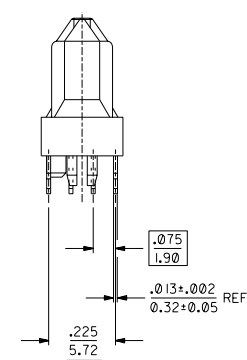
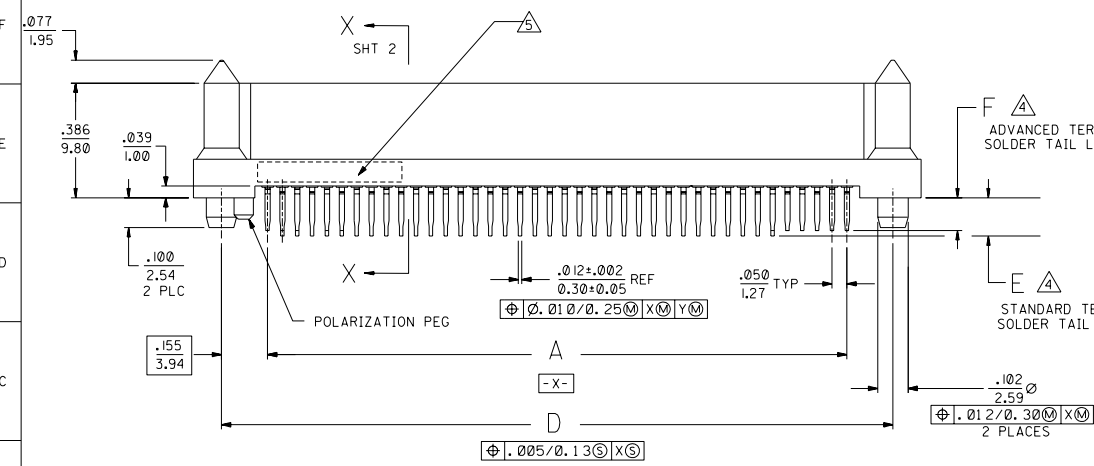

J	LEAD FREE CONV ECN UCP2004-2096 R/ADAMS 04/04/23
I	ADDED PART NO'S ECN L072002-1289 BBARKER 02/05/10
H	REVISED UDT2001-1091 BSMART 01/04/11
G1	REVISED ECN U01 2000-1006 ACHAMMER 00/06/05
G	REVISED PER ECN U71314 ACHAMMER 97/4/28
F	REVISED PER ECN U70090 ACHAMMER 96/7/26
E	REVISED PER ECN U6-0641 11-29-95 RAN
D	REVISED PER ECN U60564 11-8-95 RAN
C	REV. ADVANCED PIN PER ECN U51015 4-7-95 RAN
B	REV. ADVANCED PIN PER ECN U50727 1-2-95 RAN
A	INITIAL RELEASE PER ECN U50643 12-29-94 RAN

DIMENSIONS SHOWN (METRIC) INCH		REVISIONS	
UNLESS OTHERWISE SPECIFIED TOLERANCES ANGULAR ± 1/2°		2	I
INCH METRIC		1	J
3 PLACE ± .005	---	REVISE ONLY ON CAD SYSTEM	
2 PLACE ± .013	± 0.13	SALES ASSY, EBBI 50D, VERTICAL, BLIND MATE RCPT W/ ADVANCED TERMINALS	
1 PLACE ± .013	± 0.13	MOLEX INCORPORATED SHEET NO. DATE	
DRAFT WHERE APPLICABLE MUST REMAIN WITHIN DIMENSIONS		U.S.A. 1 OF 2 12 / 6 / 94	
DRG. BY: RAN	CHKD. BY: RAN	PART NO. DRG. NO.	
APP'D. CAB	SCALE: 4:1	SEE TABLE SDA-71660-75**	
FILE NAME: S7166075		NO DRAWING CONTAINS INFORMATION THAT IS PROPRIETARY TO MOLEX INC. AND SHOULD NOT BE USED WITHOUT WRITTEN PERMISSION.	
DRG. NO. 69532		DIV. 1532	

ITEM NUMBER	CIRCUIT SIZE ('N')	A	B	C	D	E ±.010 (±0.25)	F ±.010 (±0.25)	ADVANCED CIRCUITS
71660-7501	68	1.650 (41.91)	1.765 (44.83)	2.149 (54.58)	1.960 (49.78)	.134 (3.40)	.116 (2.95)	5, 6, 39, 64, 66, 68
71660-7504	40	.950 (24.13)	1.065 (27.05)	1.449 (36.80)	1.260 (32.00)	.128 (3.25)	.110 (2.79)	1, 2, 3, 18, 19, 20
71660-7505	50	1.200 (30.48)	1.315 (33.40)	1.699 (43.15)	1.510 (38.35)	.128 (3.25)	.110 (2.79)	1, 2, 3, 23, 24, 25
71660-7508	80	1.950 (49.53)	2.065 (52.45)	2.449 (62.20)	2.260 (57.40)	.128 (3.25)	.110 (2.79)	1, 36-43, 45, 46, 75-80

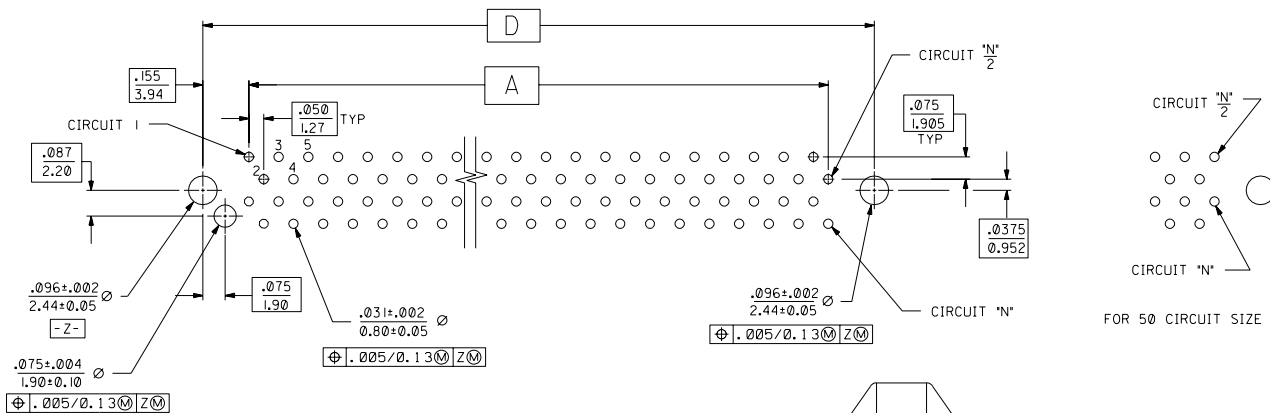

RECOMMENDED PC BOARD LAYOUT
COMPONENT SIDE
FOR 40, 68 AND 80 CIRCUIT SIZES

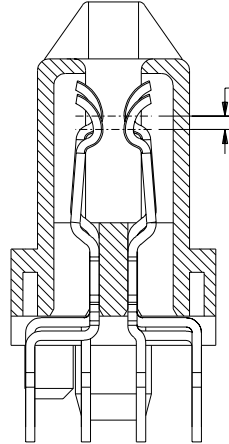

.015 MINIMUM OFFSET BETWEEN
STANDARD AND ADVANCED TERMINALS

I	ADD PART NO'S ECN UDT2002-1289 BBARKER 02/05/10
H	DELETE 50 CKT UDT2001-1091 BSMART 01/04/11
G1	SEE SHEET 1

DIMENSIONS SHOWN (METRIC) INCH		REVISIONS	
UNLESS OTHERWISE SPECIFIED TOLERANCES ANGULAR ± 1/2°		MFG. SH.	REV. LTR.
TITLE SALES ASSY, EBBI 50D, VERTICAL, BLIND MATE RCPT W/ ADVANCED TERMINALS		REVISE ONLY ON CAD SYSTEM	
MOLEX INCORPORATED		SHEET NO.	DATE
SEE SHEET 1		2	12 / 6 / 94
DRG. NO.	SDA-71660-75	DRG. NO.	
DRG. BY	RAN	DRG. BY	RAN
CHK'D. BY	RAN	CHK'D. BY	RAN
APP'D. BY	CAB	APP'D. BY	CAB
SCALE	4:1	SCALE	4:1
FILE NAME	57166075	FILE NAME	57166075
SIZE	3/8	SIZE	3/8
NO DIMENSIONS CONTAINING INFORMATION THAT IS PROPRIETARY TO MOLEX INC. AND SHOULD NOT BE USED WITHOUT WRITTEN PERMISSION.			