

ADAPTERS, IN-SERIES

SMA, DC - 26.5 GHz

SPECIFICATIONS:

Models: 5163, 5164, 5165

RoHS
Compliant

Electrical:

Frequency Range _____ DC - 26.5 GHz
VSWR _____ 1.20:1 Max.
Impedance _____ 50 Ohms
Operating Temp Range _____ -65°C to +125°C

Mechanical:

Connectors _____ Passivated Stainless Steel
Mates with MILSTD-348
Conductors _____ Gold Plated Beryllium Copper

AEROFLEX
A passion for performance.

Model Number: **5163**
Female/Female Connectors

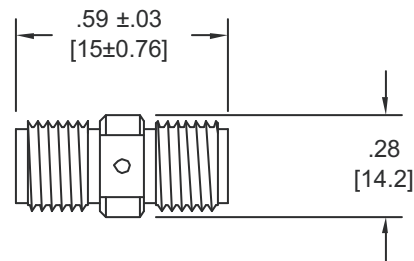

Model Number: **5164**
Male/Male Connectors

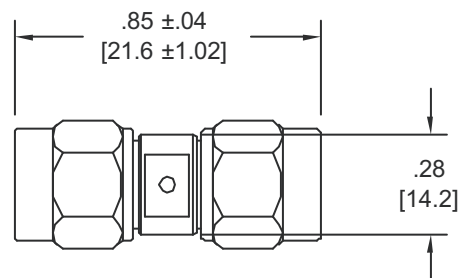

Model Number: **5165**
Male/Female Connectors

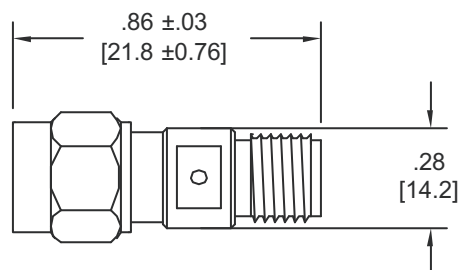

Note: Dimensions in Brackets are Expressed in Millimeters and are for Reference Only.

5163: REV A

AEROFLEX
INMET

Aeroflex / Inmet, Inc. • 300 Dino Drive, Ann Arbor, MI 48103 • U.S.A.
888-244-6638 or 734-426-5553 • FAX: 734-426-5557
www.aeroflex.com/inmet • inmet@aeroflex.com